

POLARIS RANGER REAR BUMPER

PART # 100542

Kit Components:

<u>Qty</u>	<u>Part Description</u>
1.....	Rear Bumper
4.....	Tube Caps
4.....	3/8" x 1.00" Carriage Bolt
4.....	3/8" Flat Washer
4.....	3/8" Nylock Nut
2.....	1/4" x 3/4" Self Tapping Bolt
2.....	1/4" Lock Washer
2.....	1/4" Flat Washer

INSTALLATION INSTRUCTIONS:

1. Begin by assembling the tube caps to the bumper as shown in the exploded view. This can also be done after the bumper is installed.
2. Place the bumper into location as shown in Figure 1 and 2 and assemble the 3/8" and 1/4" hardware.

Note: The bumper brackets will go over the top of the brackets on you box frame as shown.



Figure 1



Figure 2

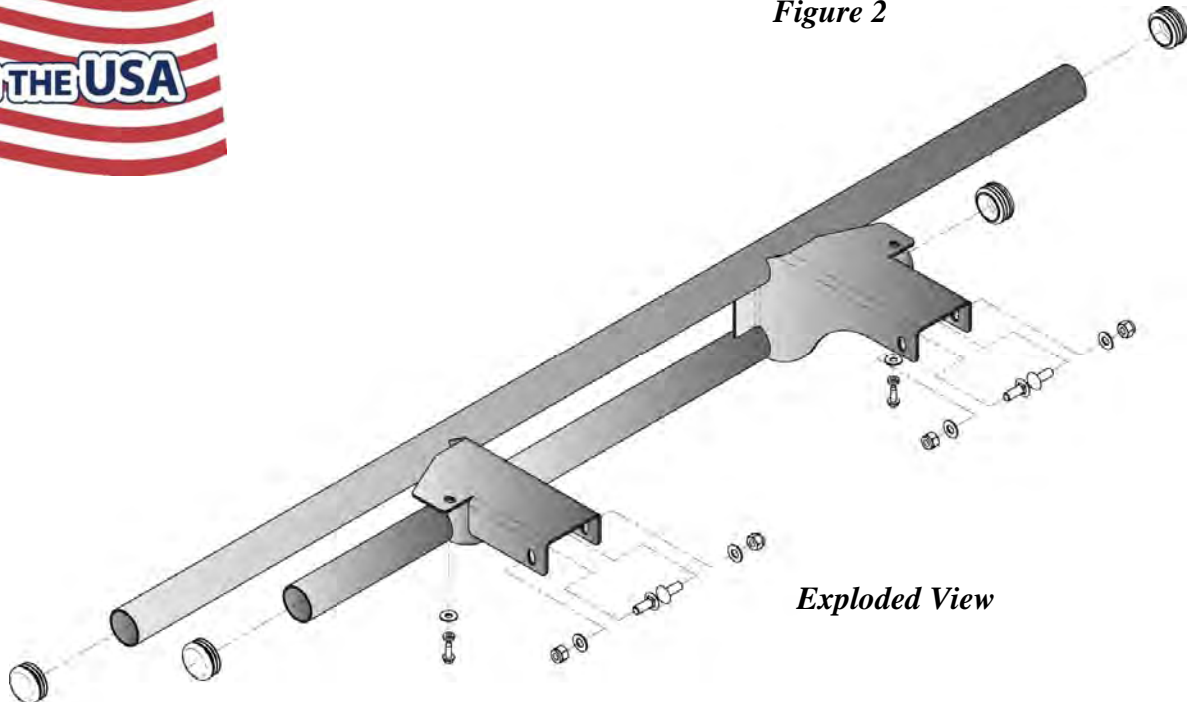

Exploded View