

# 2009-2014 Polaris RANGER

## Wide Winch Mount

Part #: **100764**  
 Hardware Kit: **HK-038, HK-031**

Contents:

1x 100764 Wide Winch Mount Plate

Hardware Kit:

2x 5/16"-18 x 1" Hex Flange Bolt  
 2x 5/16"-18 Hex Nylock Nut  
 2x 5/16" SAE Flat Washer  
 3x 3/8"-16 x 1" Short-neck Carriage Bolt  
 3x 3/8"-16 Hex Nylock Nut  
 3x 3/8" SAE Flat Washer  
 4x #8-16 Pan Head Screw Self-Tapping Screw  
 1x 22-18GA Spade Insulated Terminal  
 1x HK-031 (UTV Mini-Rocker Hardware)

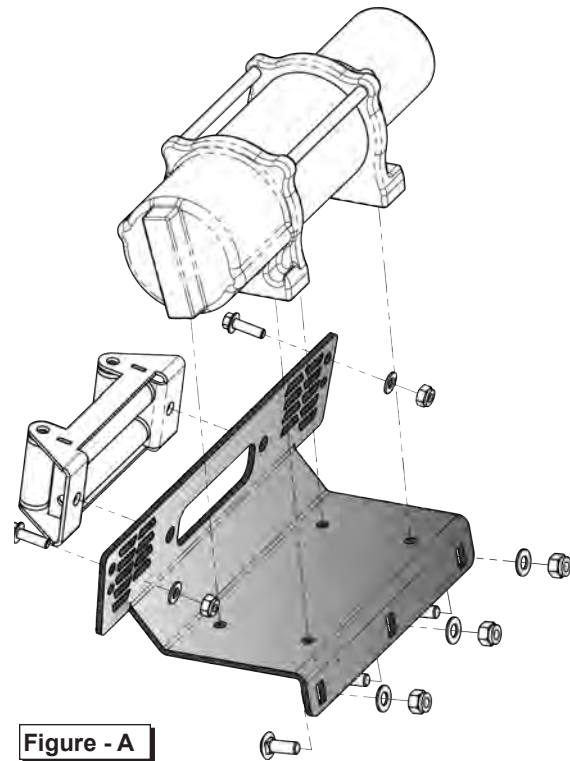

**Figure - A**

### INSTALLATION INSTRUCTIONS:

#### PREPARE MACHINE

1. Begin by turning the vehicle off and disconnecting battery cables. Locate the battery compartment, usually under the hood; or for the 2014 RANGER 800 4x4 under the driver seat, or 2014 RANGER 800 CREW under the rear driver-side seat. First remove the ground, then positive terminal.

#### CONTACTOR

2. Find the location on the passenger side under the hood compartment marked "Winch Contactor" (**Figure 1**). Fasten contactor block using (4X) #8 Self Tapping Screws included with hardware kit.

*Note: This location is set up for a standard contactor and some may not work with this bolt pattern but can be mounted in the general area.*

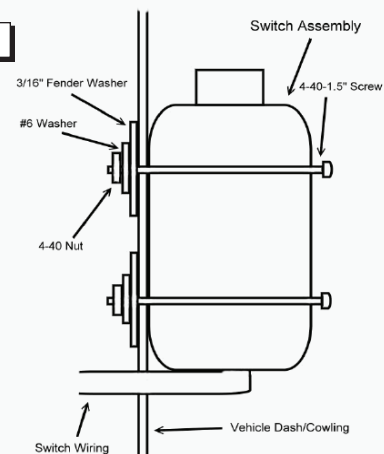

**Figure - 1**

#### SWITCH

3. Use included Mini-Rocker Switch Hardware Kit (HK-031) to fasten a handle bar mounted mini-rocker switch to the dash or any desired location.
  - a. Remove handlebar mount hardware from the switch.
  - b. Locate desired mounting location.
  - c. Mark & drill 2 switch holes thru dash using switch housing as a template.
  - d. Drill a 3rd hole for switch wiring.
  - e. Assemble per **Figure 2**.

**Figure - 2**



#### Optional Switch Mount Instructions\*

## REMOVE BUMPER

- Begin by removing the 4 Torx screws at locations (A) & (B) from the front and upper grills on the bumper frame as shown in **Figure 3**. Retain the upper grill (A). Discard or set aside the front grill (B). Then remove the three bolts (C) at the bottom of the frame (see **Figure 3**).

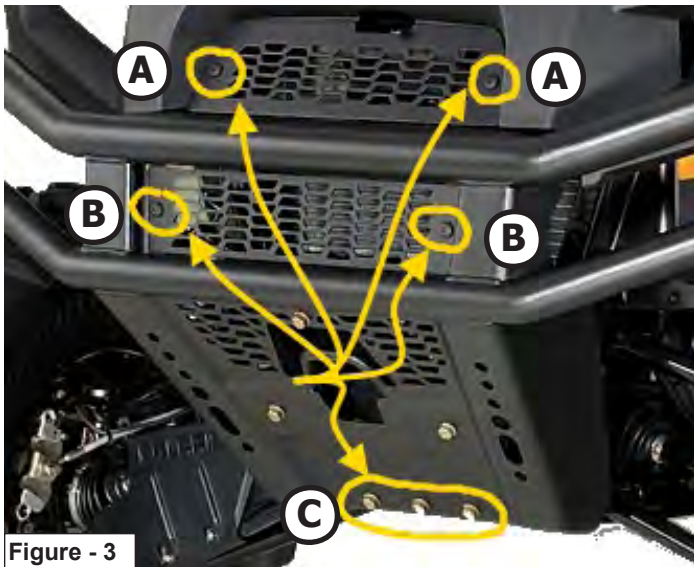

- Remove 2 bolts (D) from the driver & passenger side of the bumper as shown in **Figure 4**. Next remove the entire bumper from the machine.

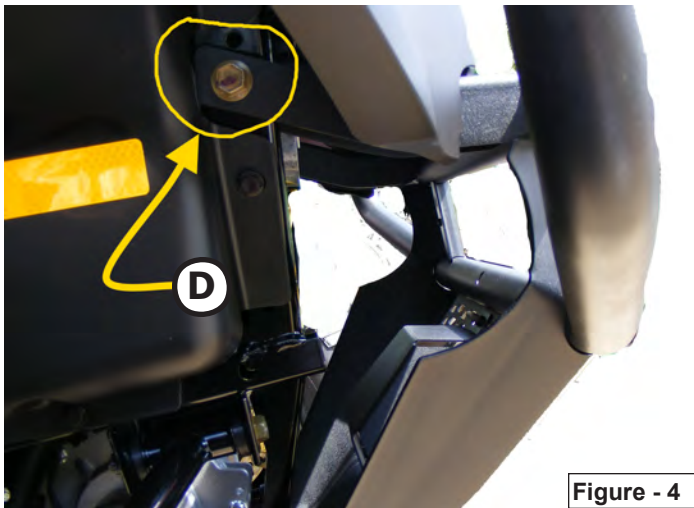

## ASSEMBLE WINCH MOUNT TO BUMPER

- Attach your roller/hawse fairlead to the winch mount as shown in **Figure A**; fasten using hardware supplied with your winch.
- Place the winch mount into location on the bumper as shown in **Figure 5** by passing the winch mount through the front grill pocket and fasten using supplied 5/16" hardware and the 2 Torx screws (B) removed previously.

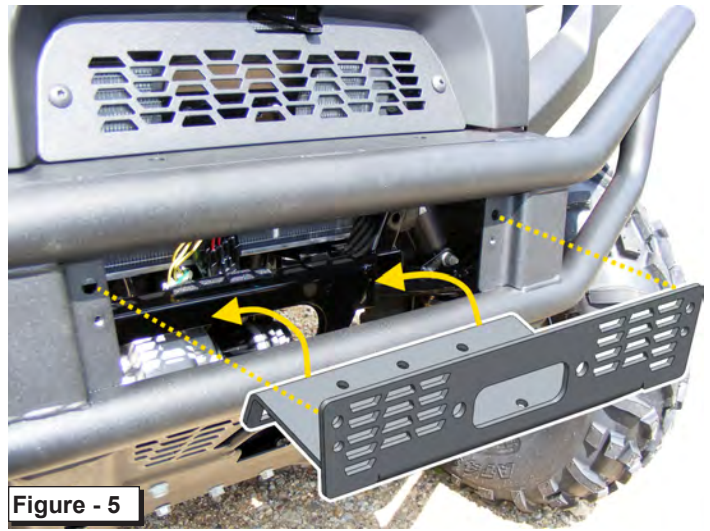

## ASSEMBLE WINCH TO MOUNT

- IF YOU HAVE A 2014 RANGER 800 4X4/CREW ONLY:  
Connect the shortest wires (usually RED & BLACK) to the motor end of the winch per the ALTERNATE WIRING DIAGRAM shown in **Figure 11** (pg 4). Connect BLACK wire to NEG(-) BLUE winch post; connect RED wire to POS(+) YELLOW winch post.
- For all other supported RANGER models:  
Connect the longest wires (usually BLUE & YELLOW) to the motor end of the winch per your Winch's Instruction manual.
- Assemble your winch to the mount plate as shown in **Figure A**, using the hardware supplied with your winch (pg1). Also, feed a short length of cable through the fairlead and attach the cable hook.

## REASSEMBLE FRAME

- Reassemble the bumper to the frame by loosely re-fastening the hardware (C & D) removed in Steps 4 & 5.
- Attach the back of the winch mount to the three holes (E) in the frame using the supplied 3/8" carriage bolts (see **Figure 6**). Only the two outer most bolts are required.

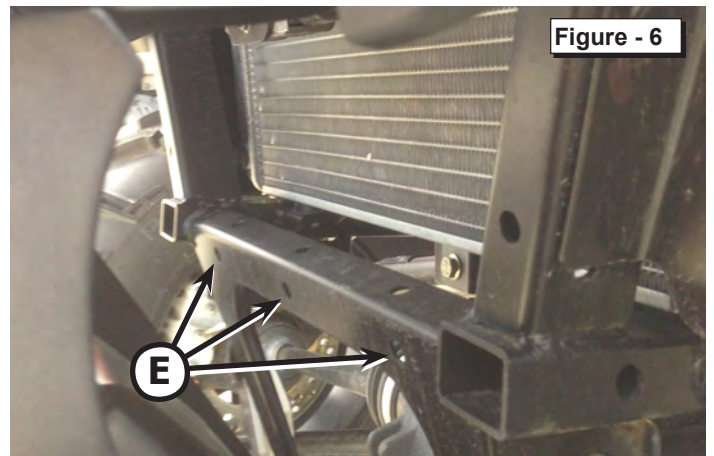



## WIRING INSTRUCTIONS

- Route winch wires to the hood compartment, passing through an outlet (F) shown in **Figure 7**. DO NOT connect wires to contactor at this time.

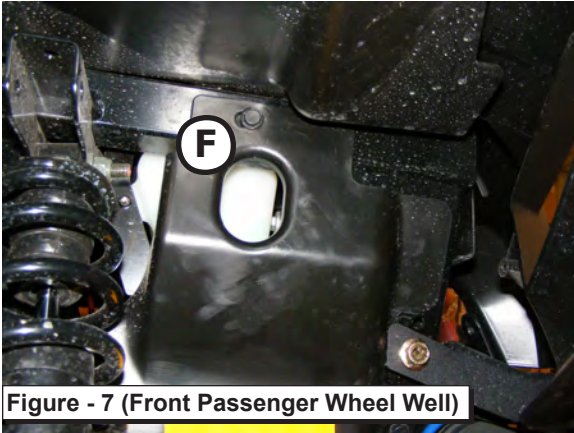

- Replace the upper grill removed in Step 4.
- Wire the red ignition wires for a mini-rocker switch or other controller to the terminal with the Orange and White wires under the hood as shown in **Figure 8** using the supplied 22-18GA Spade Insulated Terminal.



- If you have a 2014 RANGER 800 4X4/CREW, go to Step 19, otherwise proceed to Step 18.
- Connect winch, battery, and remaining switch wiring to your contactor per your winch's instruction manual.

## FOR 2014 RANGER 800's ONLY:

- 2014 RANGER 800 CREW model will require the extended 11" cables included with the Crew Kit (KFI#: UTV-WEK, sold separately).
- Locate starter solenoid next to battery as shown in **Figure 9**. Using the ALTERNATE WIRING DIAGRAM (**Figure 11**, pg 4) as a guide, attach the YELLOW POS(+) wire to the battery fed solenoid as shown in **Figure 10**. Then, attach the BLUE NEG(-) wire to the ground post as shown in **Figure 10**.

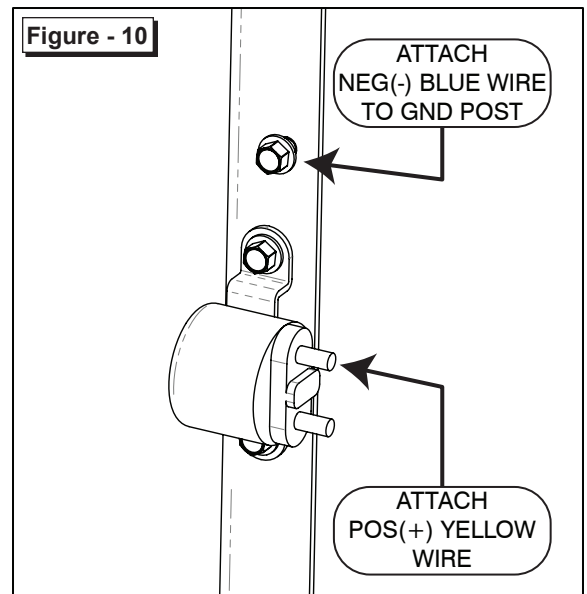

- Route the longest wires (usually BLUE & YELLOW) included with your winch from the solenoid to the contactor location. Connect wires to contactor according to **ALTERNATE WINCH WIRING DIAGRAM** shown in **Figure 11**, - NOT according to the color coding.
- Secure all wires and reconnect battery positive & ground cable.

Note: Battery shown in this diagram represents a *battery fed source*. Depending on your vehicle configuration, power leads may attach to a primary/secondary battery or starter solenoid. Follow all vehicle specific installation instructions.

Figure - 11

# ALTERNATE WINCH WIRING DIAGRAM

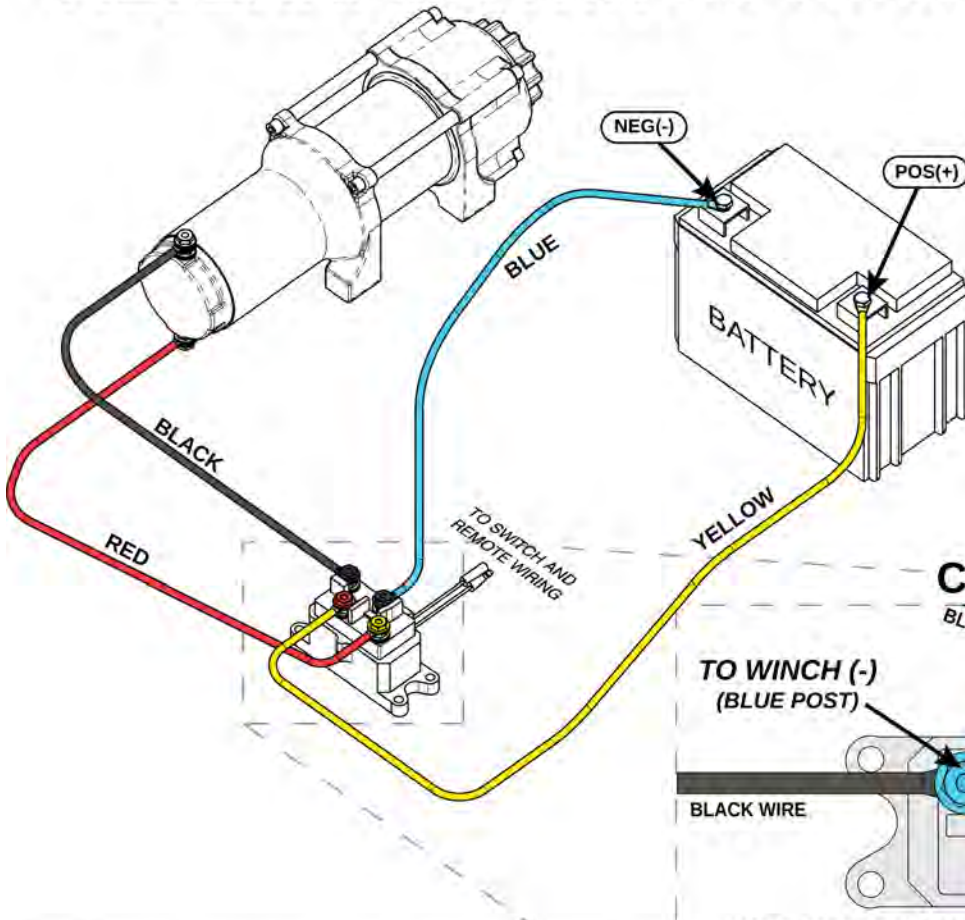

\* For use with ATV/UTV applications where contactor cannot be located close to vehicle battery.

\* Run shortest wires, usually red & black from contactor to winch; run longest wires, usually blue & yellow from contactor to battery.

**CAUTION**  
These two posts must be wired to the battery!

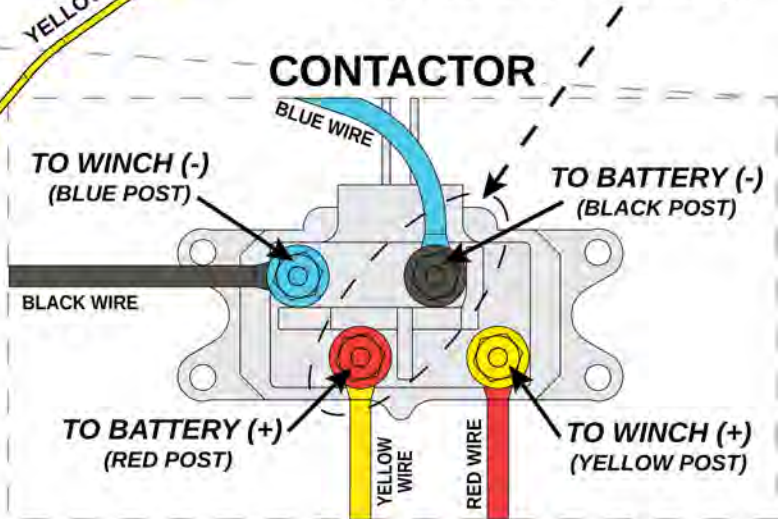

**CAUTION**  
FAILURE TO FOLLOW WIRING DIRECTIONS AS SHOWN MAY RESULT IN DAMAGE TO YOUR WIRING SYSTEM OR EQUIPMENT.

- WIRE WINCH NEGATIVE (BLACK WIRE) TO --> BLUE CONTACTOR POST
- WIRE WINCH POSITIVE (RED WIRE) TO --> YELLOW CONTACTOR POST
- WIRE BATTERY NEGATIVE (BLUE WIRE) TO --> BLACK CONTACTOR POST
- WIRE BATTERY POSITIVE (YELLOW WIRE) TO --> RED CONTACTOR POST

