

# **Polaris Mid-Size Ranger 400/500/ EV/Crew**

## **Winch Mount**

**PART # 100820/100824**

HARDWARE: HK-056, HK-031

### **Kit Components:**

<u>Qty</u>	<u>Part Description</u>
1.....	Winch Mount & Grill
6.....	3/8" x 1" HF Bolt
6.....	3/8" SAE Flat Washers
8.....	3/8" Nylock Nuts
2.....	5/16 x 1" Hex Head Flange Bolts
2.....	5/16" SAE Flat Washers
2.....	5/16" Nylock Nuts
2.....	3/8" x 1-1/4" SN Carriage Bolt
1.....	Spade Insulated terminal
1.....	Hardware Kit (Mini-Rocker Switch)

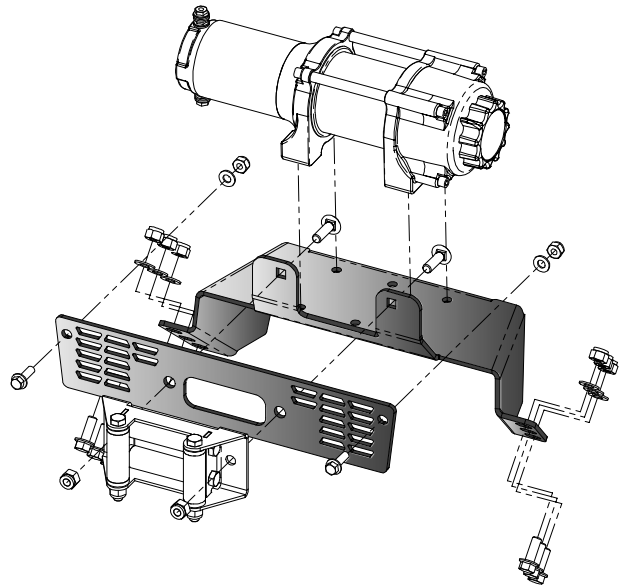

### **INSTALLATION INSTRUCTIONS:**

1. Begin by removing the grill and the three bolts on the bottom as shown in Figure 1.
2. Remove the two bolts shown in Figure 2 and remove the entire bumper from the machine.
3. Assemble your winch to the mount plate using the hardware supplied with your winch.
4. Place the winch and mount assembly into location on the bumper and attach using the supplied 3/8" hardware as shown in Figure 3. Do not tighten.  
(winch not shown in picture)
5. Connect the shorter winch wires to the winch leads. (usually Black and Red)
6. Re-assemble the bumper to your machine.

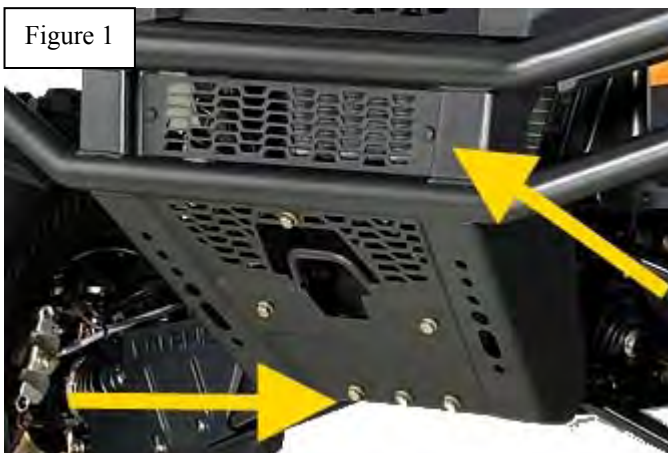
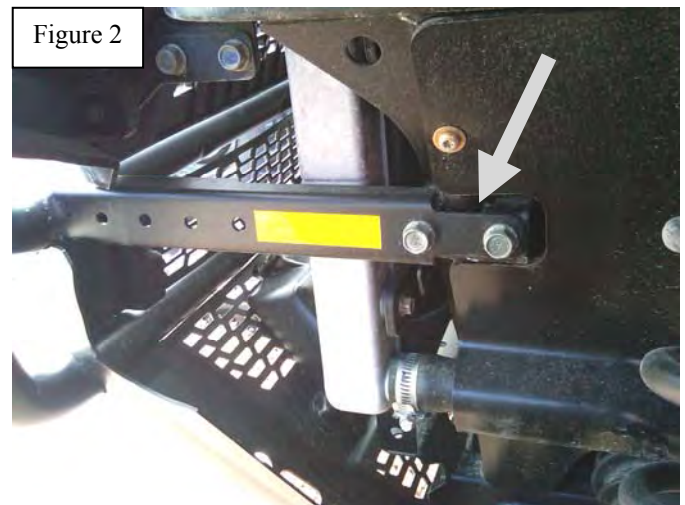

7. Assemble the new steel replacement grill using the supplied 5/16" Hardware on the ends while feeding your winch cable through the fairlead opening. Do not tighten.

8. Assemble your roller fairlead by running the supplied carriage bolts through the mount, replacement grill and then the fairlead.
9. Tighten all Bolts
10. Using the instructions provided with your winch, wire accordingly. Use the longer winch wires to go from the contactor to the battery. (usually Yellow and Blue)
11. The winch contactor location is shown in Figure 4. This location is just under the hood if you were looking at the front of the machine. Please use the hardware that was supplied with your winch to secure your contactor. *(Note: this location is set up for the standard contactor and some contactors may not work with this bolt pattern but can be mounted in the general area. On the Ranger 500 Crew the contactor will need to be mounted in a central location on the machine.)*
12. Wire the red ignition wires for the controllers to the terminal with the Orange and White wires under the hood as shown in Figure 4 using the supplied connector.

### Optional Switch Mount Instructions

1. Mini-Rocker Switch Hardware kit. This allows you to mount your usual handle bar mounted switch to almost any desired location.
  - a. Remove handlebar mount hardware from the switch.
  - b. Locate desired mounting location
  - c. Mark and drill two switch holes through dash using switch housing as a template
  - d. Drill a 3<sup>rd</sup> hole for the switch wiring.
  - e. Assemble per Figure 5

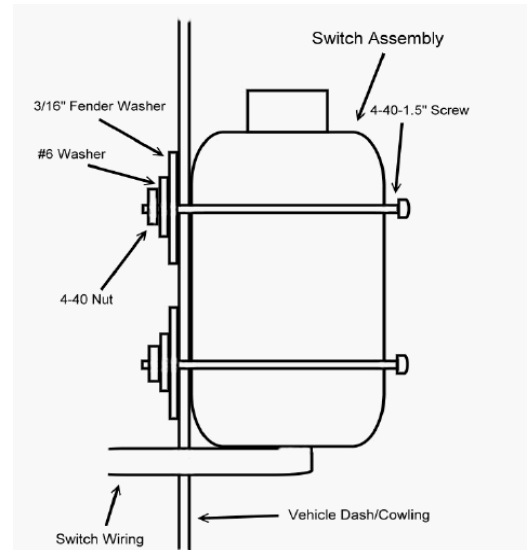

**Optional Switch Mount Instructions\***

*"Figure 5" Mini-Rocker Mounting*

Figure 4

