

JCB WORKMAX

2" Rear Receiver PART # 100955
Hardware Kit: HK-096

Kit Components:

Qty.	Part Description
1.....	Receiver Plate
4.....	5/8"-11 X 1 1/4" Hex Bolt
4.....	5/8"-11 Flanged Nylock Nut

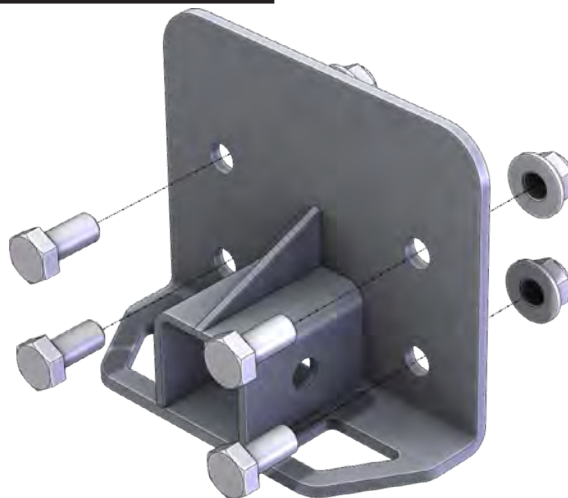

"Figure 1"

INSTALLATION INSTRUCTIONS:

1. Remove any stock mount if there is one.
2. Place mount plate over rear plate on machine and line up with holes (A) as shown in Figure 2.

Note: Install is much easier if you insert a receiver through the mount and into the machine. This will allow it to hold the mount in place during install and center the hole.

3. Install receiver plate using the 4 bolts and nuts (B) provided in the hardware kit.
4. Tighten down all bolts.

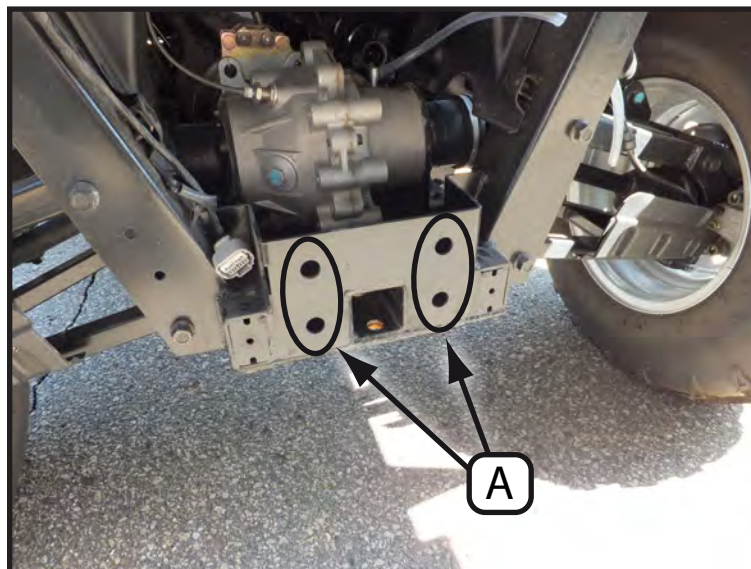

"Figure 2" Back of UTV

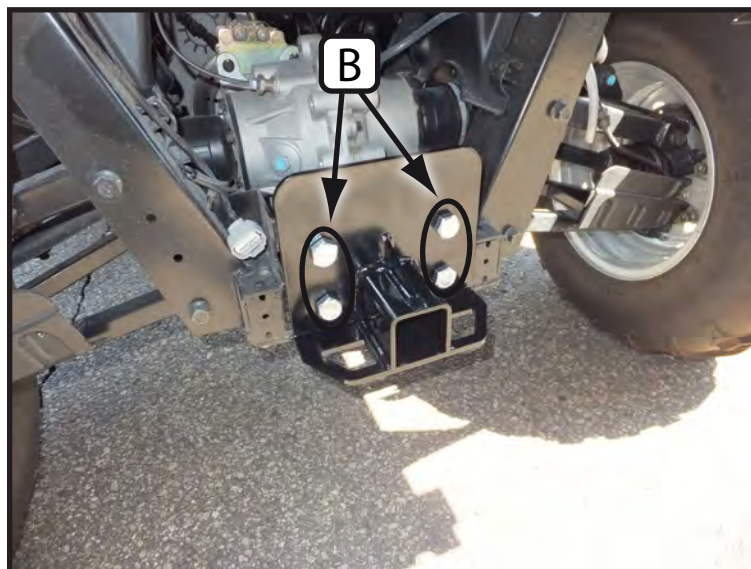

"Figure 3" Receiver Plate Install

