

YAMAHA VIKING WINCH MOUNT

Verify style of winch you will be installing, 4 hole standard (3.0 x 4.875") will fit without any modification. Two hole style (3.10" apart) and Wide 4 hole (3 x 6.60") will require modification to front bumper. See Page 7 for reference.

Winch Mount PART # 101075
Hardware Kit: HK-031, HK-042

Kit Components:

Qty.	Part Description
1.....	Winch Mount Plate
4.....	3/8"-16 x 1-1/4" Hex Flange Bolt
8.....	7/16" SAE Flat Washer
4.....	3/8"-16 Hex Flanged Nylok Nut

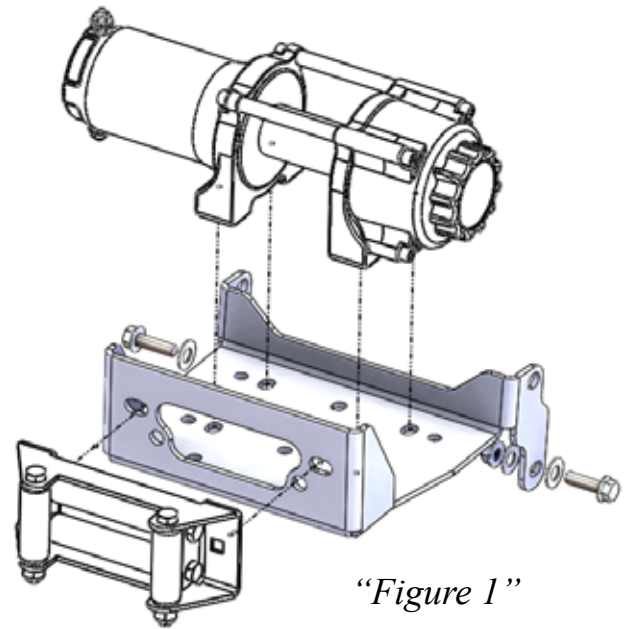

“Figure 1”

INSTALLATION INSTRUCTIONS: VIKING ONLY

For Wolverine Mount Installation SEE page 4

1. Remove the 4 bolts (A) holding the lower plastic shroud to the bumper as shown in “Figure 2”.
2. Slide the winch mount in between the front bumper and into place shown in “Figure 3”.
3. Place the two 3/8" hex bolts into location (B) as shown in “Figure 4”.

Note: If you are installing a KFI 2" front receiver along with your KFI winch mount, you will need to leave the rear bolts out, bolt location “Figure 4”(B), as this location is also used in mounting your KFI 2" receiver.

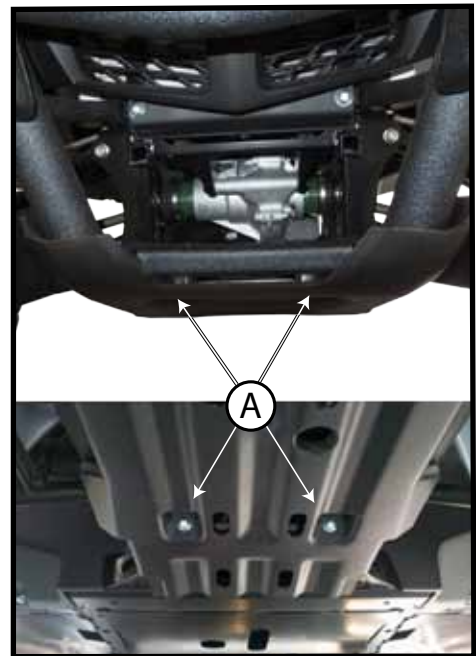

“Figure 2” Plastic Shroud Removal



“Figure 3” Mount Location

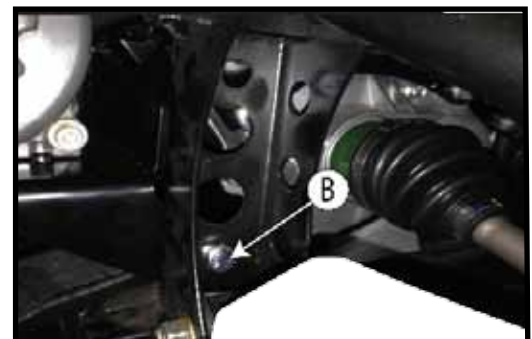

“Figure 4” Bolt Location
Drivers Side Front

VIKING WINCH MOUNT INSTALL (CONTINUED)

4. Place your winch on the mount. Using hardware provided with your winch, secure the winch to the mounting plate as shown in “Figure 5”.

NOTE: Front 2 hex bolts from your winch hardware kit, go through OEM bumper holes, winch mount and into winch. Hole reference shown in “Figure 6” (F) and “Figure 7”.

5. Place roller fairlead onto mount after feeding winch cable through. Mount roller fairlead to mount using hardware supplied with winch.

6. Using the instructions provided with your winch, wire accordingly.

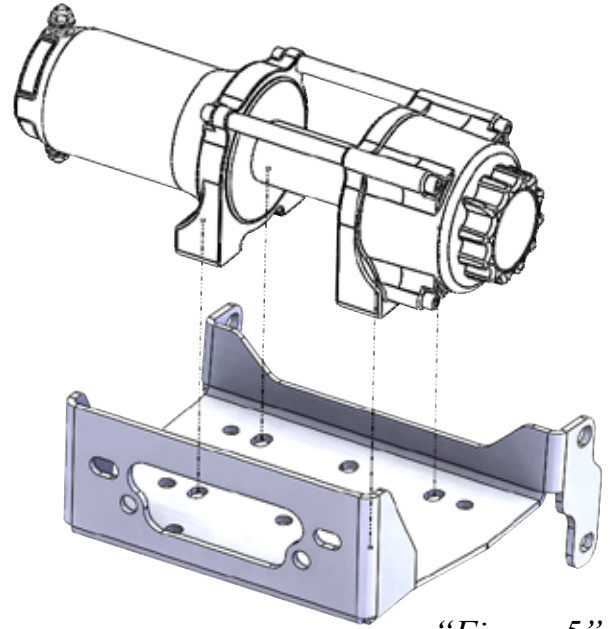

“Figure 5”

STD 4 HOLE WINCH LOCATION

Standard 4 hole winches measure approximately 3”x 4.875”

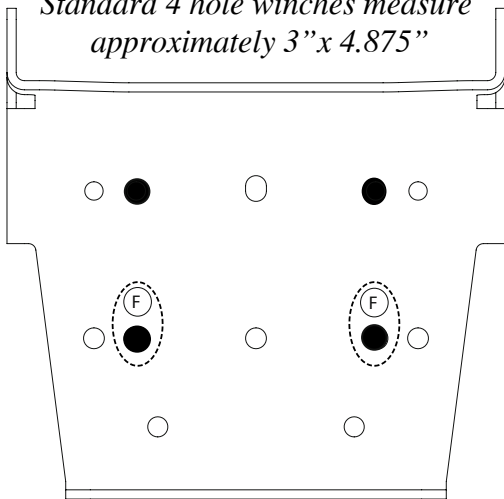

“Figure 6”

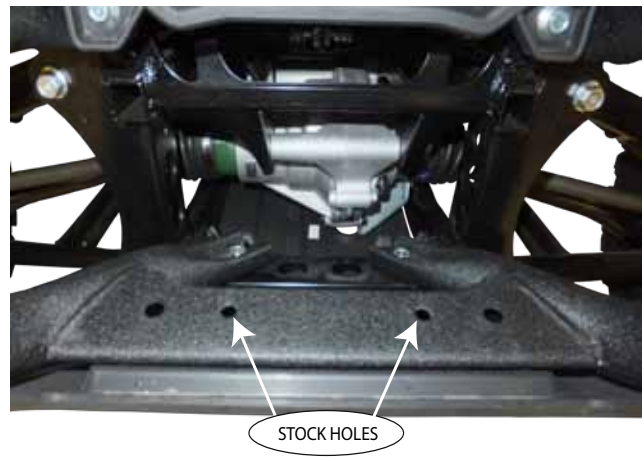

“Figure 7” OEM Bumper Bracket



VIKING WIRING INFORMATION

1. Suggested contactor location please see “Figure 8”. *The suggested location is under the driver side of the machine. Drill small holes in the plastic to mount contactor. Check for wires under the plastic before drilling through plastic.*
2. Find a location that suits your purposes for the mini-rocker switch and hand remote.

Mini-Rocker Switch Hardware kit. This allows you to mount your usual handle bar mounted switch to almost any desired location.

- a. Remove handlebar mount hardware from the switch.
 - b. Locate desired mounting location
 - c. Mark and drill two switch holes through dash using switch housing as a template
 - d. Drill a 3rd hole for the switch wiring.
 - e. Assemble per “Figure 10”.
3. Wire the red ignition wire from the controller to the POSITIVE (+) wire on the accessory plug as shown in “Figure 11”. (G location) using the supplied connector. Follow wires coming from accessory plug (under wheel well on passenger side) to connector. Take connector apart and splice red wire from mini-rocker switch and hand remote into wire, using electrical crimps or solder wires together.
 4. Reconnect accessory plug to other side of electrical connection “Figure 11”.



“Figure 8” Contactor Location



“Figure 9” Battery Location

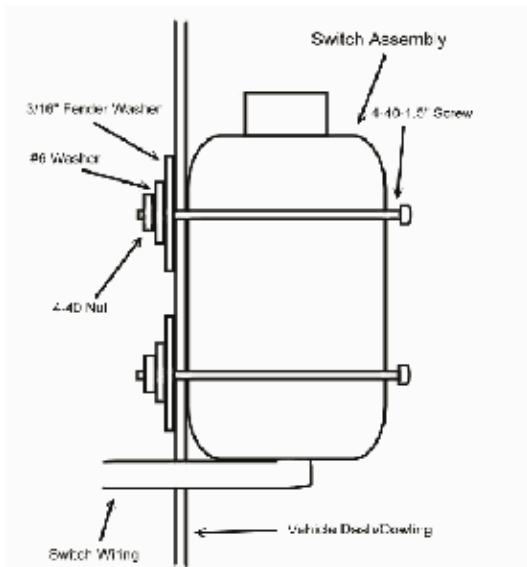

Optional Switch Mount Instructions*

“Figure 10” Mini-Rocker Mounting

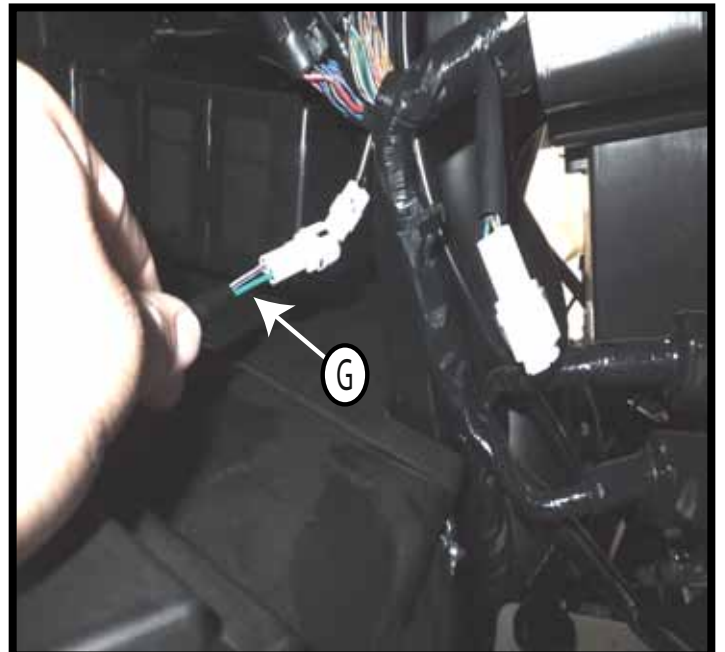

“Figure 11” Wire Location Under Passenger Side Fender

YAMAHA WOLVERINE WINCH MOUNT

Verify style of winch you will be installing, 4 hole standard (3.0 x 4.875") will fit without any modification. Two hole style (3.10" apart) and Wide 4 hole (3 x 6.60") will require modification to front bumper. See Page 8 for reference.

Winch Mount PART # 101075
Hardware Kit: HK-031, HK-042

Kit Components:

Qty.	Part Description
1.....	Winch Mount Plate
4.....	3/8"-16 x 1-1/4" Hex Flange Bolt
8.....	7/16" SAE Flat Washer
4.....	3/8"-16 Hex Flanged Nylok Nut

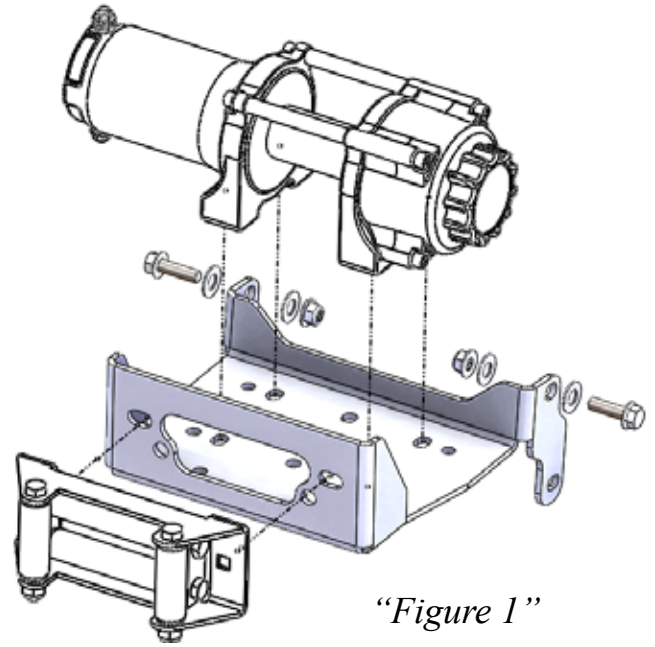

“Figure 1”

INSTALLATION INSTRUCTIONS: WOLVERINE ONLY

1. Remove the 6 bolts (A) holding the lower plastic shroud to the bumper as shown in “Figure 2”.
2. Slide the winch mount in between the front bumper and into place shown in “Figure 3”.
3. Place the two 3/8” hex bolts into location (B) as shown in “Figure 4”. Do not tighten at this time

NOTE: Check to see if your winch can be placed into position without removing the bumper. If it can, skip to Step 4. If it cannot, you will need to remove the front bumper. Please continue to step 4 on page 5.

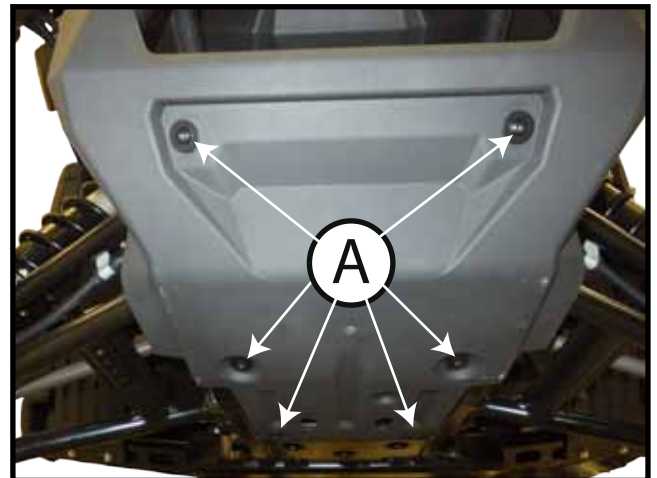

“Figure 2” Plastic Shroud Removal



“Figure 3” Mount Location

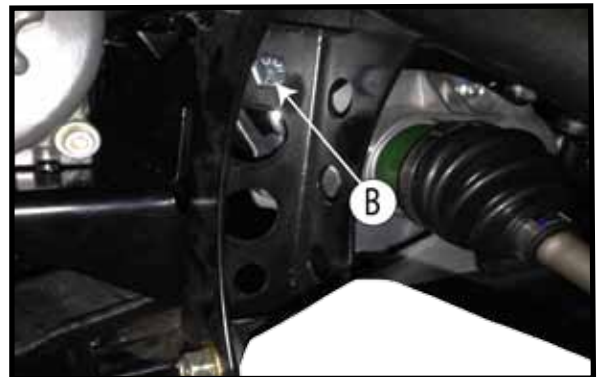

“Figure 4” Bolt Location
Drivers Side Front

WOLVERINE BUMPER REMOVAL

4. Remove the 6 bolts (C) that hold the front bumper to frame as shown in Figure 7 (C). Once bumper is removed shown in "Figure 6", continue the installation of your winch/ winch mount.

"NOTE" The front 2 hex bolts from your winch hardware kit, go through the OEM bumper holes, winch mount and into winch shown in "Figure 5".

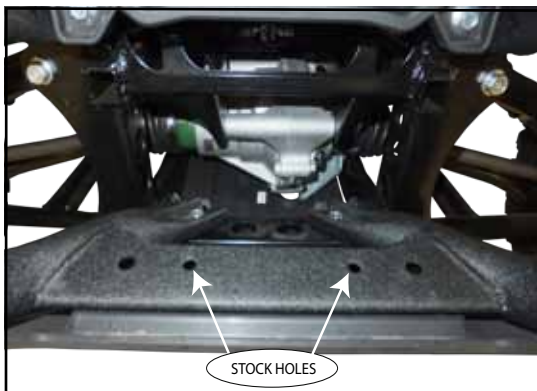

"Figure 5"
OEM Bumper Bracket

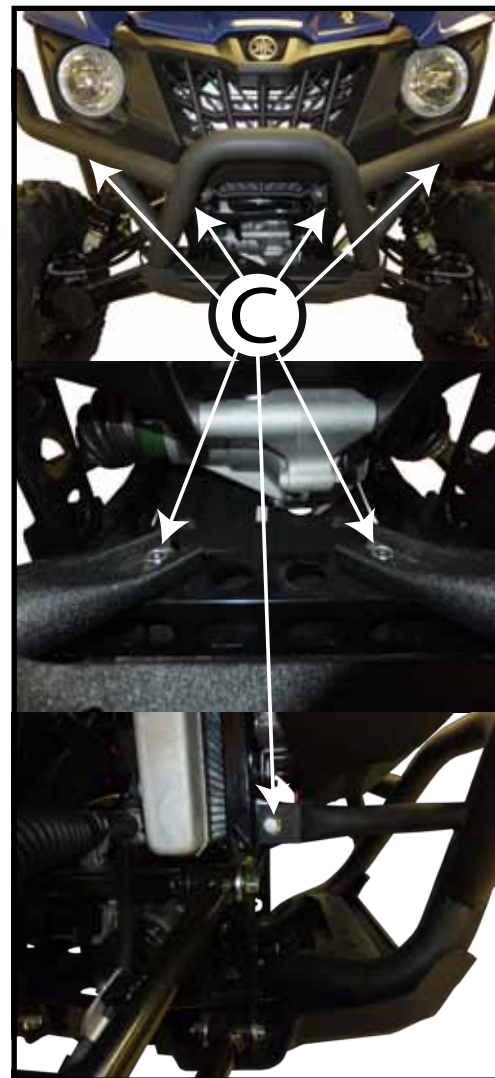

"Figure 7"
Bumper Bolt Locations



"Figure 6" Bumper Removed



WOLVERINE WINCH MOUNT INSTALL (CONTINUED)

5. Place your winch on the mount. Using hardware provided with your winch, secure the winch to the mounting plate as shown in “Figure 8”.

NOTE: Front 2 hex bolts from your winch hardware kit, go through OEM bumper holes shown in “Figure 10”, winch mount and into winch. Hole reference shown in “Figure 9” (F) and “Figure 10”.

6. Place roller fairlead onto mount after feeding winch cable through. Mount roller fairlead to mount using hardware supplied with winch.

7. If your bumper was removed, at this time re-install and repeat step #3.

8. Using the instructions provided with your winch, wire accordingly.

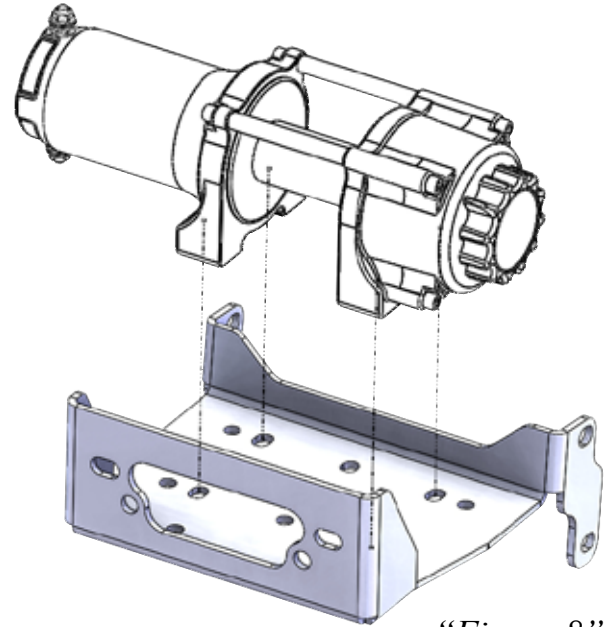

“Figure 8”

STD 4 HOLE WINCH LOCATION

Standard 4 hole winches measure approximately 3”x 4.875”

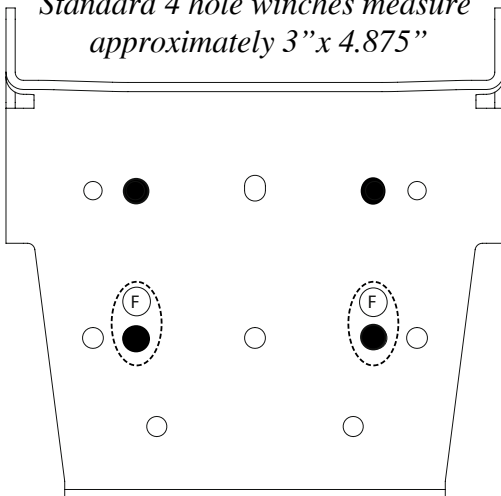

“Figure 9”



“Figure 10” OEM Bumper Bracket



WOLVERINE WIRING INFORMATION

1. Suggested contactor location please see “Figure 11”. *The suggested location is under passenger side fender. Drill small holes in the plastic to mount contactor. Check for wires under the plastic before drilling through plastic.*
2. Find a location that suits your purposes for the mini-rocker switch and hand remote.

Mini-Rocker Switch Hardware kit. This allows you to mount your usual handle bar mounted switch to almost any desired location.

- a. Remove handlebar mount hardware from the switch.
 - b. Locate desired mounting location
 - c. Mark and drill two switch holes through dash using switch housing as a template
 - d. Drill a 3rd hole for the switch wiring.
 - e. Assemble per “Figure 13”.
3. Wire the red ignition wire from the controller to the GREEN (+) wire on the accessory plug as shown in “Figure 15” (G location) using the supplied connector. Follow wires coming from accessory plug (under wheel well on passenger side) to connector. Take connector apart and splice red wire from mini-rocker switch and hand remote into wire, using electrical crimps or solder wires together.
 4. Reconnect accessory plug to other side of electrical connection “Figure 14”



*“Figure 11” Contactor Location
Passenger Side Inner Wheel Well*



“Figure 12” Battery Location

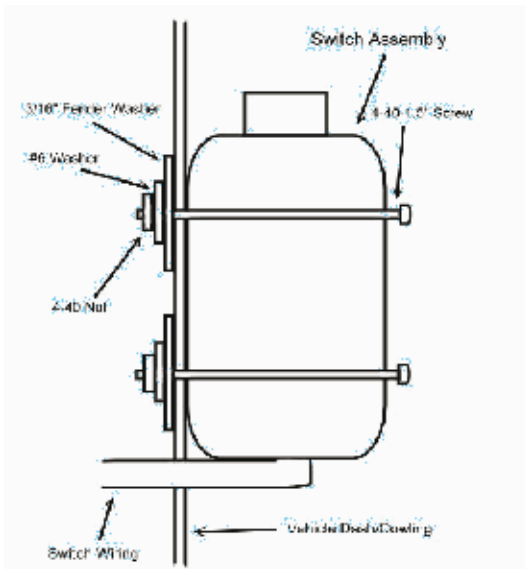

Optional Switch Mount Instructions*

“Figure 13” Mini-Rocker Mounting

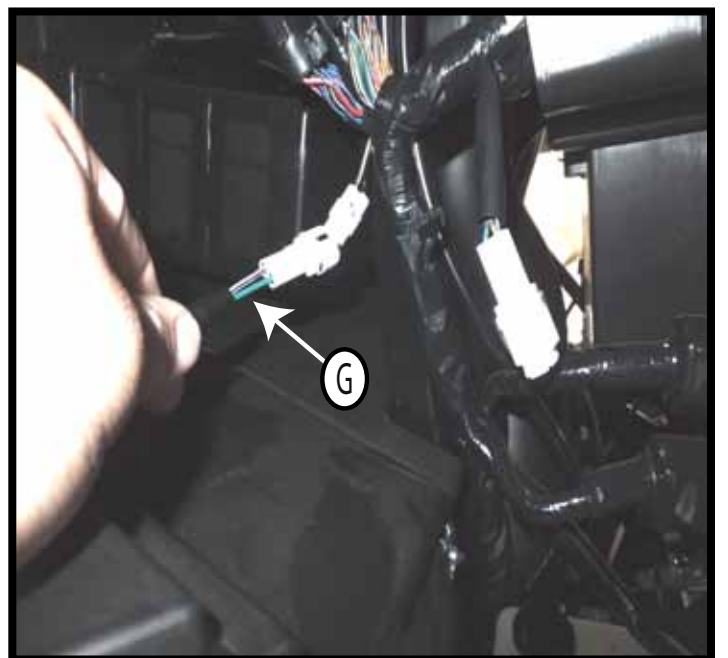

*“Figure 14” Wire Location Under
Passenger Side Fender*

BUMPER MODIFICATION INFORMATION

Depending on the winch you have chosen, you may have to drill holes into the OEM bracket on the bumper. Make sure the winch mount is secured with the 4 bolts (X) shown in “Figure 16”.

2 hole winches

Trace the (D) hole onto OEM bumper flange shown in “Figure 16”. Carefully drill holes using a 3/8” drill bit into the OEM bumper flange for mounting winch. Place 3/8” hex bolt from winch mount hardware kit into location (E) shown in “Figure 16” for added strength.

Wide 4 hole winches

Trace the desired holes onto OEM bumper flange shown in “Figure 5”. Carefully drill holes using a 3/8” drill bit into the OEM bumper flange for mounting winch. Holes for drilling are circled in “Figure 10” (E).

Continue to winch mount installation instructions

2 HOLE WINCH LOCATION

Winch mounting holes are approximately 3.10” apart from each other
*Drill circled holes only

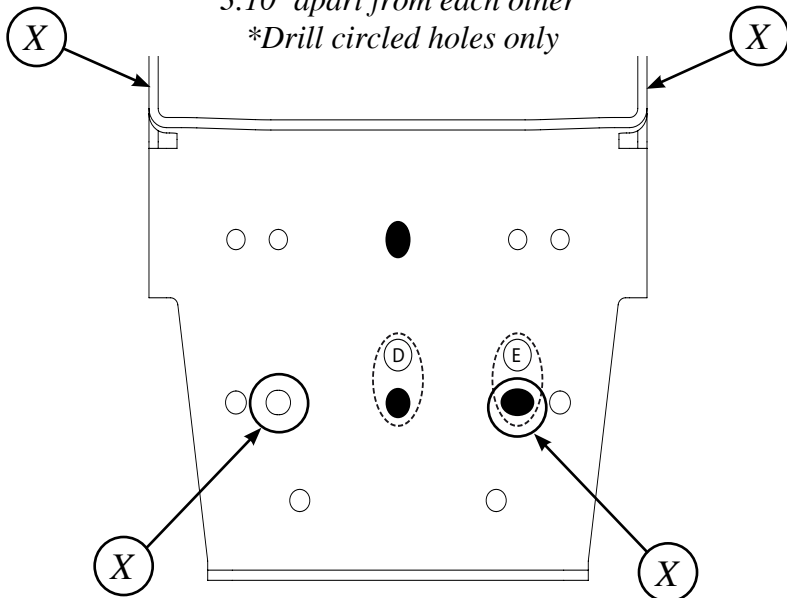

“Figure 16”

WIDE WINCH LOCATION

Wide winch mounting holes measure approximately 3”x 6.60”
*Drill only circled holes

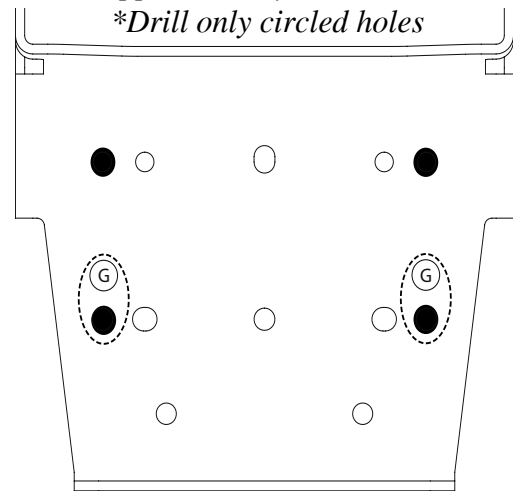

“Figure 17”

