

HONDA PIONEER

Winch Mount

PART # 101150 REV C

Hardware Kit: HK-312, HK-031

Kit Components:

Qty.	Part Description
1.....	Pioneer Winch Plate
2.....	Pioneer Winch Bracket
2.....	3/8"-16 x 2.5" Flange Bolt
2.....	3/8"-16 Flanged Nylock Nut
4.....	5/16"-18 x 2.5" Flange Bolt
4.....	5/16"-18 Flanged Nylock Nut
1.....	UTV Mini Rocker Hardware Kit (HK-031)

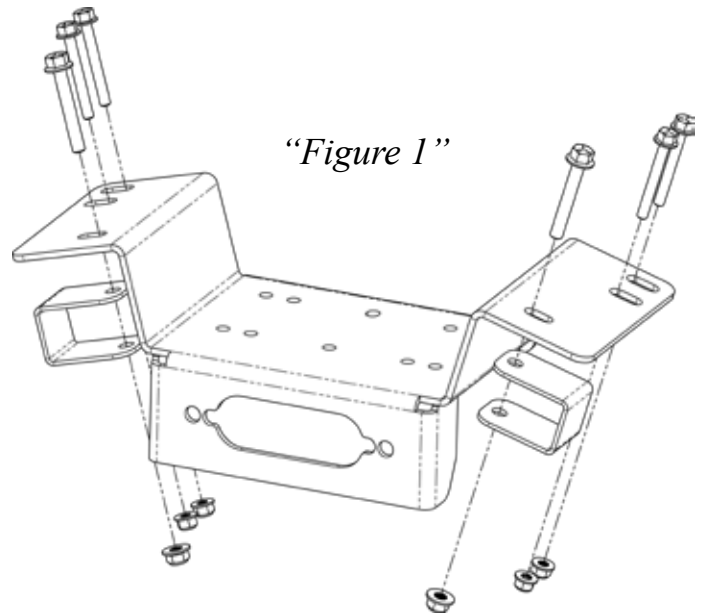

INSTALLATION INSTRUCTIONS:

1. Start by determining which winch you have, see Figure 2.
2. Install your winch and roller fairlead to the mount plate as shown in Figure 3, using the hardware provided with your winch.

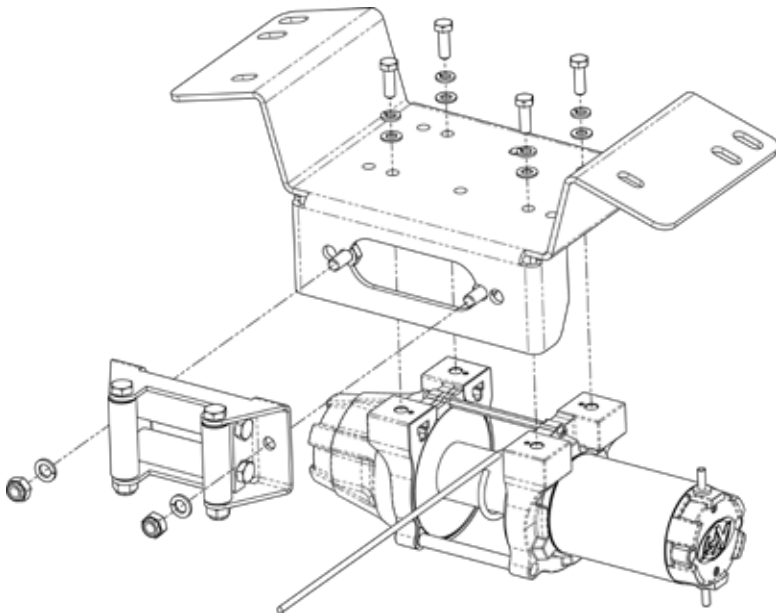

"Figure 3 Winch Install"

Standard 4 Hole Winch Pattern (4.875" x 3")

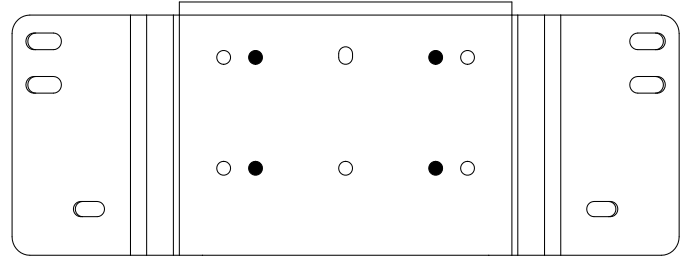

Wide 4 Hole Winch Pattern (6.6" x 3")

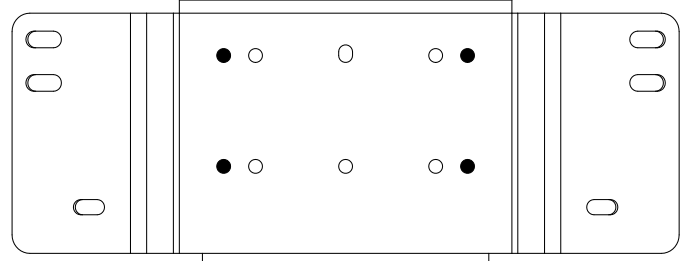

Standard 2 Hole Winch Pattern

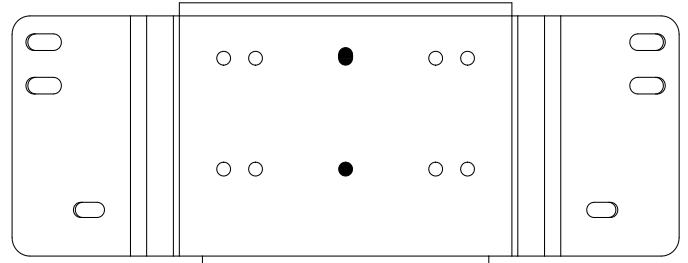

"Figure 2 Winch Hole Pattern"

3. Remove the front bumper by removing the six bolts (A) on both sides of the front bumper as shown in Figure 2. Retain the lower 2 bolts for later re-attachment of the bumper.
4. With the bumper removed place brackets (B) over bumper tubes as shown in Figure 5.
5. Place the mount plate over the brackets. Loosely attach the mount plate and brackets using the 3/8" Bolts (C) and Nuts supplied in the hardware kit. See Figure 5.
6. Place the Bumper Assembly back on the machine, reinstall the upper bumper tubes and mount plate to the frame using the 5/16" Bolts and Nuts (D) supplied in the hardware kit. See Figure 6.
7. Re-attach the lower part of the bumper using the original bolts removed in Step 3.
8. Tighten down all bolts.
9. Use the instructions provided with your winch, wire accordingly.

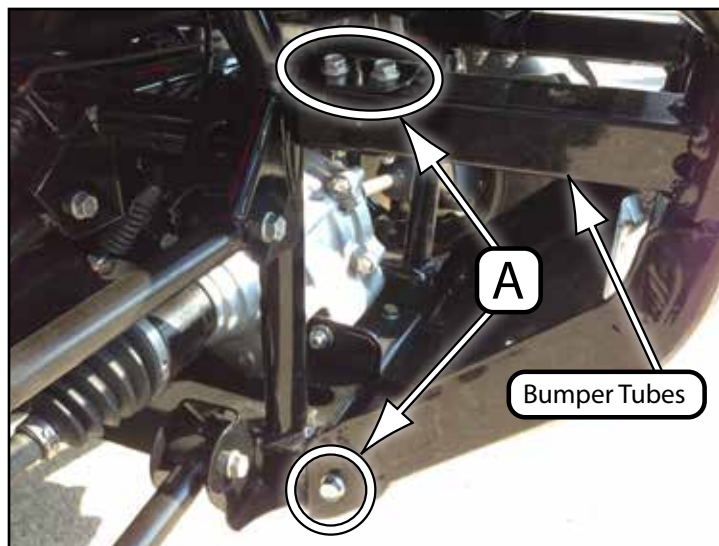

“Figure 4 Bumper Removal”

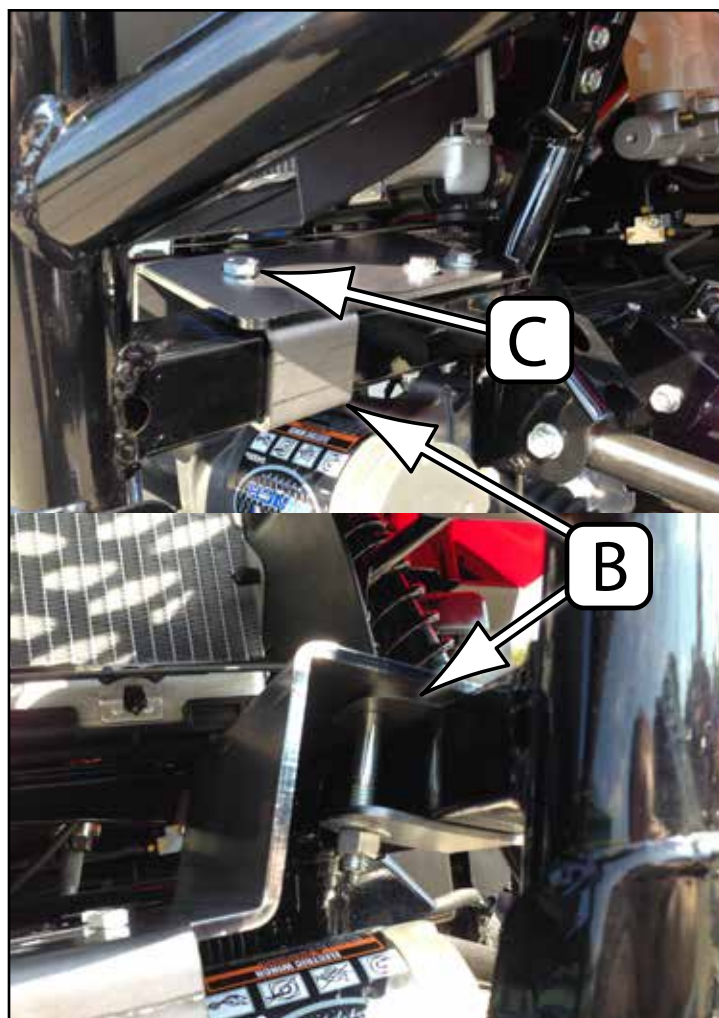

*“Figure 5 Mount and Bracket Install to Bumper”
(Bumper shown attached to frame, the bumper should not be attached at this time.)*

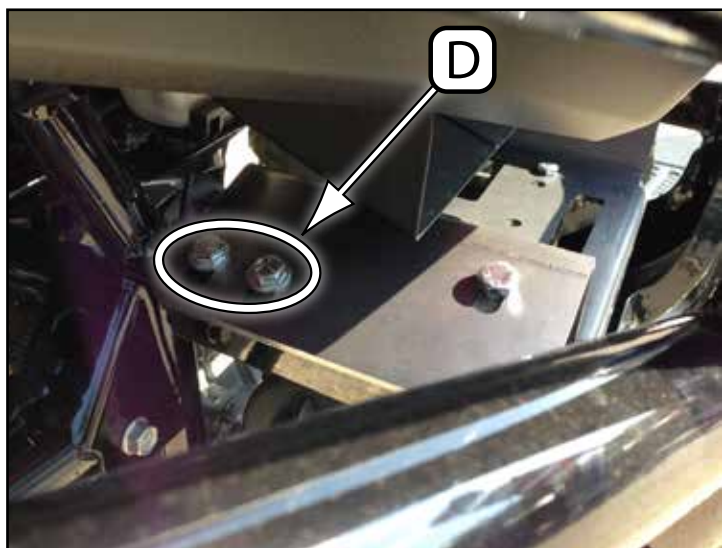

“Figure 6 Bumper and Mount Install to Machine”

WIRING INFORMATION

1. For contactor location please see “Figure 7”. Install the contactor in a location of your choosing under the hood. There is no specific location on this machine, this is just a recommended.
2. Mini-Rocker Switch Hardware kit. This allows you to mount your usual handle bar mounted switch to almost any desired location.
 - a. Remove handlebar mount hardware from the switch.
 - b. Locate desired mounting location
 - c. Mark and drill two switch holes through dash using switch housing as a template
 - d. Drill a 3rd hole for the switch wiring.
 - e. Assemble per Figure 9.
3. Find a location that suits your purposes for the mini-rocker switch and hand remote.
4. Wire the red ignition wire from the controller to a keyed wire. Typically you can find this on the ignition switch.

Note:

The wires will need to be switched for this machine. The longer wires (Blue/Yellow) will be used to go from the battery to the contactor. The shorter wires (Black/Red) will be used to go from the winch to the contactor. See Figure 10 on Page 4 for the alternate wiring diagram.



“Figure 7” Contactor Location



*“Figure 8” Battery Location
(Battery is located under the passenger seat.)*

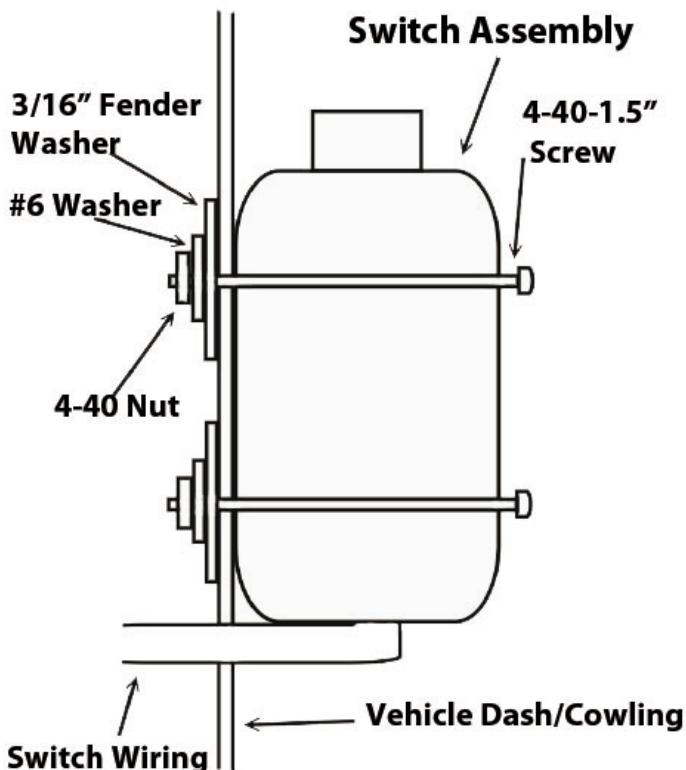

Optional Switch Mount Instructions*

“Figure 9” Mini-Rocker Mounting

ALTERNATE WIRING DIAGRAM

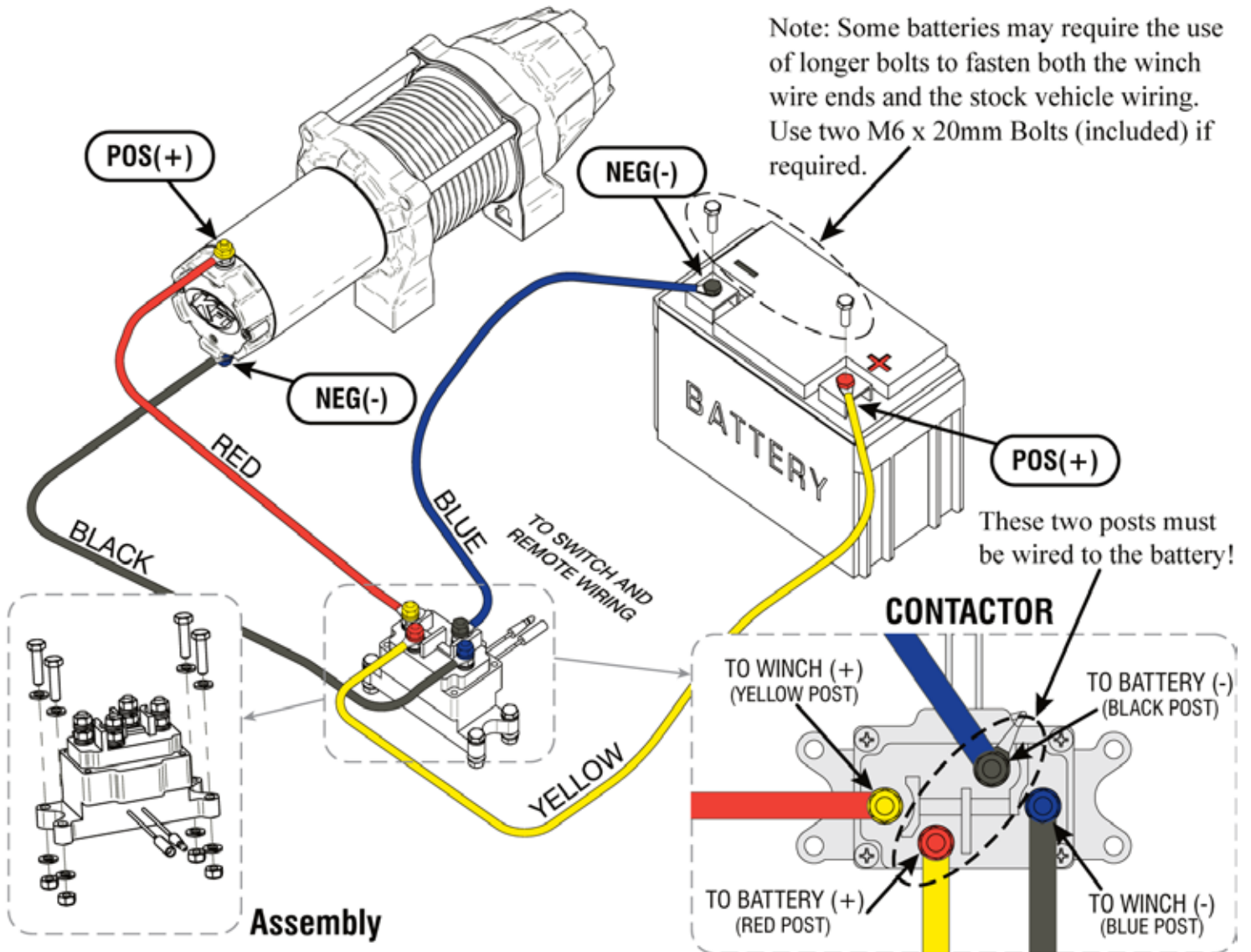

“Figure 10” Alternate Wiring Diagram

