

# HONDA PIONEER 1000

## REAR BUMPER

Winch Mount

PART # 101290

Hardware Kit: HK-322

Kit Components:

Item #	Qty.	Description
1	1	BUMPER
2	1	PASSENGER SIDE BRACKET
3	1	DRIVERS SIDE BRACKET
4	4	BUMPER CAPS
5	4	5/16"-18 X 3/4" CARRIAGE BOLT
6	4	5/16"-18 HEX FLANGED NYLOK NUT
7	2	5/16-18 x 3/4" HEX FLANGE BOLT
8	2	1/4-20 X 3/4" HEX FLANGE BOLT
9	2	1/4-20 HEX FLANGE NYLOK NUT
10	2	6MM-1.00 X 25MM HEX BOLT
11	2	6MM LOCK WASHER

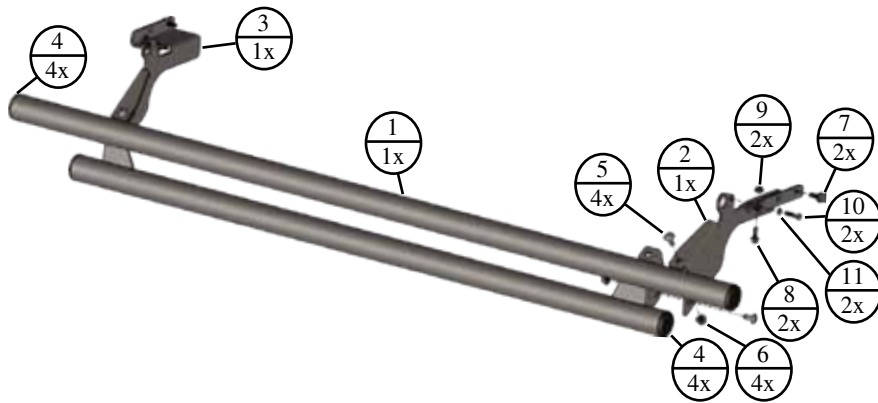

### INSTALLATION INSTRUCTIONS:

*Note: Make sure all of the hardware needed to complete this mount is in the package. Read through and understand the instructions before installing.*

1. Uninstall rear door by removing four bolts (A) as shown in [Figure 1](#).
2. Uninstall rear inner panel by removing three screws (B), hook bolt (C) and plastic push pin (D) as shown in [Figure 2](#).
3. Uninstall rear light by removing two screws (E) and clip (F) as shown in [Figure 3](#).
4. Uninstall rear outer panel by removing two bolts (G) as shown in [Figure 4](#).

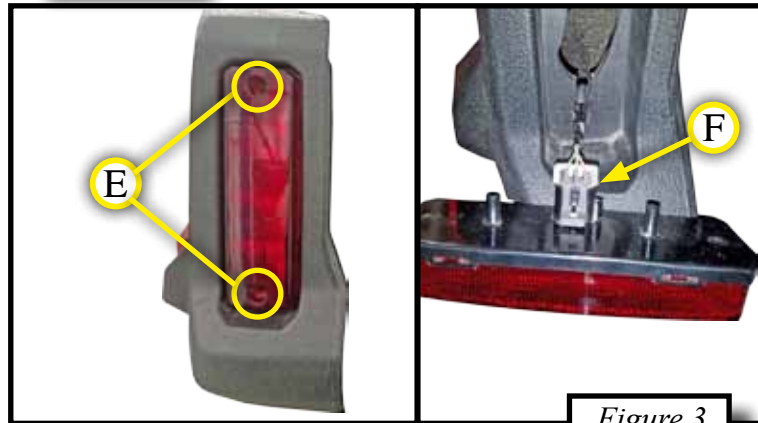
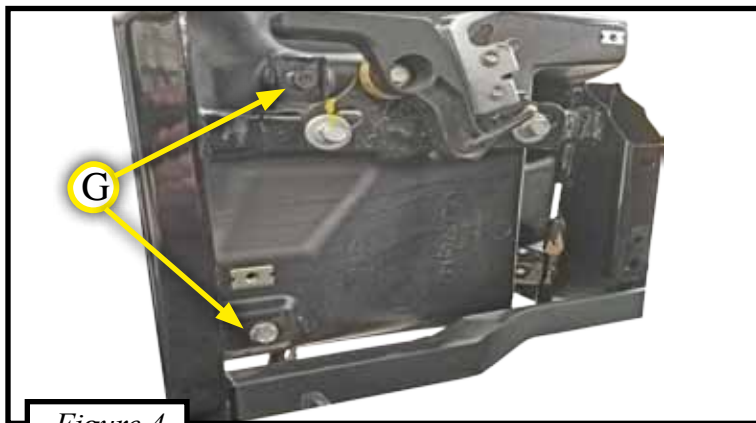
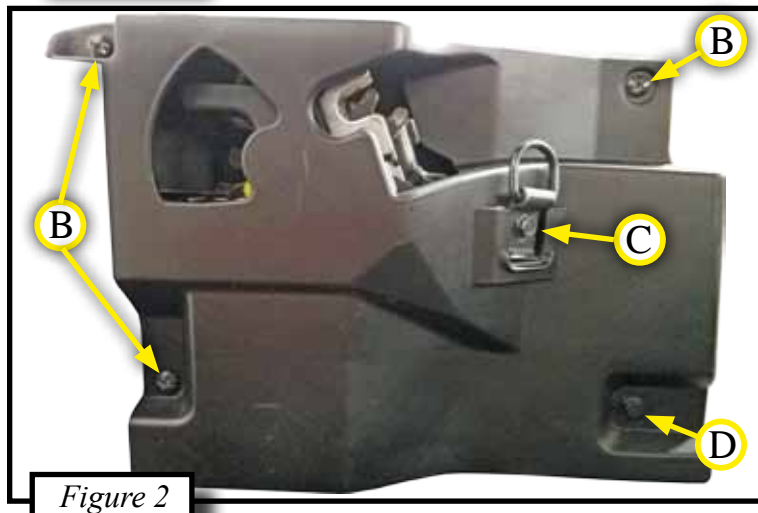
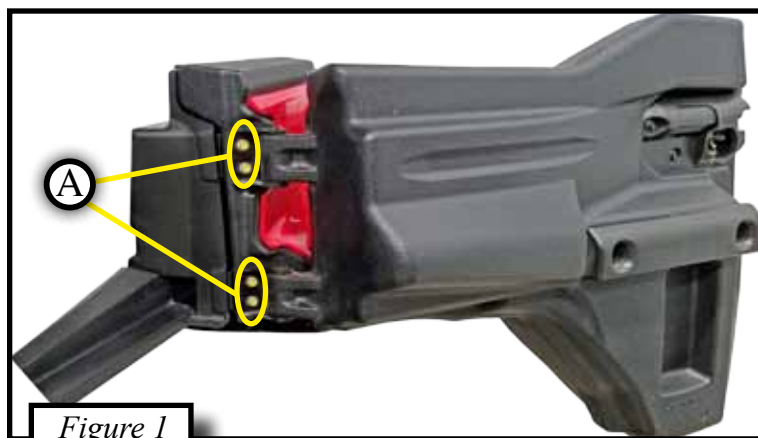

## INSTALLATION CONTINUED:

5. Remove hinge bolt (H) and plastic cap from the square tubing (already removed) as shown in *Figure 5*.
6. Remove hinge and insert through driver side bracket. Using M6 bolt (10) and washer (11), loosely install bracket as shown in *Figure 6*. Note: M6 bolt will have an 8.8 marked on the head.
7. Rotate bracket upward to tubing and install bolt (8) and nut (9) as shown in *Figure 6*. Tighten all hardware evenly.
8. Repeat steps 1-7 on the passenger side of machine before installing bumper tube (1)

## OPTIONAL MOUNTING (Requires Drilling)

9. Using 1/4" diameter drill bit, drill rear hole on bracket as shown in *Figure 7*. DO NOT DRILL ALL THE WAY THROUGH TUBING.
10. Install self threading bolt (7) as shown in *Figure 8*.

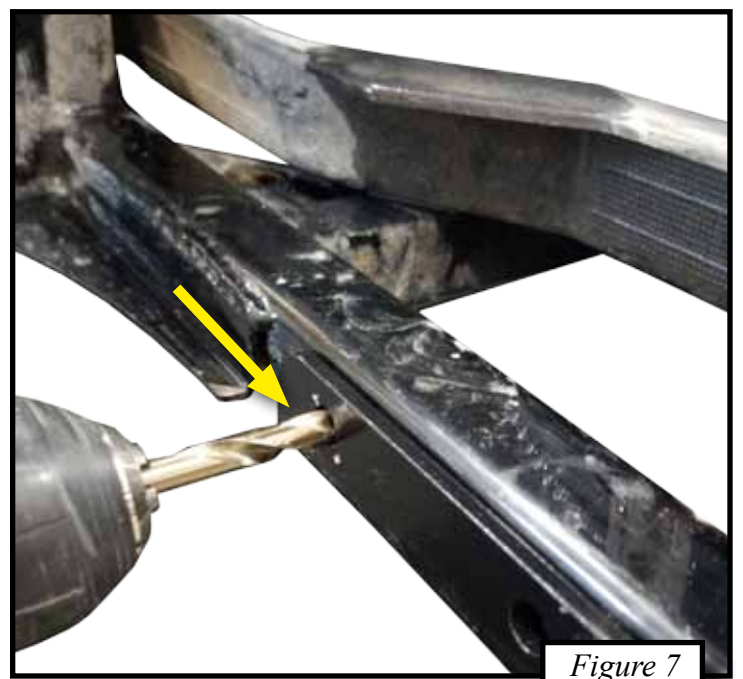
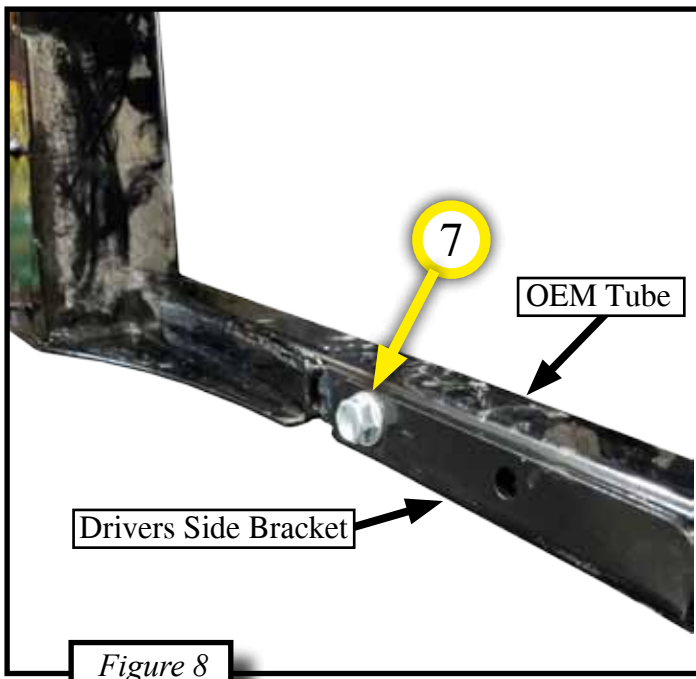
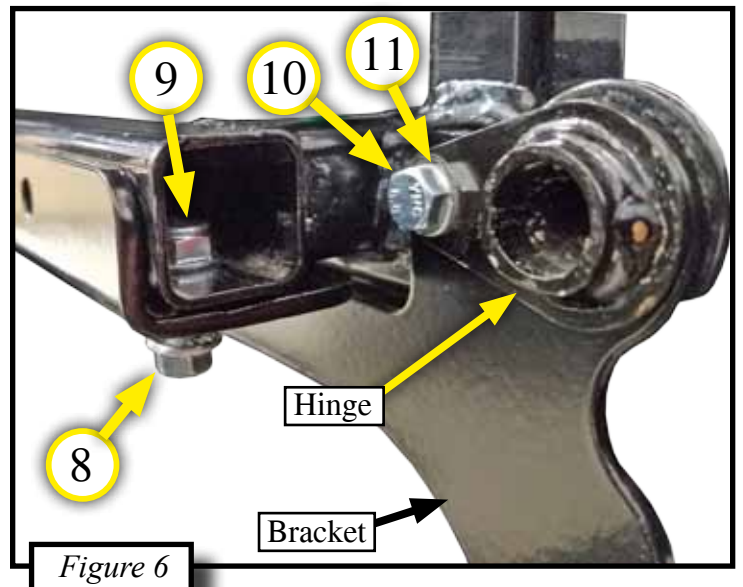
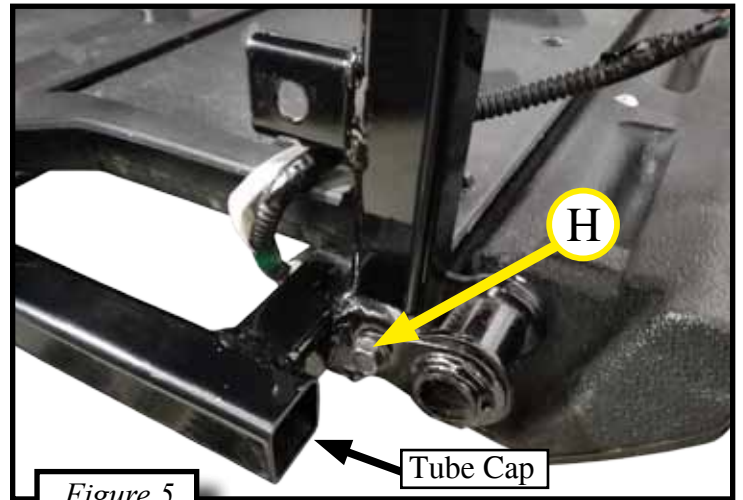

## INSTALLATION CONTINUED:

11. Holding the bumper, align the holes with those on the brackets. Install two carriage bolts (5) and nuts (6) loosely as shown in *Figure 9*.
12. Once all hardware has been installed loosely, tighten all hardware evenly as shown in *Figure 10*.
13. In reverse order, reinstall all components removed for bumper installation. Tighten all hardware
14. Install the four bumper end caps included in your kit. Shown in locations marked below.

