

Polaris Ranger 570 Rear Tube Bumper

Bumper

PART # 101360

Kit Components:

Item #	Qty.	Description
1	1	Bumper
2	1	Bumper Bracket Driver Side
3	1	Bumper Bracket Passenger Side
4	1	Bumper Hanger Bracket Driver
5	1	Bumper Hanger Bracket Passenger
6	4	Bumper Tube Cap
7	1	HK-343
7.1	8	5/16"-18 x .75 Hex Flange Bolt GR5
7.2	6	5/16"-18 x .75 Carriage Bolt GR5 Black
7.3	14	5/16"-18 Nylock Hex Flange Nut GR5
7.4	2	5/16" x 1 Hex Flange Bolt Self-Tapping Type F Zinc (NOT USED)
7.5	2	1/4" X .75 Hex Flange Bolt Self-Tapping Type F Zinc (NOT USED)

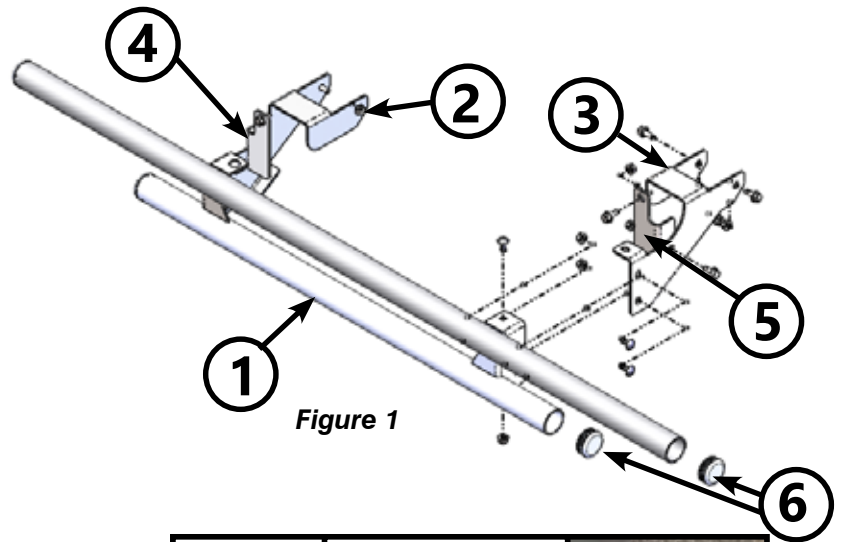

Figure 1

Installation:

1. Assemble tube caps (6) to bumper tubes as shown in *Figure 1*.
2. Hold passenger side bumper bracket (3) in place over bed hinge. Insert one 5/16" X .75 Hex Flange Bolt (7.1) and 5/16" Nylock Hex Flange Nut (7.3) on each side of bumper bracket as shown in *Figure 2*
3. Line up hanger bracket with hole in bed frame rail. Use two 5/16 X .75" Hex Flange Bolts (7.1) and 5/16 Nylock Hex Flange Nuts (7.3) to bolt hanger brackets to the bed frame rail and bumper brackets as shown in *Figure 3*. Repeat steps 2&3 for driver side.
4. Bolt bumper (1) to bumper brackets (2) using six 5/16 X .75" Carriage Bolts BLK (7.2) and 5/16 Hex Flange Nylock Nuts (7.3) *Figure 4*.
5. Evenly tighten all hardware

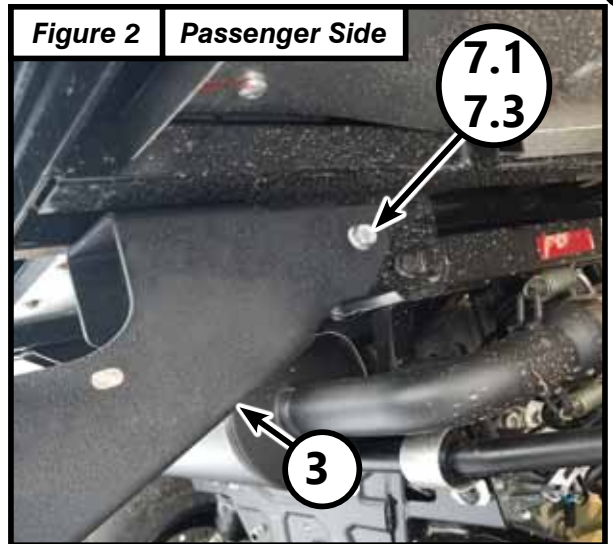

Figure 2 Passenger Side

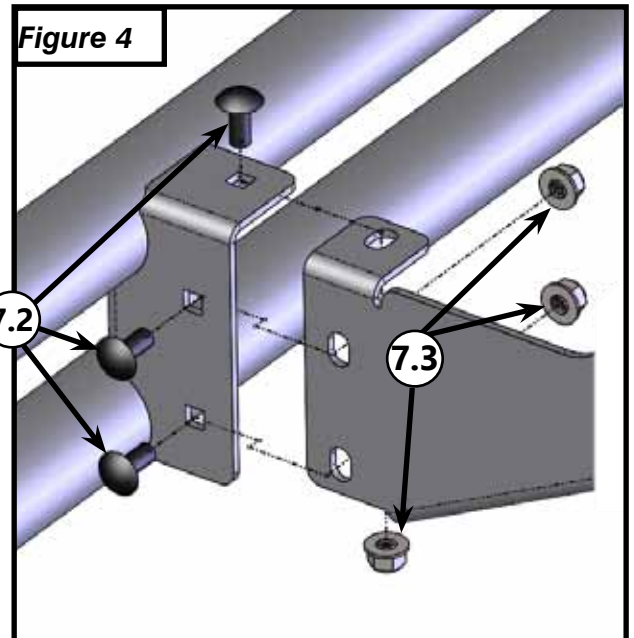

Figure 4

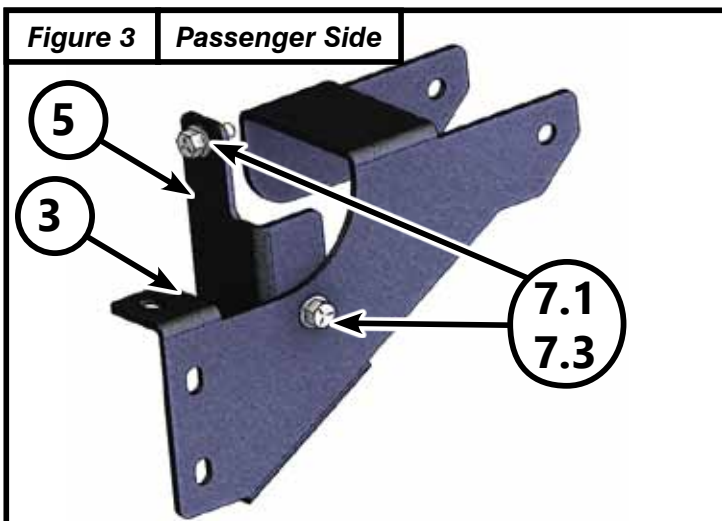

Figure 3 Passenger Side

