

Polaris Ranger 1000 XP Rear Tube Bumper

Bumper **PART # 101525**

Kit Components:

Item #	Qty.	Description
1	1	Bumper
2	1	Bumper Bracket Driver Side
3	1	Bumper Bracket Passenger Side
4	4	Bumper Tube Cap
5	1	HK-343
5.1	8	5/16"-18 x .75 Hex Flange Bolt GR5
5.2	6	5/16"-18 x .75 Carriage Bolt GR5 Black
5.3	14	5/16"-18 Nylock Hex Flange Nut GR5
5.4	2	5/16" x 1 Hex Flange Bolt Self-Tapping Type F Zinc
5.5	2	1/4" X .75 Hex Flange Bolt Self-Tapping Type F Zinc (NOT USED)

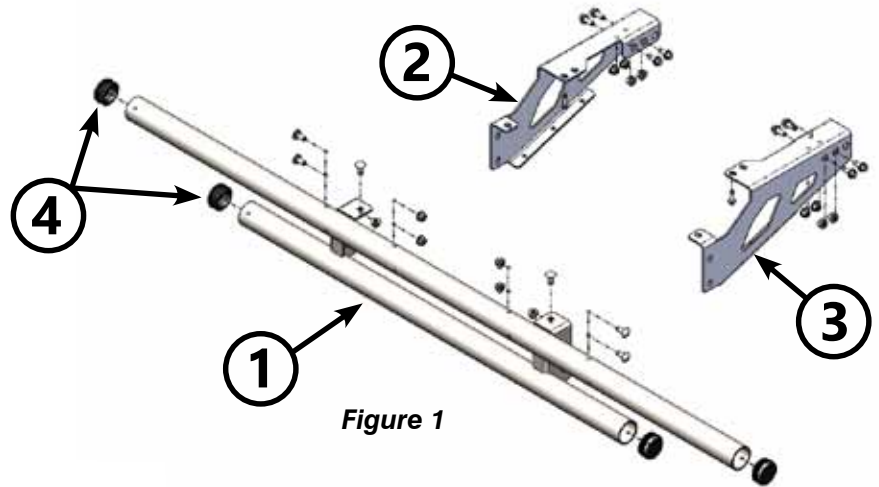

Installation:

- Assemble tube caps (4) to bumper tubes as shown in *Figure 1*.
- Hold passenger side bumper bracket (2) in place over bed hinge and use two 5/16"-18 x .75 Carriage Bolts (5.1) and 5/16" Nylock Hex Flange Nuts (5.3) to bolt brackets to the bed hinge as shown in *Figure 2*. Repeat step 2 for driver side.
- Run one Self-Tapping screw (5.4) up through location (C) and into the passenger side box frame as shown in *Figure 2 & 3*. Turn until hand-tight only! Do not over-tighten or you may strip the hole. Repeat step 3 for driver side.
- Bolt bumper (1) to bumper brackets (2) using six 5/16" X .75 Carriage Bolts BLK (5.2) and 5/16" Hex Flange Nylock Nuts (5.4) *Figure 4*.
- Level bumper and evenly tighten all hardware

