

# Textron Prowler Pro Rear Tube Bumper

## Bumper

PART # 101675

### Kit Components:

Item #	Qty.	Description
1	1	Bumper
2	1	Bumper Bracket Driver Side
3	1	Bumper Bracket Passenger Side
4	1	Bumper Hanger Bracket Driver
5	1	Bumper Hanger Bracket Passenger
6	6	Bumper Tube Cap
7	1	HK-343
7.1	8	5/16"-18 x .75 Hex Flange Bolt GR5
7.2	6	5/16"-18 x .75 Carriage Bolt GR5 Black
7.3	14	5/16"-18 Nylock Hex Flange Nut GR5
7.4	2	5/16" x 1 Hex Flange Bolt Self-Tapping Type F Zinc
7.5	2	1/4" X .75 Hex Flange Bolt Self-Tapping Type F Zinc (NOT USED)

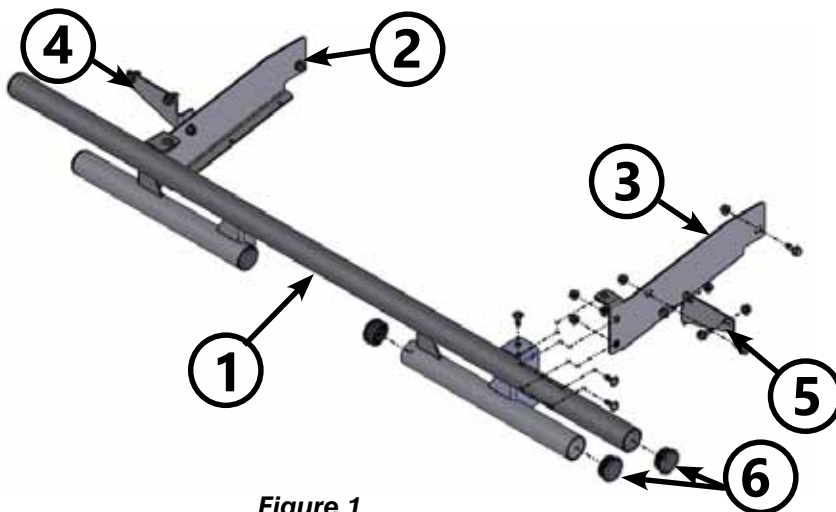

Figure 1

### Installation:

- Assemble tube caps (6) to bumper tubes as shown in *Figure 1*.
- Remove bed hinge nut (A) shown in *Figure 2*. Repeat step 2 for passenger side.
- Place driver side bumper bracket (2) and hanger bracket (4) over bed hinge bolt, reinstall nut (A) removed in step 2.
- Line up hanger bracket (4) with holes in bed frame rail and use two 5/16" x .75 Bolts (7.1) and 5/16" Nuts (7.3) to bolt bumper brackets to hanger and the bed frame rail as shown in *Figure 3*. Repeat step 3 for passenger side.
- Bolt bumper (1) to bumper brackets (2&3) using six 5/16" x .75 Carriage Bolts Black (7.2) and 5/16" Nuts (7.3) *Figure 4*.
- Evenly tighten all hardware

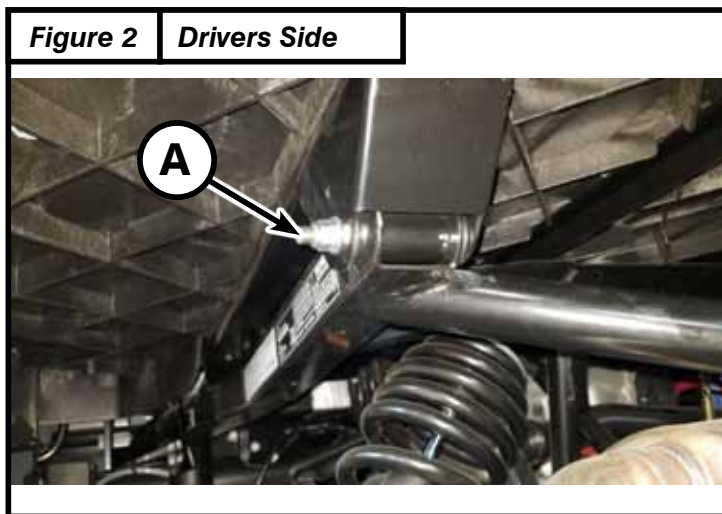

Figure 2 Drivers Side

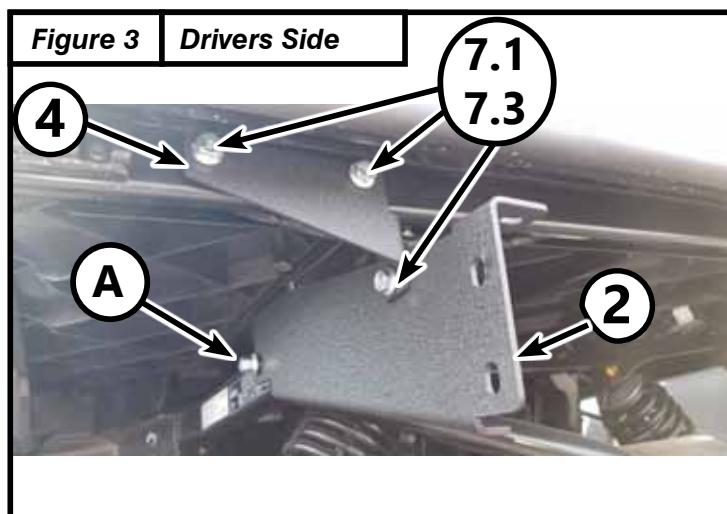

Figure 3 Drivers Side

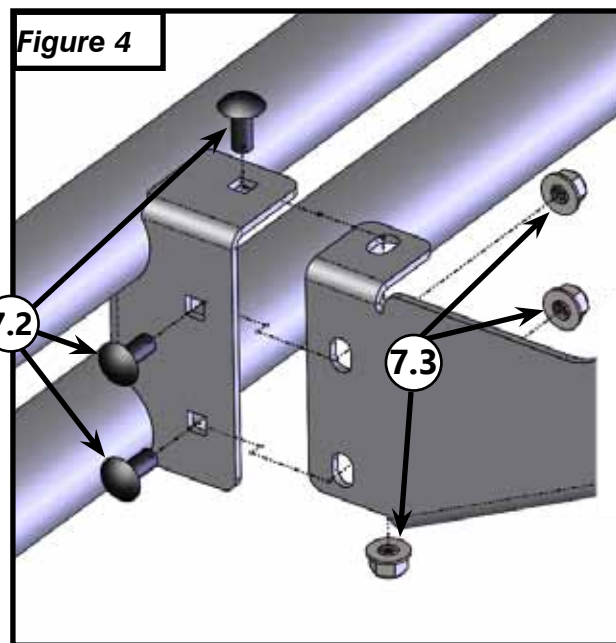

Figure 4

