

POLARIS XPEDITION

WINCH MOUNT

PART #102150 Rev A

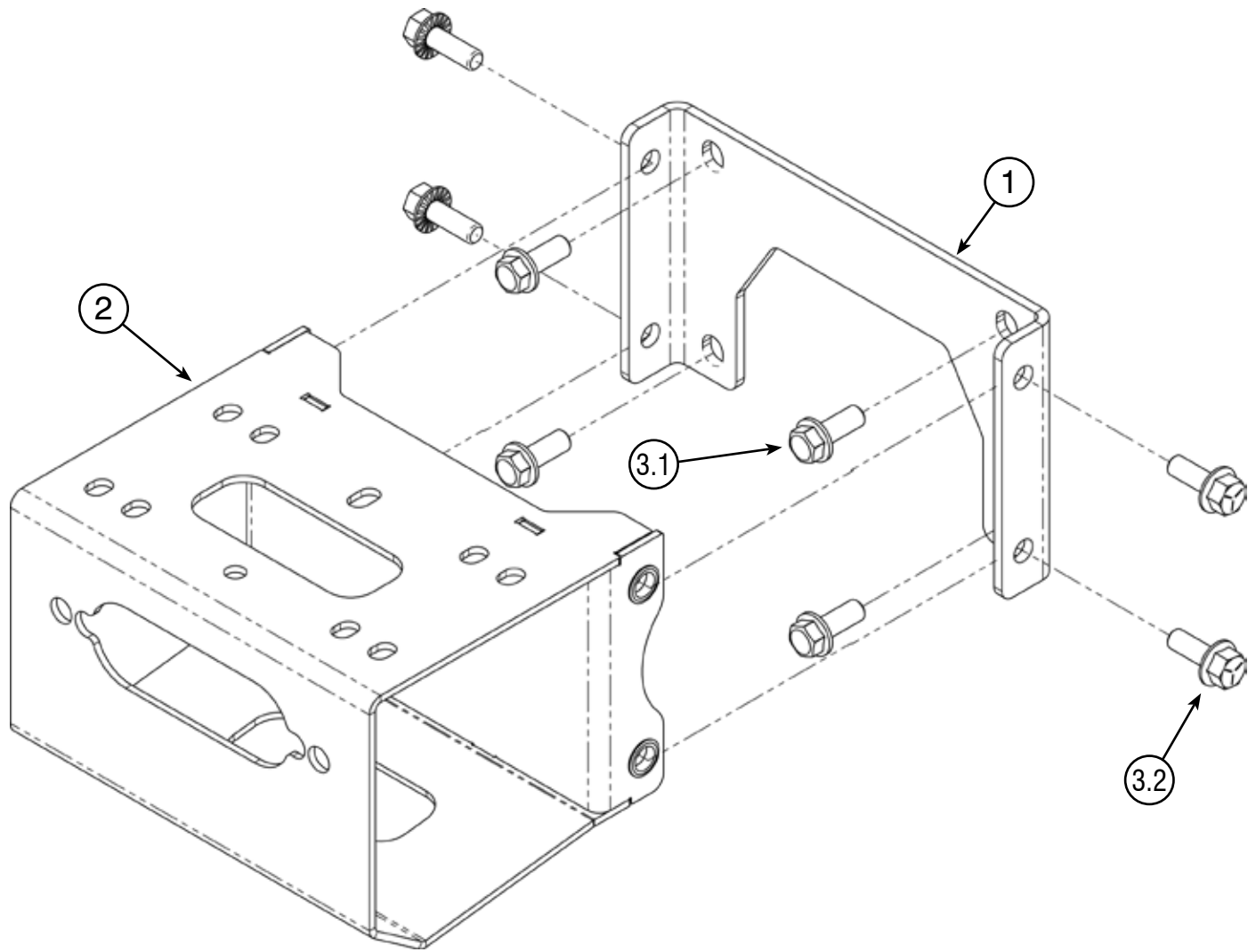

Kit Components:

Item #	Qty.	Description	Item #	Qty.	Description
1	1	Support Bracket (102154)	3.1	4	M10-1.50 X 25 Hex Bolt
2	1	Winch Mount Bracket (102151)	3.2	4	3/8"-16 x 1.00" Hex Bolt Flange
3	1	Hardware Kit (HK-448)			



INSTALLATION INSTRUCTIONS

Notice

Torque bolts to ANSI Specs (or OEM specs if applicable), unless otherwise stated. After the first use and at the start of each season, check torque.

Note: Make sure all hardware needed to complete this mount is in the package. Thoroughly read through and understand the instructions before installing.

OEM Winch Removal Instructions

1. Before removing the factory winch, unhook the negative battery cable located under the driver's seat of the machine.
2. Unhook the OEM winch positive (red) wire from the pulse bar and the OEM winch negative (black) wire from the post located underneath the front fender on the driver's side of the machine. Be sure to only remove the negative winch cable from the post. Reinstall the bolt making sure the ground wire going to the pulse bar is still attached. See **Figure 8** on the following page.
3. Unhook the gray (4-wire) and white (2-wire) winch plugs from the OEM wiring harness.
4. Feed the OEM winch wire loom through the rubber grommet and detach all connectors securing it to the frame which runs down to the winch.
5. Remove the four bolts (A) securing the winch. See **Figure 1**. Lift the winch upward and pull it toward the front of the machine to disengage the hanger bolts from the key slots on the frame. See **Figure 2**. The OEM wiring harness should freely come out with the winch.

Important: The OEM cables attached at the winch are power and ground wires and **must not** be connected directly to the replacement winch **under any circumstances**. Doing so will cause the winch to activate immediately without any control.

Installation Instructions

6. Loosely install the support bracket (1) using bolts (3.1) as shown in **Figure 3**. Once all bolts are started, tighten the hardware evenly.
7. Install the fairlead onto the winch mount bracket (2) using the hardware provided with the winch. See **Figure 4**.
8. Secure the winch to the winch mount bracket (2), ensuring that the winch motor end is positioned on the driver's side of the machine. For wide 4-Hole winches, use holes (B). For standard 4-Hole winches, use holes (C). For a 2-Hole mounted winch, use holes (D). Use the hardware supplied with the winch. See **Figures 4 and 5**.

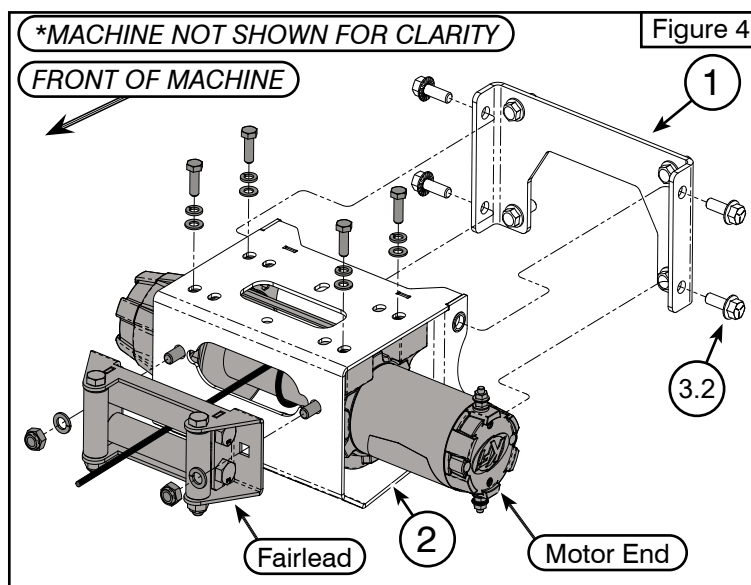
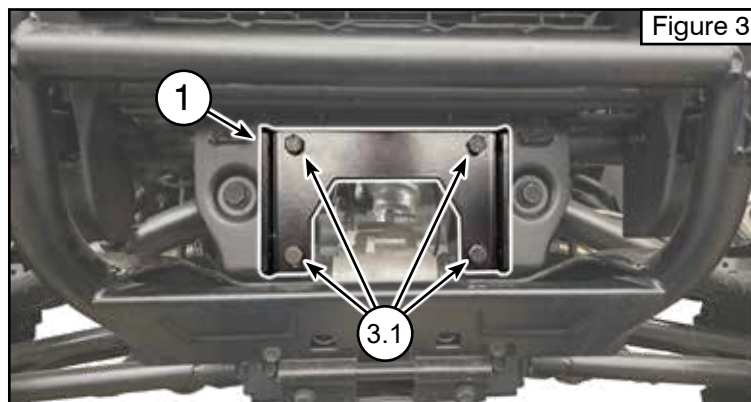
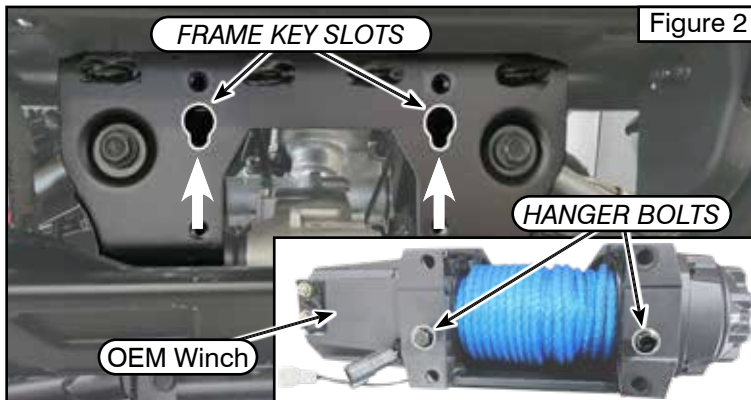
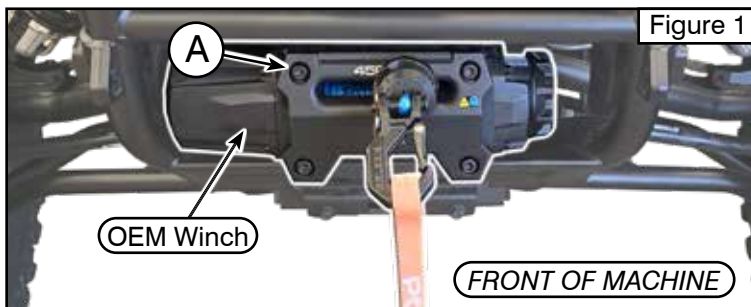

9. Align the winch mount bracket (2) and attach it to the support bracket (1) using bolts (3.2). The bottom bolts can be tightened using a socket and an extension by accessing the gap between the bumper and the plastic trim (Locations E and F). See **Figures 4, 6, and 7**.
10. Ensure all bolts are properly tightened.

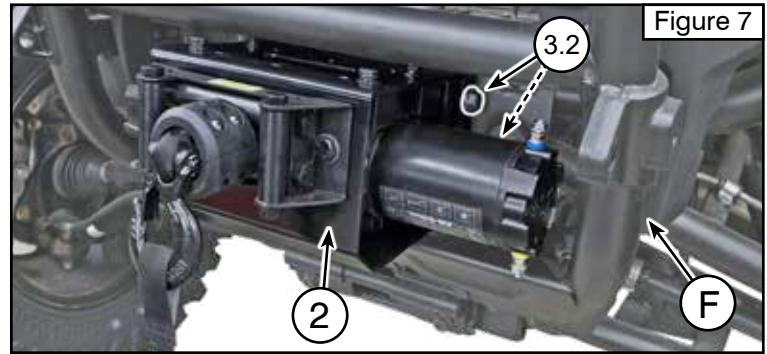
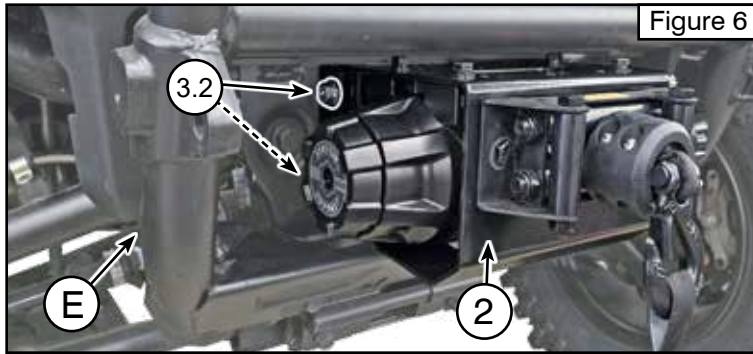
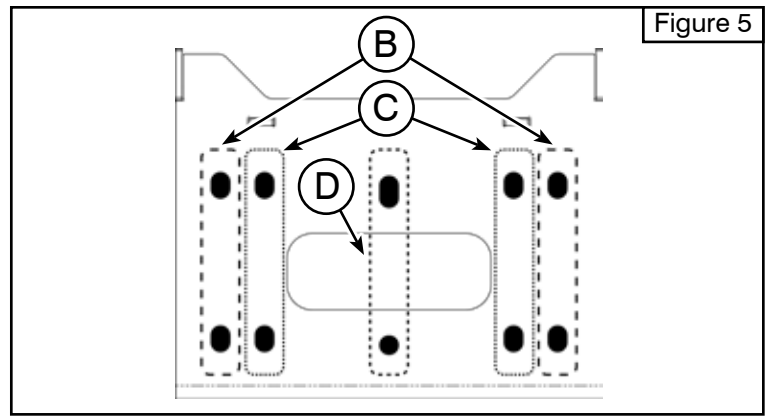

WIRING INSTRUCTIONS

1. Wire the winch and switch by referencing the winch manual.
2. The contactor can be attached under the hood near the pulse bar or relocated as needed.
3. Run the red positive (+) battery wire from the contactor to the positive (+) post on the pulse bar and the black ground (-) wire from the contactor to the ground (-) post on the pulse bar. See **Figure 8**.
4. Use a KFI 3-pin harness (#101505), which connects to the pulse bar, as a source for the key hot wire.
5. Remove the center console to allow for access to the backside of the switch panel where the OEM winch switch is located.

Note: The windshield latch will need to also be removed if vehicle is equipped with a factory windshield.

6. Run the switch wires through the rubber grommet located next to the pulse bar. See **Figure 8**. Remove the factory winch switch and install the new one in its place.
7. Verify the installation: Ensure all wires are correctly connected, all bolts/nuts are tightened, and the winch operates as expected with the key turned on.

