

CENTERED FAIRLEAD ADAPTER/SPACER

Winch Accessory

PART #102160 Rev A

Kit Components:

Item #	Qty.	Description
1	1	Centered Fairlead Adaptor / Spacer (102114)
2	1	Hardware Kit HK-444
2.1	2	3/8"-16 x 1.50 Hex Bolt Flange
2.2	2	3/8"-16 x 1.25 Low Profile Hex Socket Cap
2.3	2	3/8"-16 x 1.00 Hex Bolt
2.4	4	3/8"-16 Hex Nut Flange Nylock

This product is designed to address two fitment challenges: to adapt a standard winch fairlead onto a wide-only bolt pattern and to provide spacing clearance for new bumpers.

Figure 1



INSTALLATION INSTRUCTIONS

STANDARD Winch Only (Figure 1 & 2)

1. Insert hex bolts (2.3) through the back of the adapter and seat them into the slot provided.
2. Secure the adapter to the bumper using the low profile bolts (2.2). Figure 1
3. Mount the roller fairlead to the adapter onto bolts (2.3) and tighten all hardware. Figure 2

WIDE Winch Only (Figure 3)

1. Insert hex bolts (2.1) through the back of the bumper and through both the adapter and roller fairlead.
2. Tighten bolts securely.

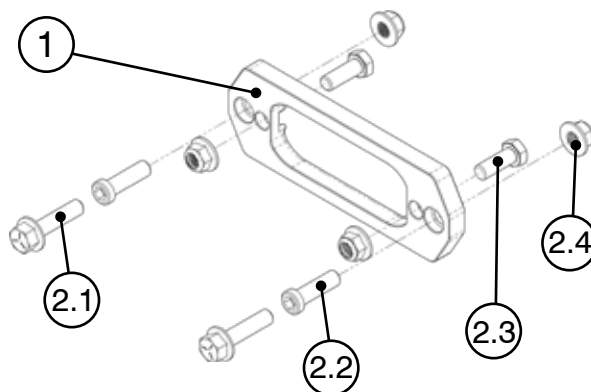

NOTICE

Torque bolts to ANSI Specs (or OEM specs if applicable), unless otherwise stated. After the first use and at the start of each season, check torque.

NOTE: Make sure all hardware needed to complete this mount is in the package. Thoroughly read through and understand the instructions.

Figure 2 Wide to Standard Fairlead Adapter

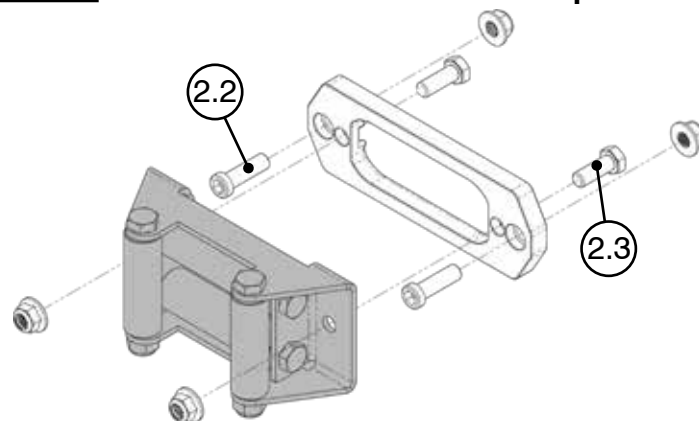

Figure 3 Wide Fairlead Spacer

