

# KAWASAKI RIDGE REAR BUMPER

Formed Bumper PART #102235

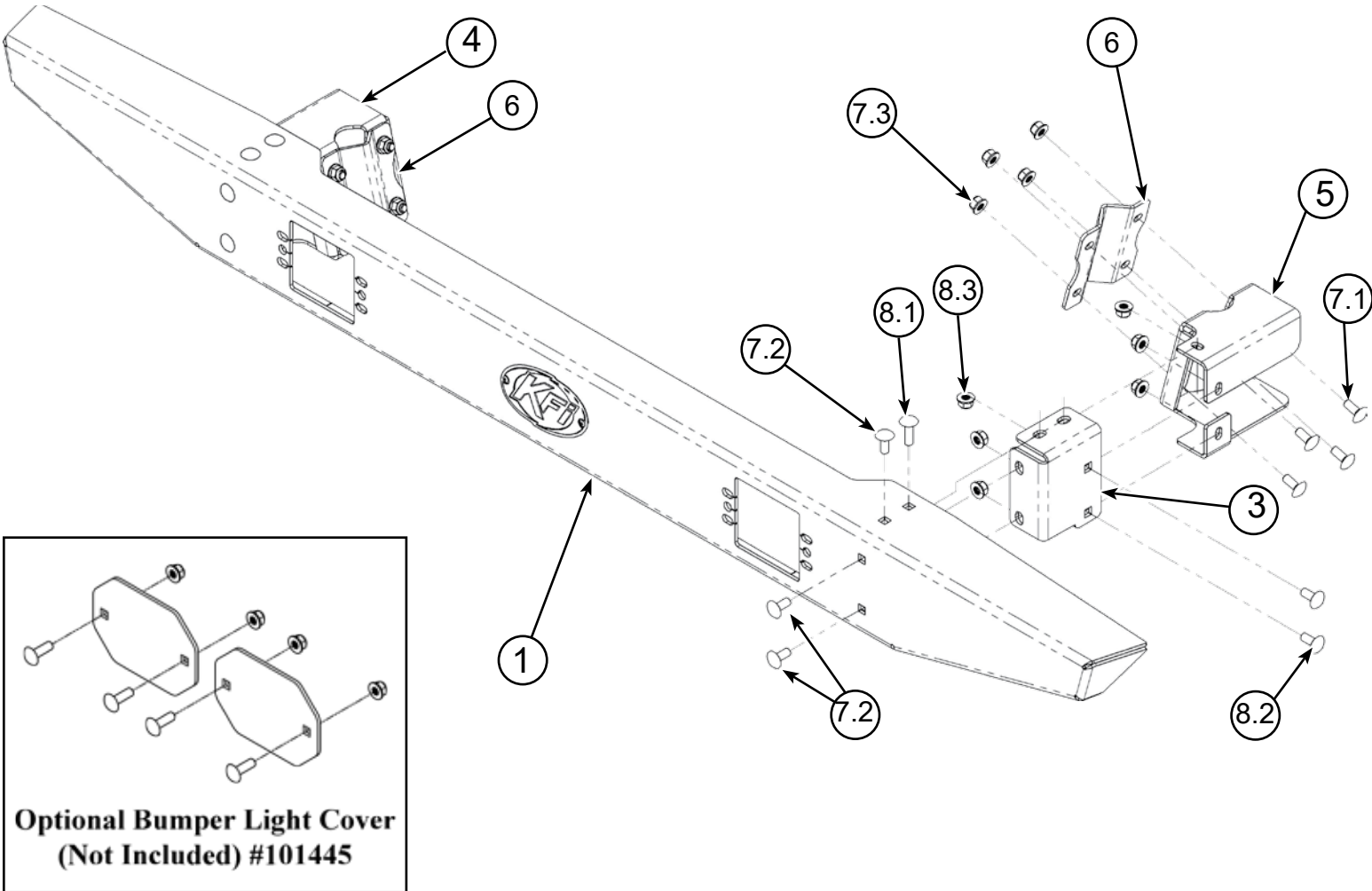

Kit Components:

Item #	Qty.	Description	Item #	Qty.	Description
1	1	Rear Bumper Formed Ridge (102236)	7	1	Hardware Kit HK-452
2	1	Driver Side Conversion Bracket (Not Shown) (101488)	7.1	8	5/16"-18 X .75" Carriage Bolt Short Neck GR5
3	1	Passenger Side Conversion Bracket (101489)	7.2	6	5/16"-18 x .75" Carriage Bolt Short Neck GR5 Black
4	1	Bumper Mount Driver Side (102231)	7.3	14	5/16"-18 Hex Nut Flange Nylock GR5
5	1	Bumper Mount Passenger Side (102232)	8	1	Hardware Kit HK-342
6	2	Bumper Mount Clamp (102233)	8.1	2	5/16"-18 x 1.00" Carriage Bolt Short Neck GR5 Black
			8.2	4	5/16"-18 x .75" Carriage Bolt Short Neck GR5
			8.3	6	5/16"-18 Hex Nut Flange Nylock GR5



# INSTALLATION INSTRUCTIONS

**Note: Ensure all necessary hardware is included in the package before beginning installation. Carefully read and fully understand the instructions before proceeding..**

1. During installation, leave all hardware hand-tight until the manual instructs you to fully tighten. Tightening hardware too early may cause alignment issues.
2. Locate rear frame tubes A and B as shown in **Figure 1**. Position the Driver Side Bumper Mount (4) and Bumper Mount Clamp (6) as illustrated in **Figure 2**. Secure loosely using bolt (7.1) and nut (7.3). Repeat the process on the Passenger Side using parts (5 & 6), again referencing **Figure 1**.

*Note: With assistance, measure down 3.0 inches as shown in Figure 2. loosely tighten one of the Bolts (7.1) and nut (7.3) just enough to hold the brackets in place.*

3. With the mounts (4,5 and 6) in place, install Conversion Bracket (2 and 3). Use bolt (8.2) and nut (7.3) to secure it loose. See **Figure 3**.
4. Place Bumper (1) onto the installed Conversion Bracket (2 & 3) as shown in **Figure 3 & 4**. Use bolts (7.2) through the face and bolt (8.1 and 7.2) through the top. Use nuts (8.3) to secure the bumper. Repeat on both sides.
5. Once the bumper is in place, square and level it to the bed , recheck the 3.0" bracket measurement.
6. Finally, evenly tighten all hardware to complete installation.

