

TRACK EXTENSION

HYDRAULIC ACTUATOR BRACKET

Plow Accessory

PART #106065

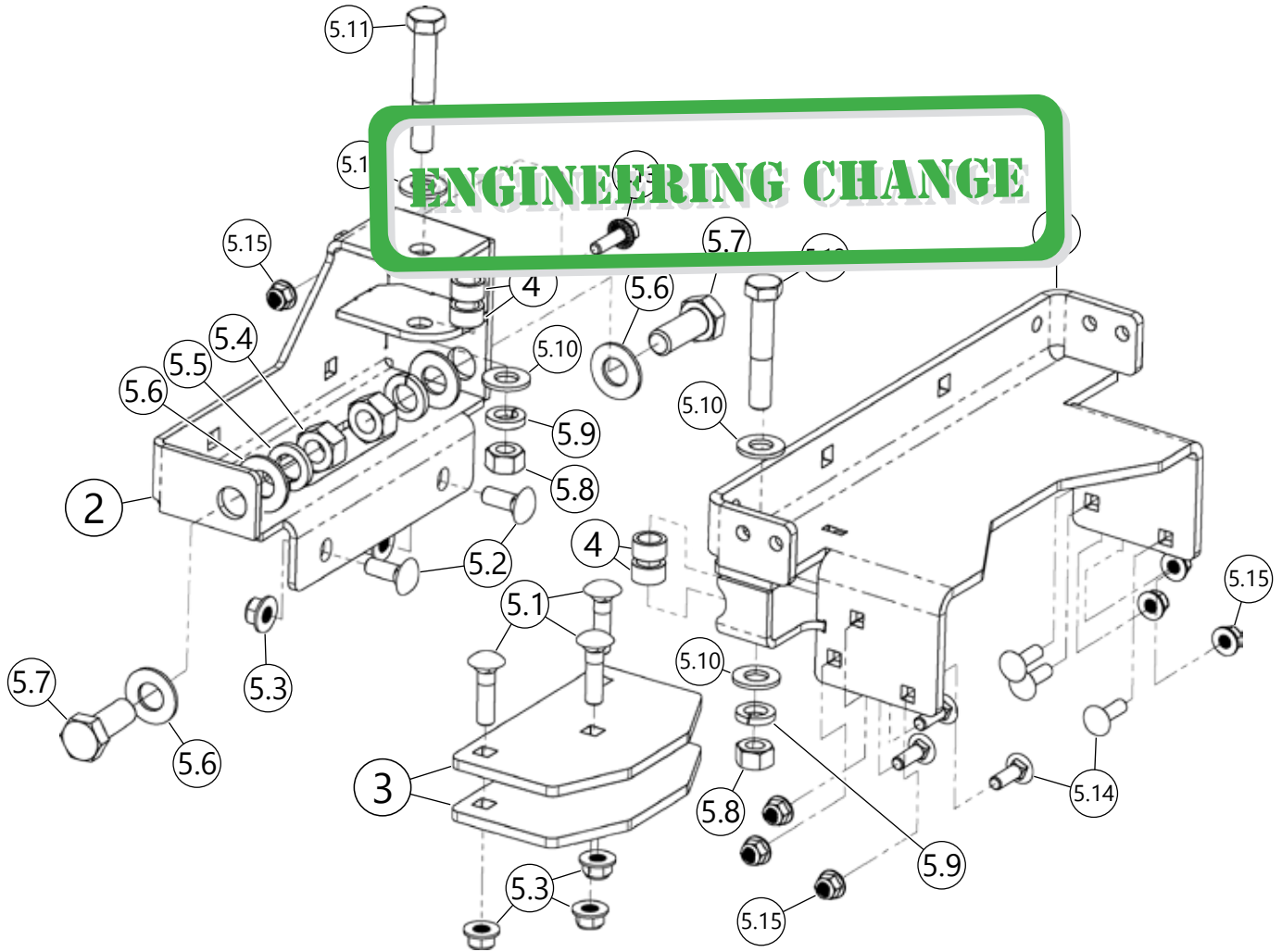

Item	P/N	Qty	Description
1	105901	1	Actuator Cradle Bracket
2	105897	1	Actuator Track Extension Bracket
3	106039	2	Actuator Safety Stop
4	105231	4	Bushing
5	HK-370	1	Hardware Kit
5.1	---	3	3/8"-16 X 1.50 Carriage Bolt
5.2	---	2	3/8"-16 X 1.00 Carriage Bolt
5.3	---	5	3/8"-16 Hex Flange Nylock Nut
5.4	---	2	5/8"-11 Hex Nut
4.5	---	2	5/8" Lock Washer

Item	P/N	Qty	Description
5.6	---	4	5/8" Flat Washer
5.7	---	2	5/8"-11 X 1.50 Hex Bolt
5.8	---	2	1/2"-13 Hex Nut
5.9	---	2	1/2" Lock Washer
5.10	---	4	1/2" Flat Washer
5.11	---	1	1/2"-13 X 3.00 Hex Bolt
5.12	---	1	1/2"-13 X 2.75 Hex Bolt
5.13	---	1	5/16"-18 X 1.00 Hex Flange Bolt
5.14	---	6	5/16"-18 X 1.00 Carriage Bolt
5.15	---	7	5/16"-18 Hex Flange Nylock Nut



INSTALLATION INSTRUCTIONS

Note: Make sure all hardware needed to complete this mount is in the package. Thoroughly read through and understand the instructions before installing.

Note: UTV plow track extension must be installed in the forward most position prior to the installation of this kit.

1. Pull up on lift latch handle (A) compressing spring (B) and remove the E-retaining clip (C) located under washer (D) as shown in **Figure 1**. Items (A,B,C, and D) can be discarded as they will not be reused.

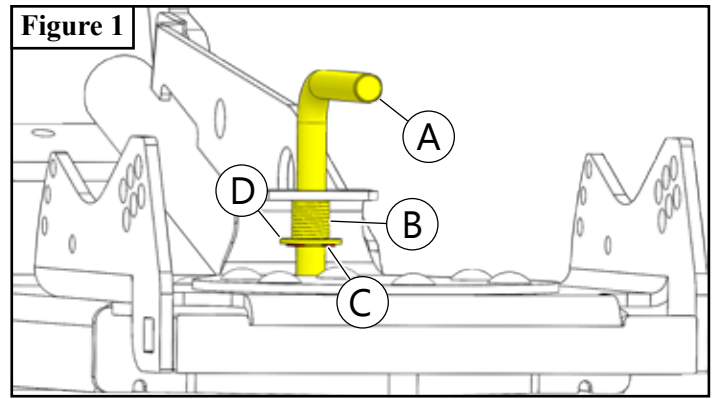

2. Remove plow springs if installed.

3. Remove and discard hardware (F). Remove Lift Hook Bracket (E) if installed as shown in **Figure 2** and set aside as it will be reused in a later step.

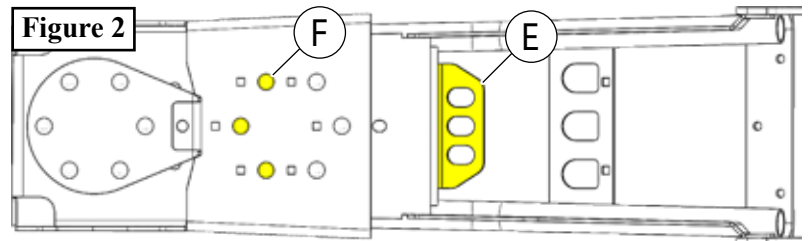

4. Hold Track Extension Bracket (2) in place and loosely secure both sides of bracket using bolts (5.7), flat washers (5.6), lock washers (5.5), and nuts (5.4) as shown in **Figure 3**.

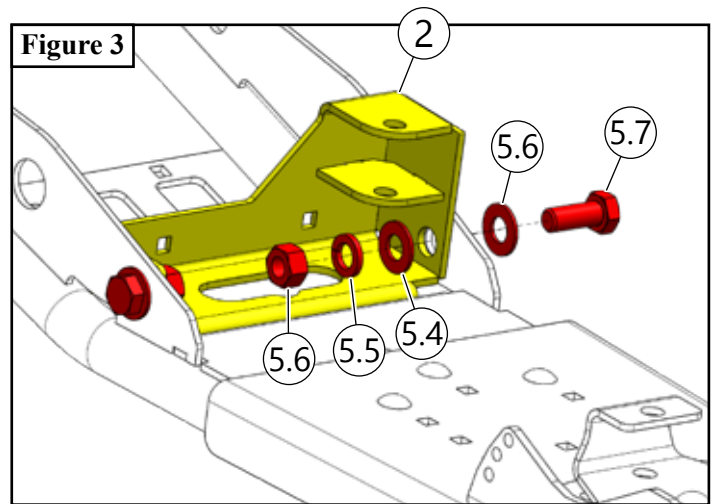

5. Secure bottom of Track Extension Bracket (2) using bolts (5.2) and nuts (5.3) as shown in **Figure 4**.

Note: Tighten hardware from steps 4 & 5 before starting step 6.

6. Using Track Extension Bracket (2) as a template, drill through the gusset of the push tubes using a 7/16" (.4375") drill bit as shown in **Figure 5**.

7. Secure Track Extension Bracket (2) using bolt (5.13) and nut (5.15) as shown in **Figure 5**.

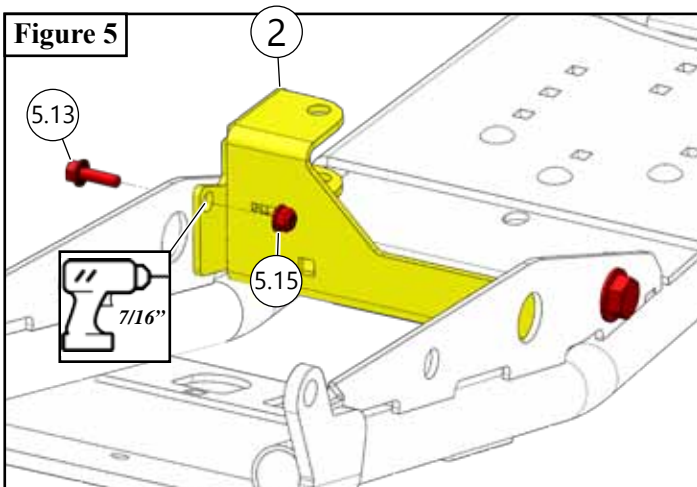
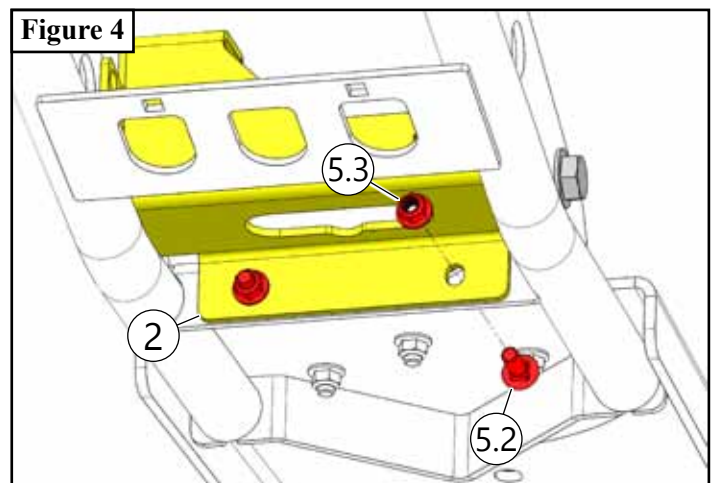

8. Set Actuator Safety Stops (3) in place lining up holes in Actuator Safety Stops with holes where bolts (F) were removed from step 3 as shown in **Figure 6**.

9. Secure Actuator Safety Stops using bolts (5.1) and nuts (5.3) as shown in **Figure 6**.

10. Set Actuator Cradle Bracket (1) in place and secure using bolts (5.14) and nuts (5.15) as shown in **Figure 7**.

11. Set actuator into Track Extension Bracket (2) with a Bushing (4) above and below the actuator as shown in **Figure 8**. Secure rear of actuator using Bolt (5.11), Flat Washers (5.10), Lock Washer (5.9), and Nut (5.8).

12. Set front of actuator into Cradle Bracket (1) with a Bushing (4) above and below the actuator rod heim joint as shown in **Figure 9**. Secure front of actuator using Bolt (5.12), Flat Washers (5.10), Lock Washer (5.9), and Nut (5.8).

Note: Periodically apply lubricant to actuator attachment points from steps 11 & 12.

13. Relocate plow spring from cradle to Actuator Cradle Bracket (1) as shown in **Figure 10**.

14. Reassemble Lift Hook Bracket (E) removed in step 2 onto one of the desired locations shown in **Figure 10**.

15. Tighten all hardware evenly.

