

POLARIS RANGER 1000

Plow Mount PART #106165

Kit Components:		
Item #	Qty.	Description
1	1	Plow Mount
2	1	Hardware Kit (HK-391)
2.1	4	3/8"-16 x 1.00 Hex Flange Bolt
2.2	4	3/8"-16 Hex Flange Nylock Nut
2.3	4	3/8"-16 Square Nut (not used)

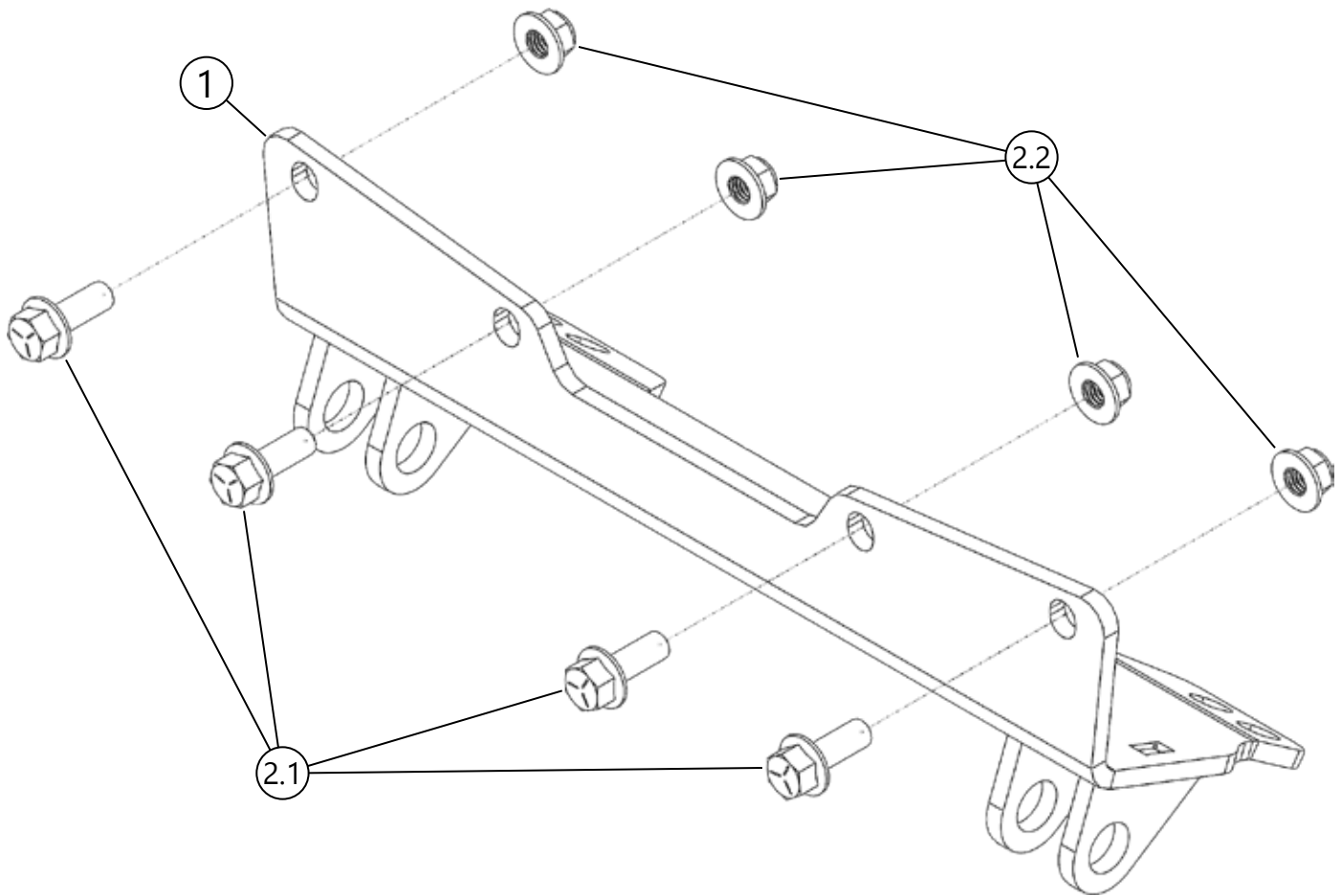

INSTALLATION INSTRUCTIONS

Note: Make sure all hardware needed to complete this mount is in the package. Thoroughly read through and understand the instructions before installing.

1. Remove OEM hardware (A) securing bottom of the front bumper as shown in **Figure 1 & 2**. *Note: Set hardware (A) aside as it will be reused in a later step.*
2. Set plow mount (1) in place and secure using OEM hardware (A) removed in step 1 as shown in **Figure 3**.
3. Using plow mount (1) as a template, drill holes (B) using a 7/16" drill bit as shown in **Figure 3**.
4. Secure top of plow mount (1) in locations (B) using bolts (2.1) and nuts (2.2) as shown in **Figure 4**.
5. Tighten all hardware evenly.

