

# INNER ACTUATOR BRACKET

Plow Accessory PART #106199-R Rev A

## Kit Components:

Item #	Qty.	Description
1	1	Inner Actuator Bracket
2	1	Hardware Kit HK-404
2.1	4	5/16"-18 X 1.00 Carriage Bolt Gr5
2.2	6	5/16"-18 X 1.25 Hex Bolt Flange Gr8 Serr
2.3	12	5/16"-18 Hex Nut Flange Nylock Gr5

**Note:** Make sure all hardware needed to complete this mount is in the package. Thoroughly read through and understand the instructions before installing.

## Installation Instructions

1. This kit comes with excess hardware. Only the hardware shown in **Figure 1** is needed. The extra hardware can be used to replace old hardware, or the extra can be discarded.
2. With the blade system connected to the machine, remove the springs from the Front Cradle Bracket by pushing out on the top of the blade, and removing the Pitch Bolts (A) from the cradle as shown in **Figure 2**. Once Pressure is relieved, remove the springs from the blade system.

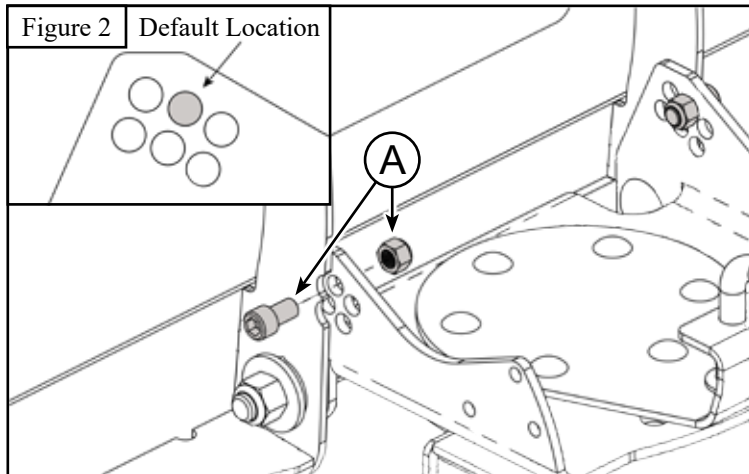
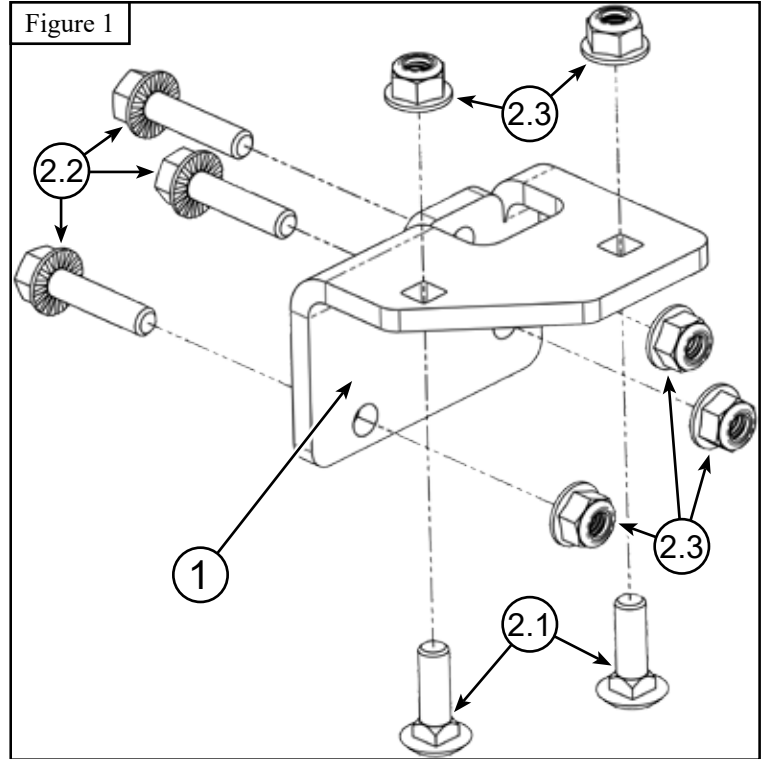

3. Remove the hardware (2.2) on the Right Side (Passenger Side) of the Front Actuator Bracket (B). See **Figure 3**.
4. Place the Inner Bracket (1) inside of the cradle as shown in **Figure 3**. Use Carriage Bolts (2.1) and Nuts (2.3) to connect the Inner bracket under the Actuator Bracket (B). Keep hardware loose.
5. Install Bolts (2.2) through the outside of the Front Actuator Bracket (B), Cradle, and Inner Bracket (1). Secure with Nuts (2.3). See **Figure 3**.
6. Tighten all hardware evenly.

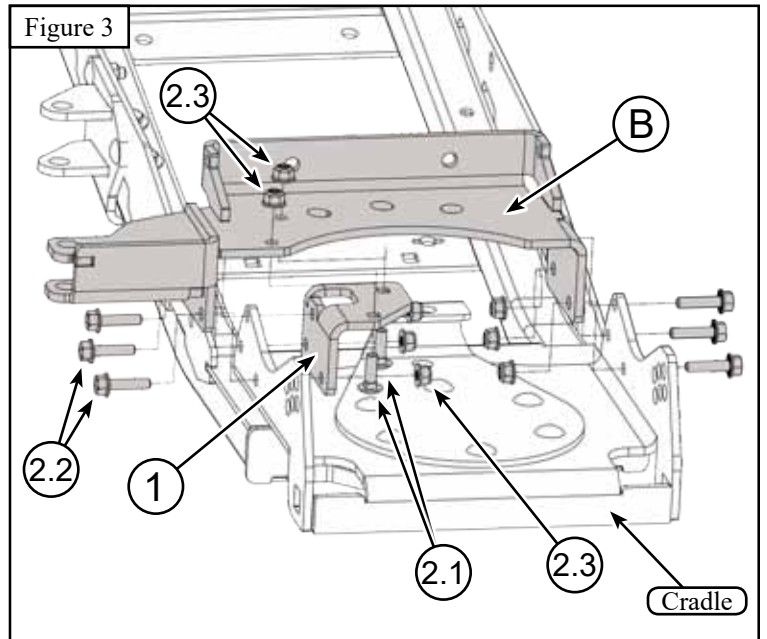

**NOTE:** Holes may need to be drilled for Carriage Bolts (2.1) if you have an old revision of the front bracket. Remove the Front Bracket (B) as shown in **Figure 3**, and insert Bolts (2.2) through the passenger side, through a 1/4" spacer, and through the Inner Bracket (1) for proper spacing. Use a punch and drill with 11/32" or 3/8" drill bit.

