

UTV V-PLOW TRACK EXTENSION

Plow Accessory

Part #106280 Rev. A

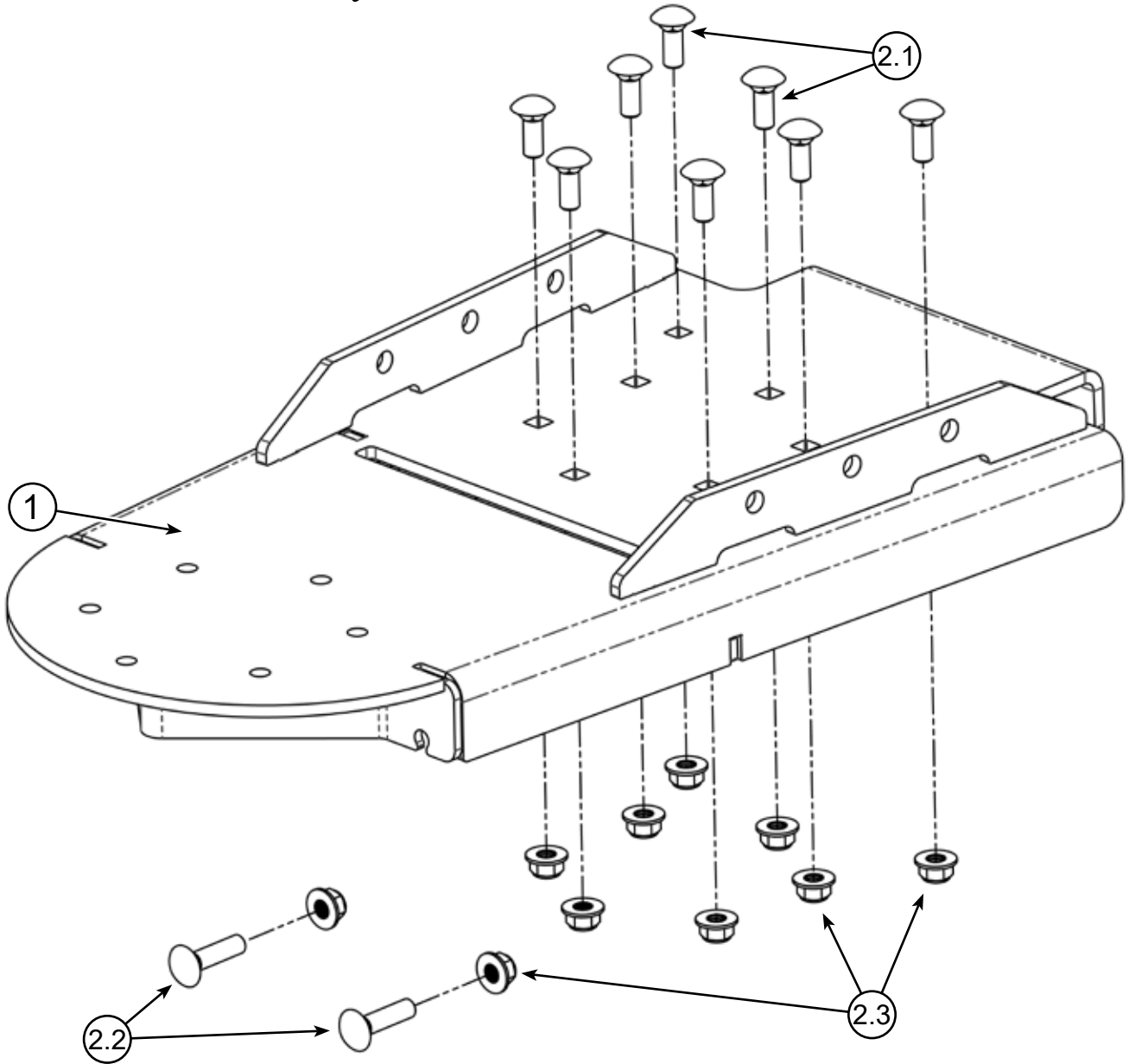

Kit Components:		
Item #	Qty.	Description
1	1	Track Extension Weldment (106281)
2	1	Hardware Kit HK-393
2.1	8	3/8"-16 x 1.00 Carriage Bolt GR5
2.2	2	3/8"-16 x 1.50 Carriage Bolt GR5
2.3	10	3/8"-16 Hex Nut Flange Nylock GR5



INSTALLATION INSTRUCTIONS

Note: Make sure all hardware needed to complete this mount is in the package. Thoroughly read through and understand the instructions before installing.

1. If you are converting an existing Pro-S or Pro-Poly Plow System, remove the Cradle Assembly and Lift Hook Bracket from the push tubes as shown in **Figure 1**. Discard all brackets and hardware removed in this step as they will not be reused.

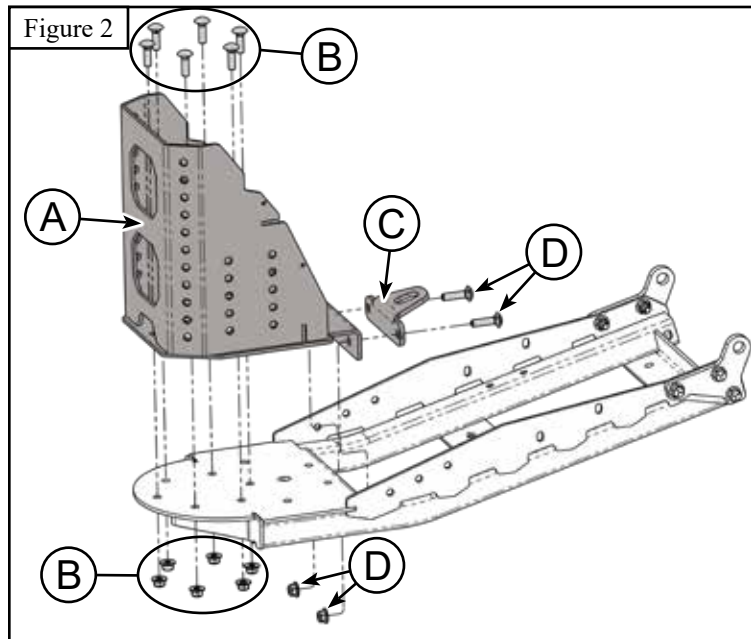
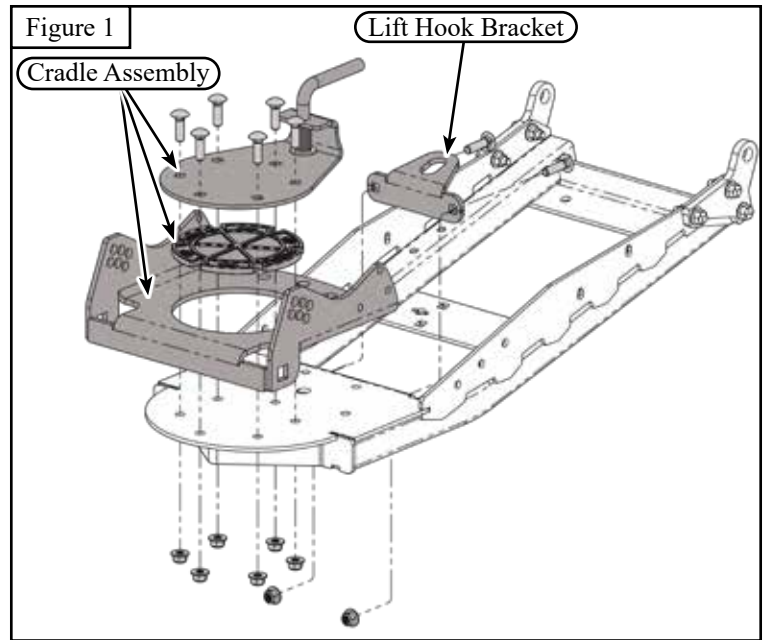

2. If you are installing the V-Plow Track Extension (1) onto an existing V-Plow System, remove the V-Plow Tube Center Pivot (A) with hardware (B) and Lift Hook Bracket (C) with Hardware (D) as shown in **Figure 2**. Save all hardware and brackets from this step for later reinstallation.

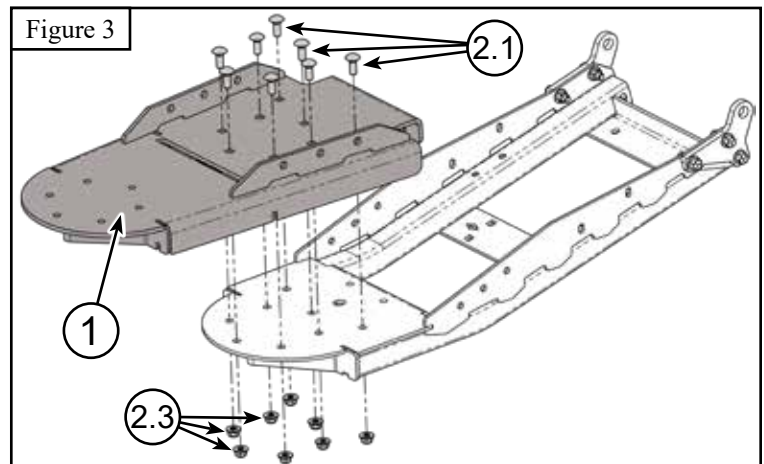

3. Once the Push Tube Bulkhead is disassembled, or if you are starting with a Push Tube Weldment, Install V-Plow Track Extension (1) using Bolts (2.1) and Nuts (2.3) as shown in **Figure 3**. Leave hardware loose.

4. Install the V-Plow Tube Center Pivot (A) onto the Track Extension (1) as shown in **Figure 4**. Leave Hardware (B) Loose.

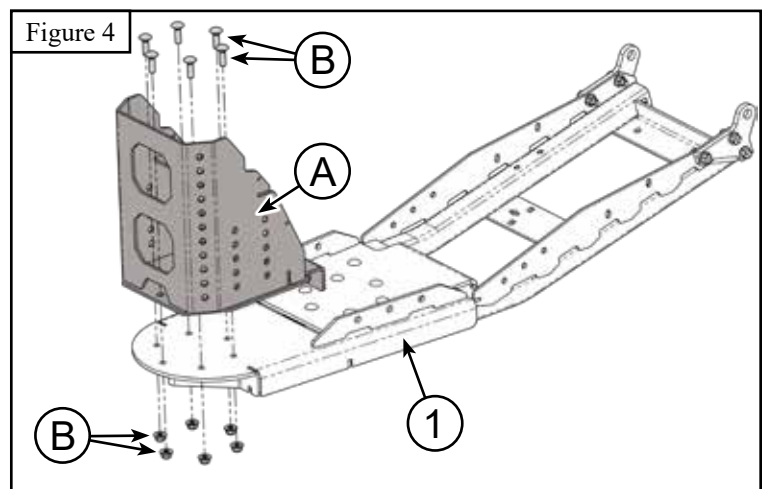

INSTALLATION INSTRUCTIONS

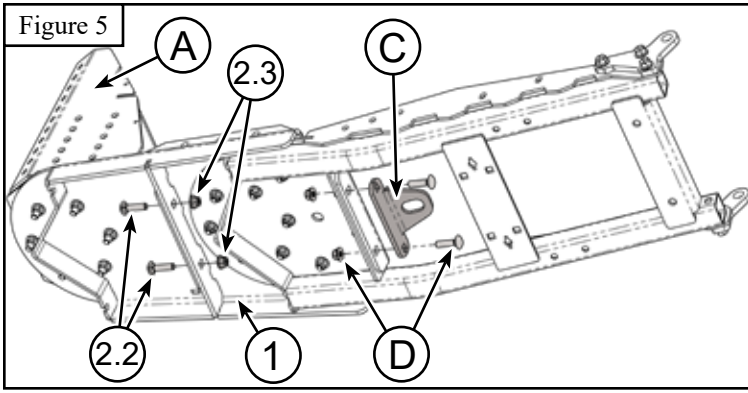

5. Use bolts (2.2) and nuts (2.3) to connect the Track Extension (1) and V-Plow Tube Center Pivot (A) as shown in **Figure 5**. Attach the Lift Hook Bracket (C) in it's original location with original hardware (D). Leave hardware loose.

Note: If you have a winch mounted high on your machine, an alternate lift hook location can be used as shown in **Figure 7**. If you relocate the Hook Bracket (C), Hardware (D) must be moved with it. See **Figure 6**.

6. Tighten all harware evenly

