

# HYDRAULIC PLOW ACTUATOR BRACKETS

Plow Accessory

PART #106305 Rev. C

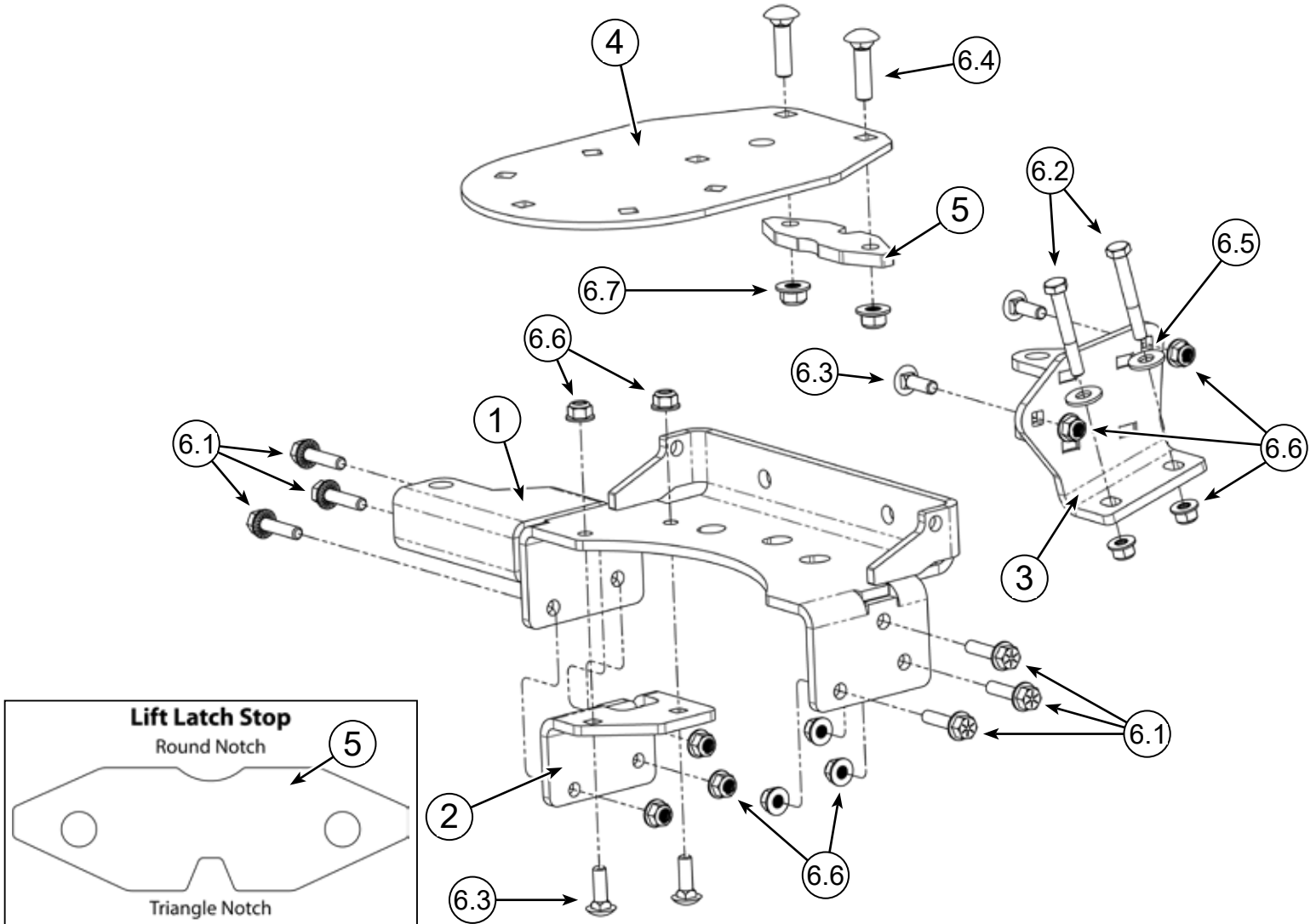

Item #	Qty.	Description
1	1	Cradle Bracket
2	1	Backer Plate
3	1	Rear Tube Bracket
4	1	Flat Cradle Keeper
5	1	Lift Latch Stop
6	1	Hardware Kit (HK-404)

Item #	Qty.	Description
6.1	6	5/16"-18 X 1.25 Hex Flange Bolt GR8
6.2	2	5/16"-18 X 2.25 Hex Bolts GR5
6.3	4	5/16"-18 X 1.00 Carriage Bolts GR5
6.4	2	3/8"-16 X 1.5" Carriage Bolt GR5
6.5	2	5/16" Flat Washer
6.6	12	5/16"-18 Hex Flange Lock Nut
6.7	2	3/8"-16 Hex Nut Flange Nylock GR5



# BRACKET INSTALLATION INSTRUCTIONS

**Note:** Make sure all hardware needed to complete this mount is in the package. Thoroughly read through and understand the instructions before installing.

1. Remove both Plow Springs if installed. Set aside as they will be reinstalled later.
2. Remove the original Lift Lock Latch (C) by removing the 6 Bolts (A) and 6 Nuts (B) as shown in **Figure 2**.

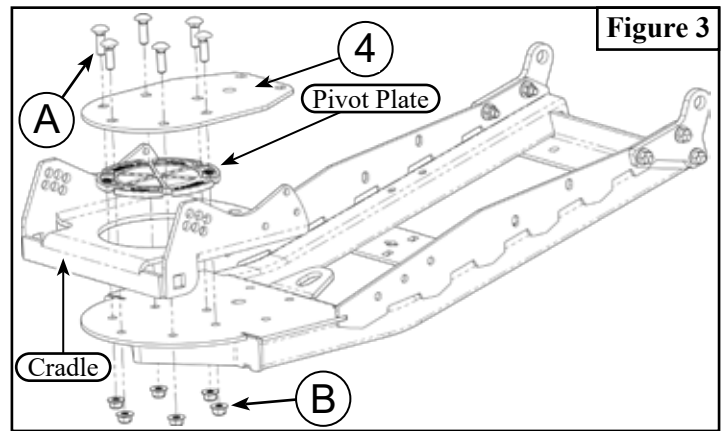
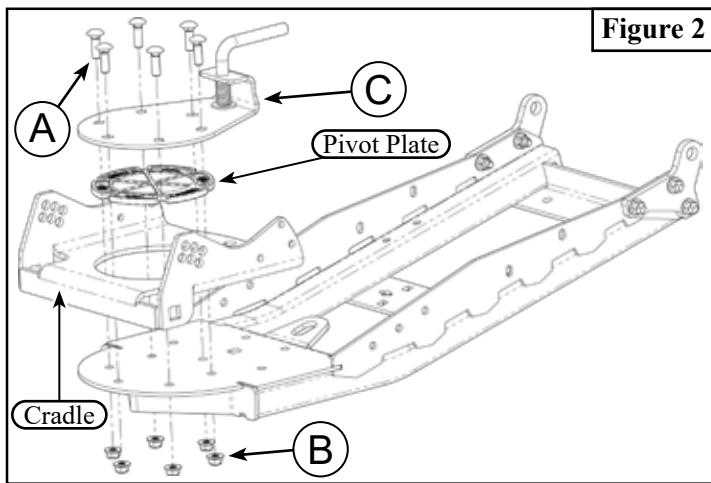
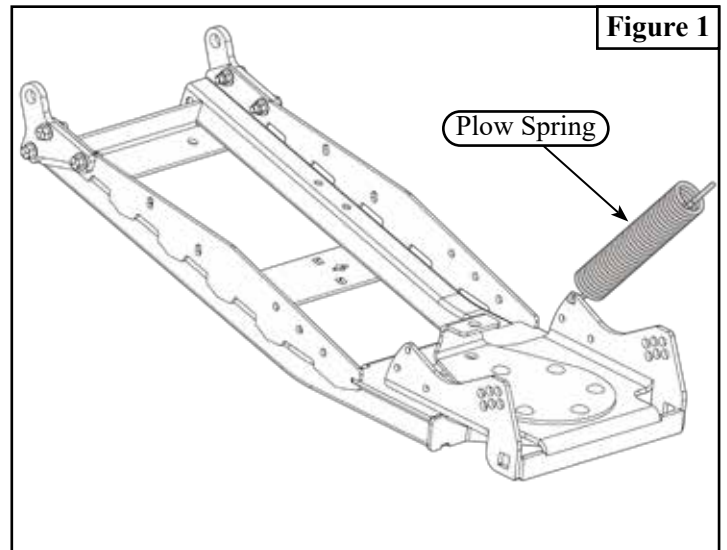

3. Install the Flat Cradle Keeper (4) using the same 6 Bolts (A) and 6 Nuts (B) as shown in **Figure 3**. If drilling is required as shown in **Figure 4**, tighten the 6 bolts (A) evenly. If these rear holes exist through all components, leave Cradle Keeper (4) loose and skip to step 5. \*Do not overtighten Bolts (A) or it may become difficult to rotate the blade.\*
4. If drilling is required for the rear-most bolts in the Cradle Keeper (4), use the Cradle Keeper as a template to drill through the push tube bulkhead with a 13/32" drill bit as shown in **Figure 4**.

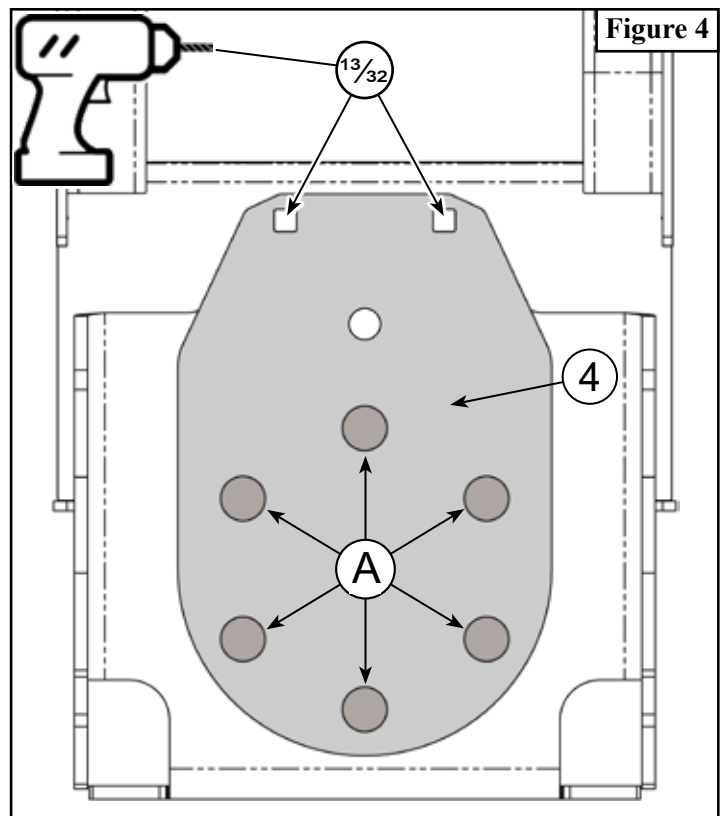

# BRACKET INSTALLATION INSTRUCTIONS

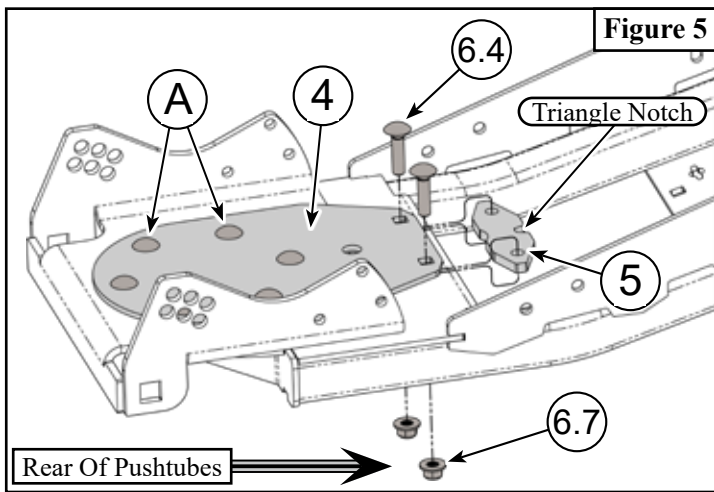

5. Once your rear holes are drilled, loosen the 6 bolts (A) to install the Lift Latch Stop (5) between the Flat Cradle Keeper (4) and push tube bulkhead. **The triangle notch in the Lift Latch Stop (5) should be oriented towards the rear of the pushtubes (front of the machine).** Secure components with Bolts (6.4) and Nuts (6.7). See **Figure 5**.

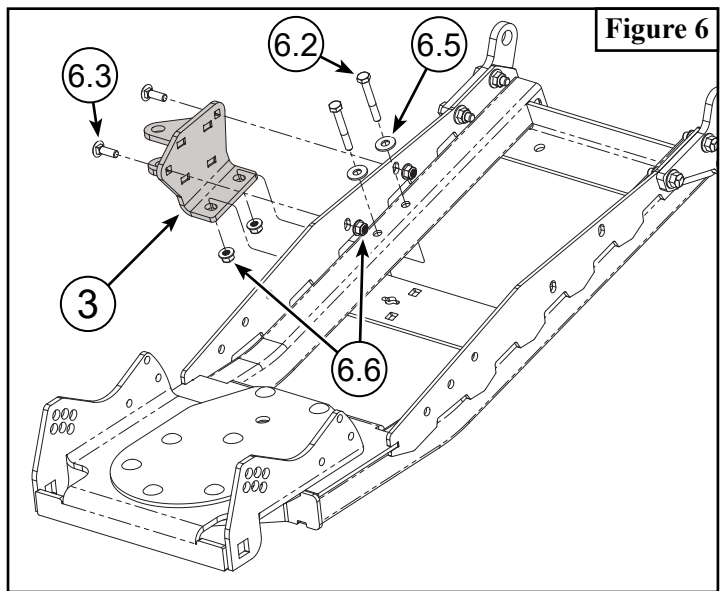

6. Attach Rear Tube Bracket (3) to the push tube using Bolts (6.2 & 6.3) and Nuts (6.6). Place bolts (6.2) through washers (6.5) before placing through the push tubes. As shown in **Figure 6**.

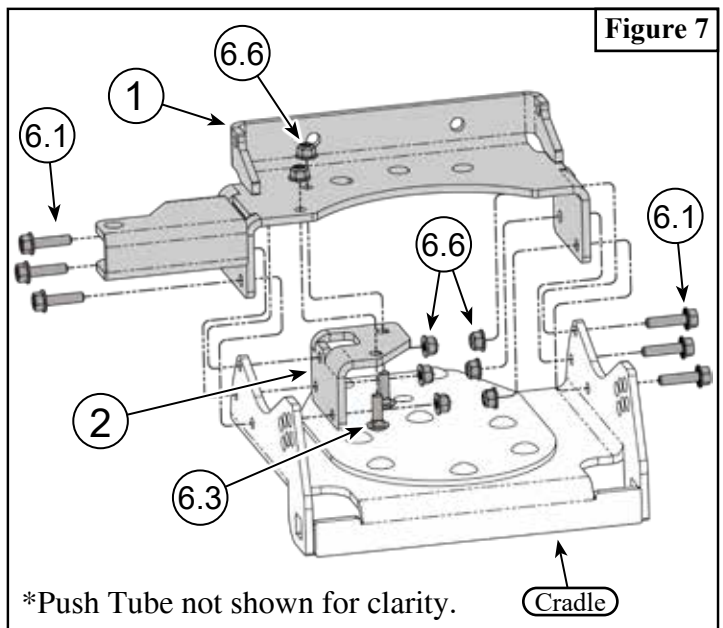

7. Loosely assemble Backer Plate (2) to the Cradle Bracket (1), using Carriage Bolts (6.3) and Lock Nuts (6.6), as shown in **Figure 7**.

8. Place Cradle Bracket (1) over the Cradle and attach with Bolts (6.1) and Lock Nuts (6.6), as shown in **Figure 7**.

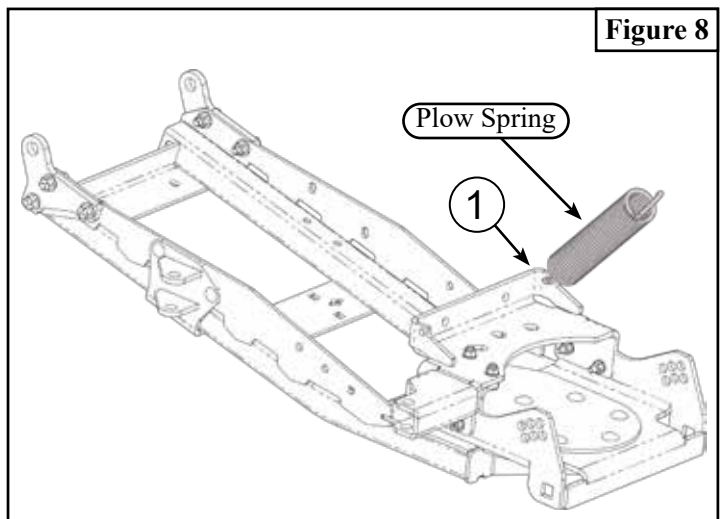

9. Tighten all hardware evenly.

10. Springs will attach to the bent flange on the Cradle Bracket (1). As shown in **Figure 8**.

# ACTUATOR INSTALLATION INSTRUCTIONS

Note: Actuator is not included with this kit. Items below come with kit #ACT203

Item #	Qty.	Description
7	1	Actuator
8	1	Hardware Kit HK-381
8.1	2	M14-2.00 X 80 Hex Bolts GR8.8
8.2	12	M14 Flat Washer
8.3	2	M14 X 2.00 Hex Lock Nut

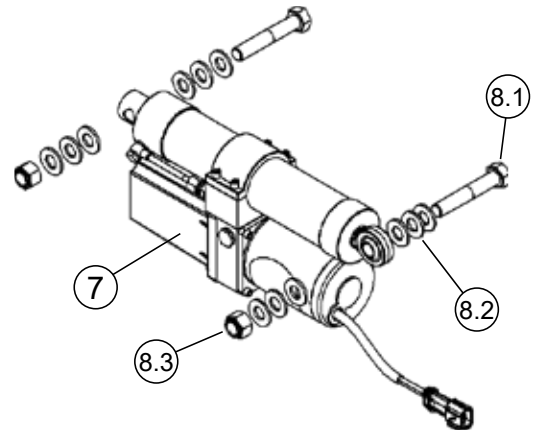

## INSTALLATION INSTRUCTIONS

- Place bolt (8.1) through flat washer (8.2), top tab of rear actuator bracket, flat washer (8.2), Hydraulic Actuator (7), flat washer (8.2), bottom tab of rear actuator bracket, and flat washer (8.2). Place nylock nut (8.3) onto bolt (8.1) as shown in Figure 9. (This orientation of hardware is just a guideline)

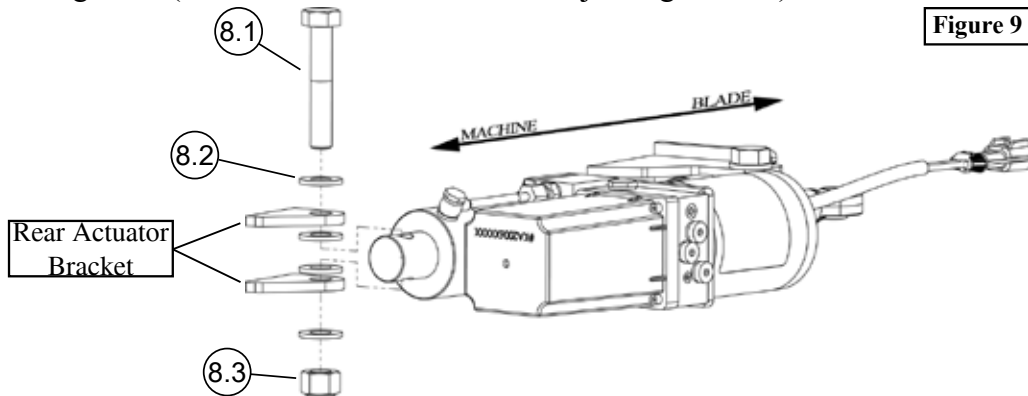

Figure 9

- Repeat previous step for mounting the front half of the actuator, as shown in Figure 10. It is most important that you use the washers to make sure that the actuator is parallel to the cradle swivel point, as shown in Figure 11. Both front, and rear bolts should not be tight, thread the nut on until Nylock is engaged.

**Note:** Periodically apply lubricant to actuator attachment points.

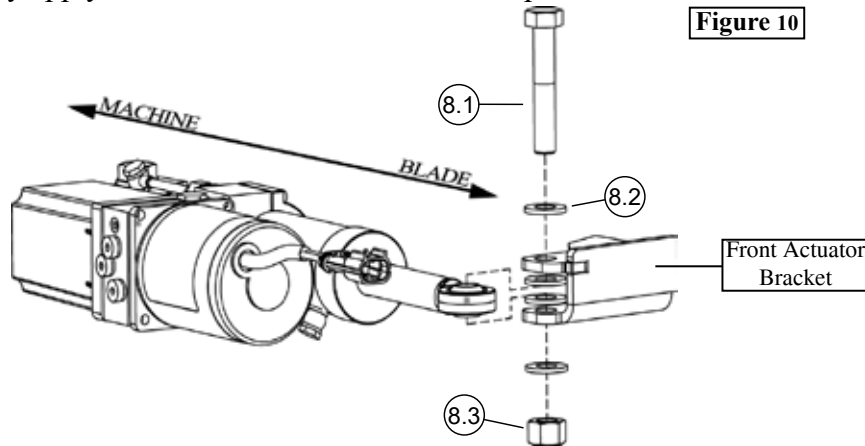

Figure 10

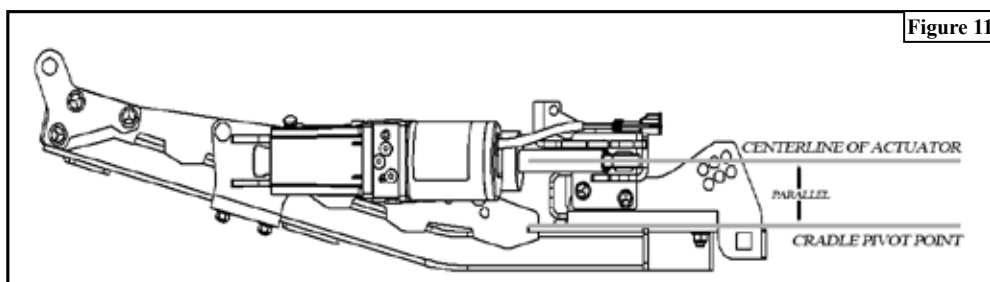

Figure 11