

# UTV PRO 2.0 TRACK EXTENSION ACTUATOR BRACKET

Plow Accessory

PART #106335 Rev. B

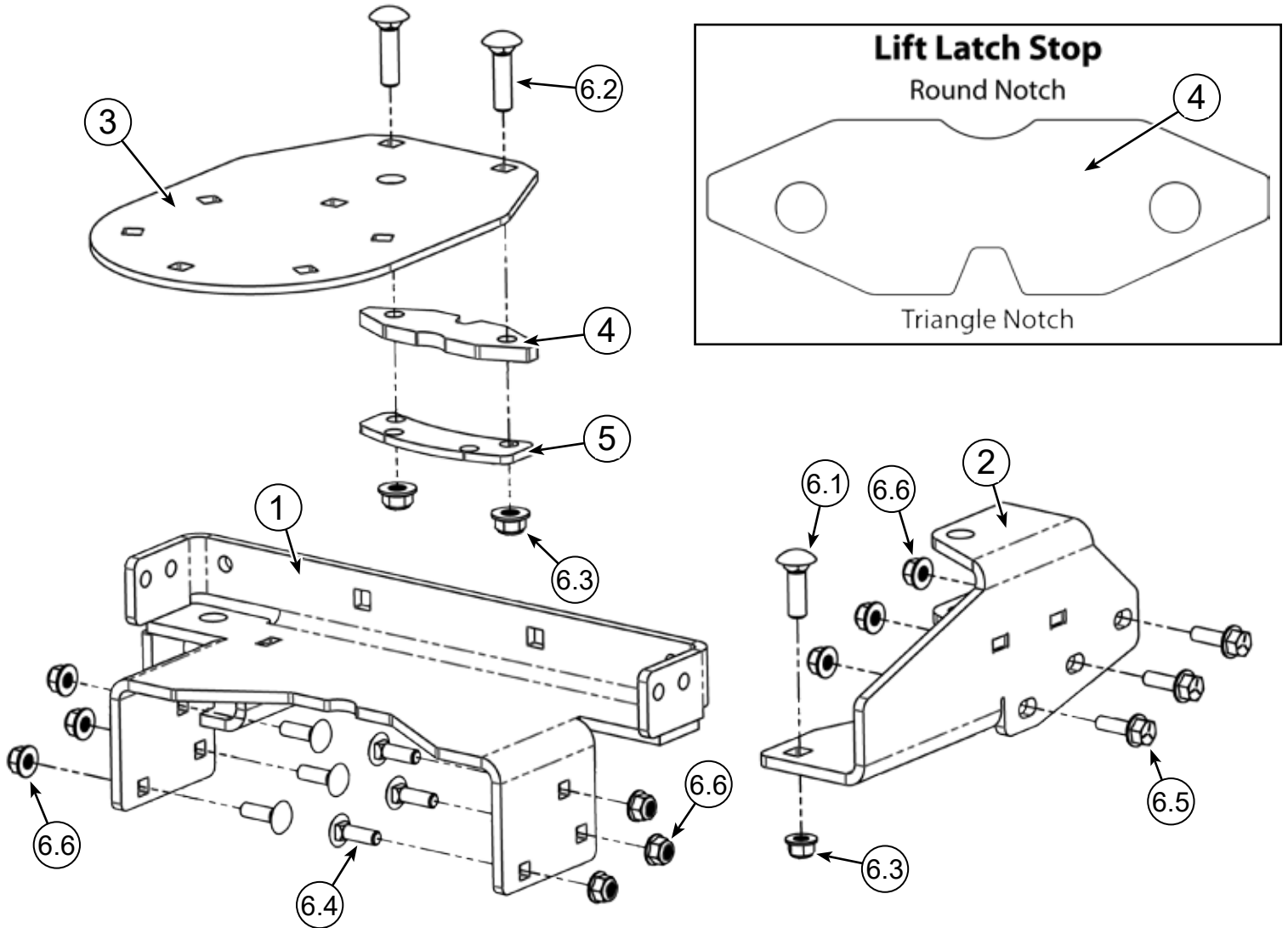

Item #	Qty.	Description
1	1	Actuator Cradle Bracket
2	1	Rear Actuator Bracket
3	1	Flat Cradle Keeper
4	1	Lift Latch Stop
5	1	Track Extension Spacer
6	1	Hardware Kit (HK-406)

Item #	Qty.	Description
6.1	1	3/8"-16 x 1.25 Carriage Bolt GR5
6.2	3	3/8"-16 x 1.50 Carriage Bolt GR5 -1 NOT USED
6.3	4	3/8"-16 Hex Flange Nylock Nut -1 NOT USED
6.4	6	5/16"-18 x 1.00 Carriage Bolt GR5
6.5	3	5/16"-18 x 1.00 Hex Flange Bolt GR5
6.6	9	5/16"-18 Hex Flange Nylock Nut



# INSTALLATION INSTRUCTIONS

**Note:** Make sure all hardware needed to complete this mount is in the package. Thoroughly read through and understand the instructions before installing.

**Note:** This kit requires UTV Track Extension Kit #106330 (Sold Separately) to be installed prior to installing the Track Extension Actuator Brackets.

1. Remove both Plow Springs if installed. Set aside as they will be reinstalled later.

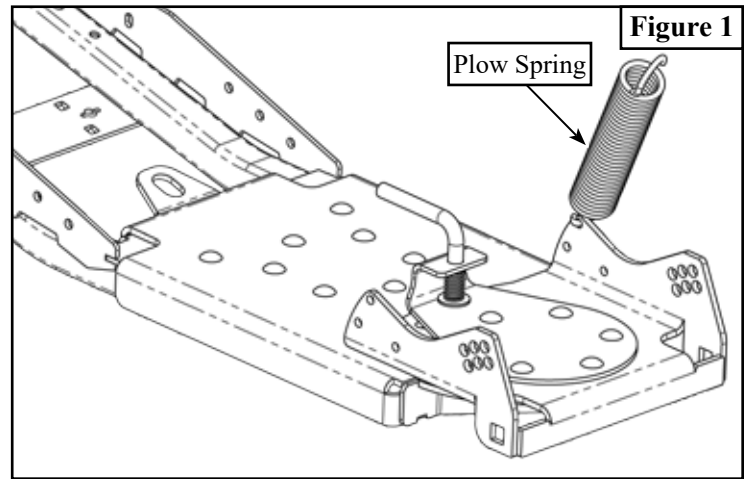

2. Remove the original Lift Lock Latch (C) by removing the 6 Bolts (A) and 6 Nuts (B) as shown in **Figure 2**. Bolt (D) can be removed and discarded.

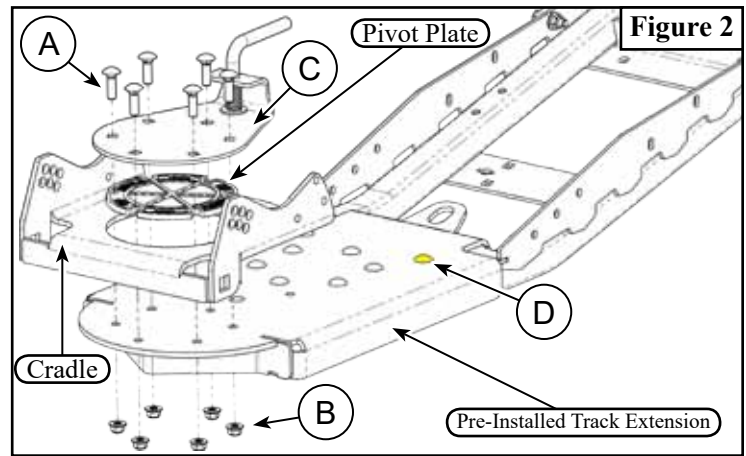

3. Install the Flat Cradle Keeper (3) using the same 6 Bolts (A) and 6 Nuts (B) as shown in **Figure 3**. If drilling is required as shown in **Figure 4**, tighten the 6 bolts (A) evenly. If these rear holes exist through all components, leave Cradle Keeper (3) loose and skip to step 5. \*Do not overtighten Bolts (A) or it may become difficult to rotate the blade.\*

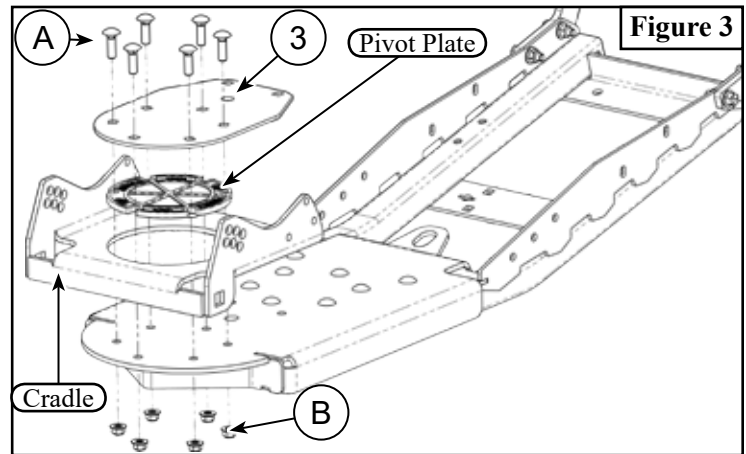

4. If drilling is required for the rear-most bolts in the Cradle Keeper (3), use the Cradle Keeper as a template to drill through the track extension and push tubes with a 13/32" drill bit as shown in **Figure 4**.

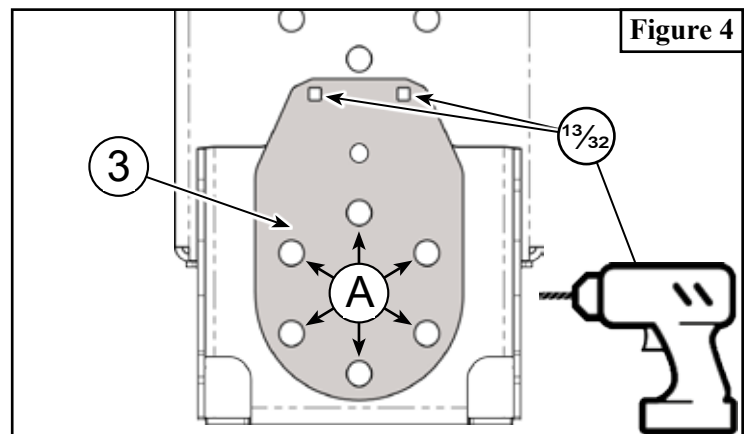

5. Once your rear holes are drilled, loosen the 6 bolts (A) to install the Lift Latch Stop (4) between the Flat Cradle Keeper (3) and track extension. **The triangle notch in the Lift Latch Stop (4) should be oriented towards the rear of the pushtubes (front of the machine).** See **Figure 5**. (Next Page)

# INSTALLATION INSTRUCTIONS

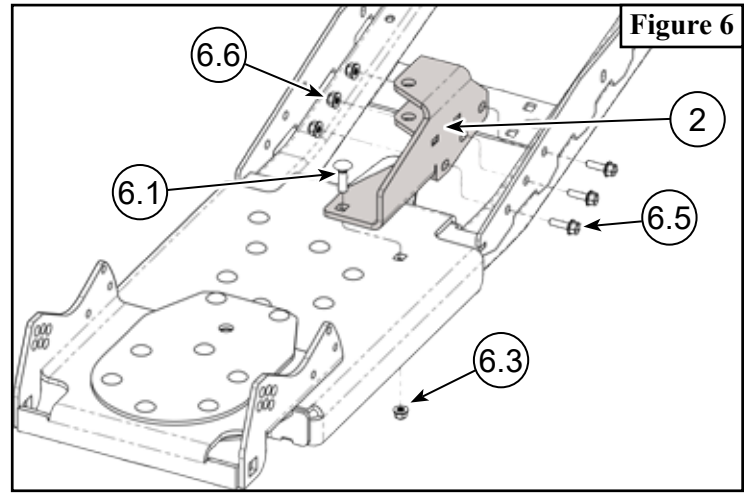
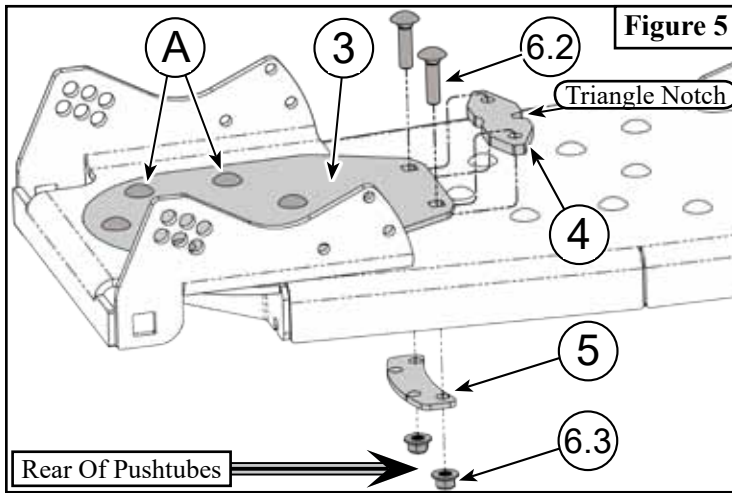

6. Install the Track Extension Spacer (5) under the track extension. This component should follow the contour of the push tube bulkhead, as shown in **Figure 5**. Secure all components from steps 5 and 6 with Bolts (6.2) and Nuts (6.3)

7. Set Rear Actuator Bracket (2) in place and loosely secure using Bolts (6.1, 6.5) and nuts (6.3, 6.6) as shown in **Figure 6**.

8. Set Actuator Cradle Bracket (1) inside of the cradle and loosely secure using Bolts (6.4) and Nuts (6.6) as shown in **Figure 7**.

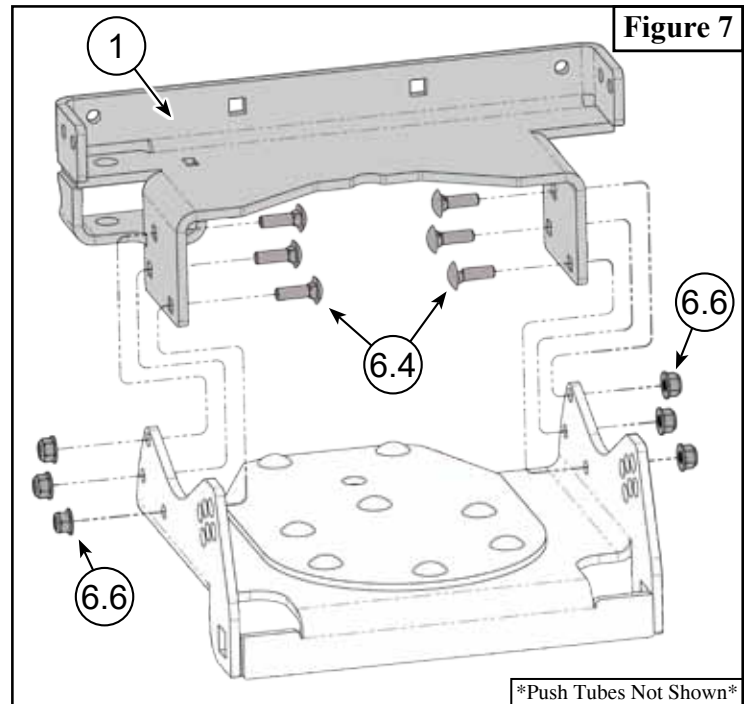

9. Tighten all hardware evenly

10. Plow Springs will attach to the front cradle bracket (1). The rear most hole is the stock position, as shown in **Figure 8**.

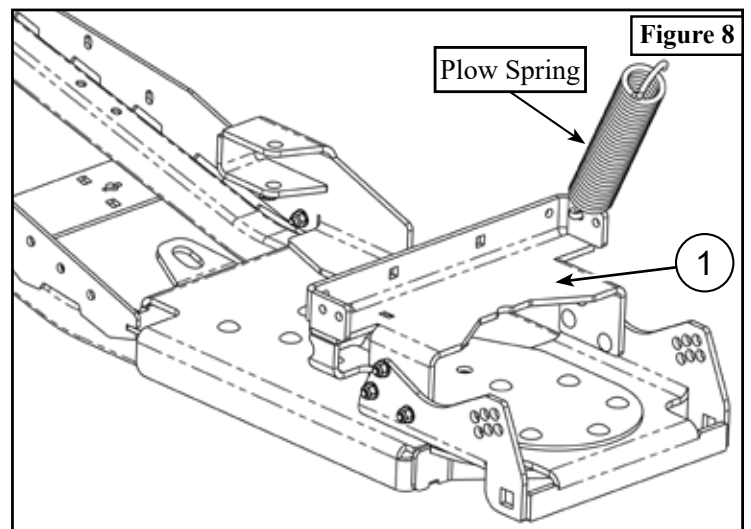

# ACTUATOR INSTALLATION INSTRUCTIONS

Note: Actuator is not included with this kit. Items below come with kit #ACT203

Item #	Qty.	Description
7	1	Actuator
8	1	Hardware Kit HK-381
8.1	2	M14-2.00 X 80 Hex Bolts GR8.8
8.2	12	M14 Flat Washer
8.3	2	M14 X 2.00 Hex Lock Nut

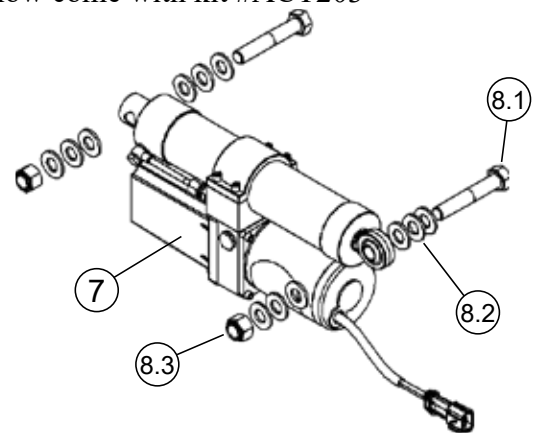

## INSTALLATION INSTRUCTIONS

- Place bolt (8.1) through flat washer (8.2), top tab of rear actuator bracket, flat washer (8.2), Hydraulic Actuator (7), flat washer (8.2), bottom tab of rear actuator bracket, and flat washer (8.2). Place nylock nut (8.3) onto bolt (8.1) as shown in **Figure 9**. (This orientation of hardware is just a guideline)

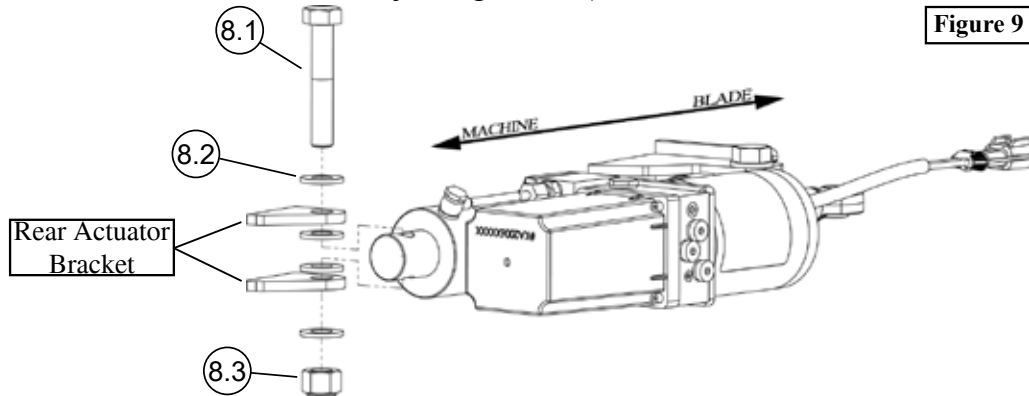

Figure 9

- Repeat previous step for mounting the front half of the actuator, as shown in **Figure 10**. It is most important that you use the washers to make sure that the actuator is parallel to the cradle swivel point, as shown in **Figure 11**. Both front, and rear bolts should not be tight, thread the nut on until Nylock is fully engaged.

**Note:** Periodically apply lubricant to actuator attachment points.

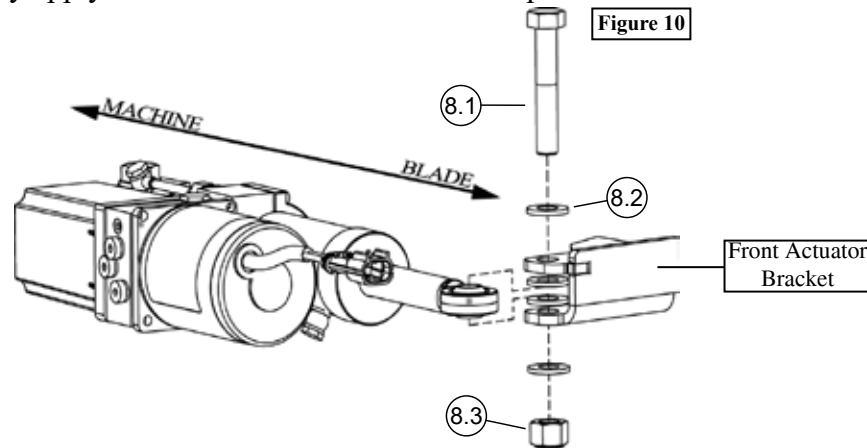

Figure 10

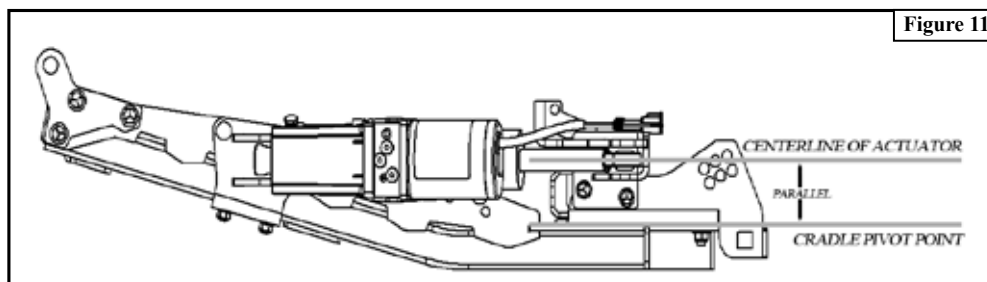

Figure 11