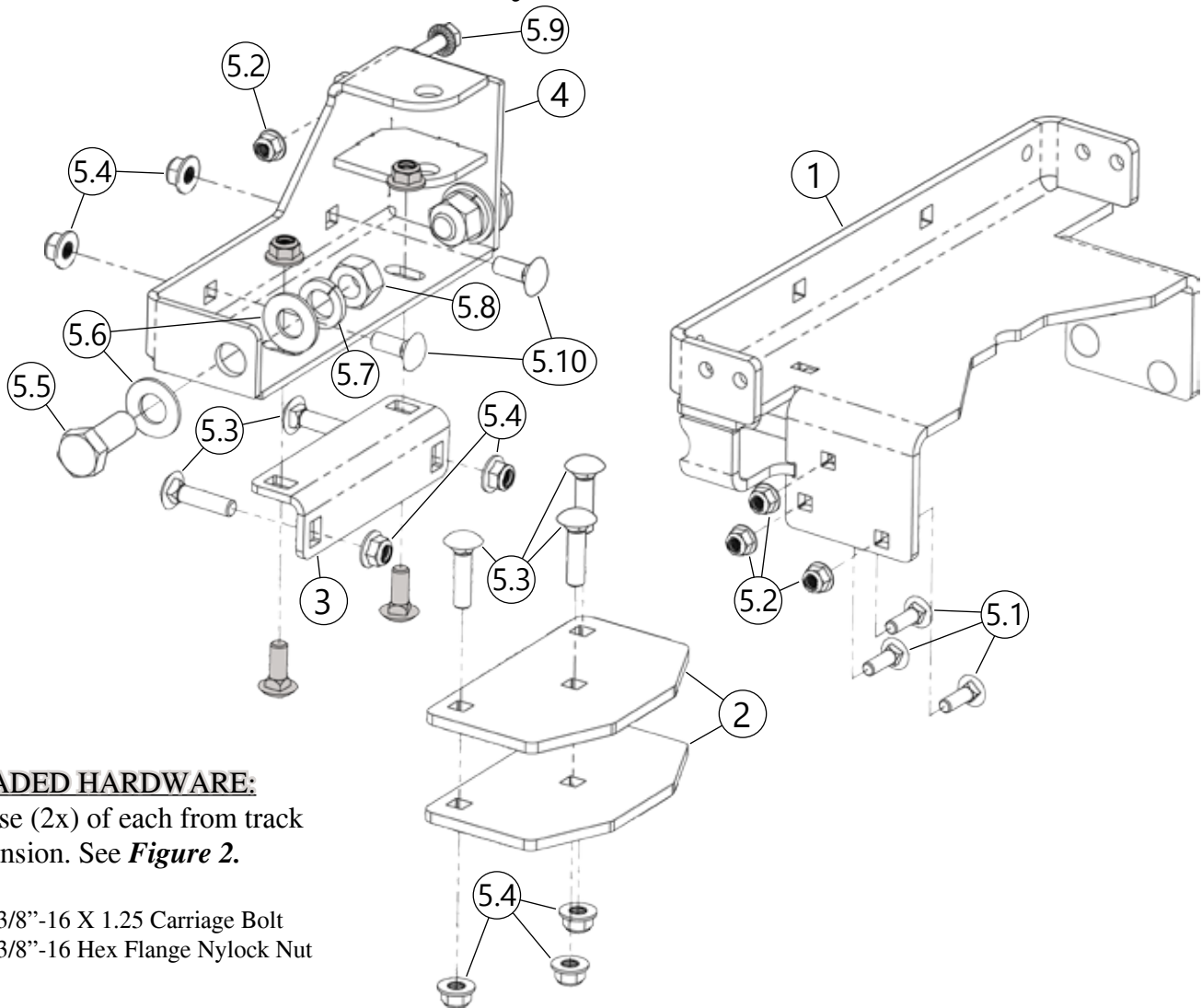


# TRACK EXTENSION

## HYDRAULIC ACTUATOR BRACKET

Plow Accessory

PART #106430



### SHADED HARDWARE:

Reuse (2x) of each from track extension. See **Figure 2**.

2x - 3/8\"-16 X 1.25 Carriage Bolt  
2x - 3/8\"-16 Hex Flange Nylock Nut

Item	P/N	Qty	Description
1	105901	1	Actuator Cradle Bracket
2	106039	2	Actuator Safety Stop
3	106433	1	Actuator Track Extension Gusset
4	106431	1	Actuator Track Extension Bracket
5	HK-370	1	Hardware Kit
5.1	---	6	5/16\"-18 X 1.00 Carriage Bolt
5.2	---	7	5/16\"-18 Hex Flange Nylock Nut
5.3	---	5	3/8\"-16 X 1.50 Carriage Bolt

Item	P/N	Qty	Description
5.4	---	7	3/8\"-16 Hex Flange Nylock Nut
5.5	---	2	5/8\"-11 X 1.50 Hex Bolt
5.6	---	4	5/8\" Flat Washer
5.7	---	2	5/8\" Lock Washer
5.8	---	2	5/8\"-11 Hex Nut
5.9	---	1	5/16\"-18 X 1.00 Hex Flange Bolt
5.10	---	2	3/8\"-16 X 1.00 Carriage Bolt

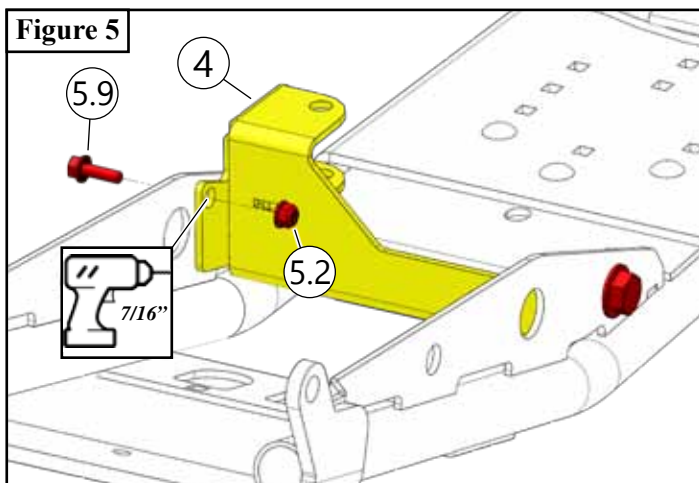
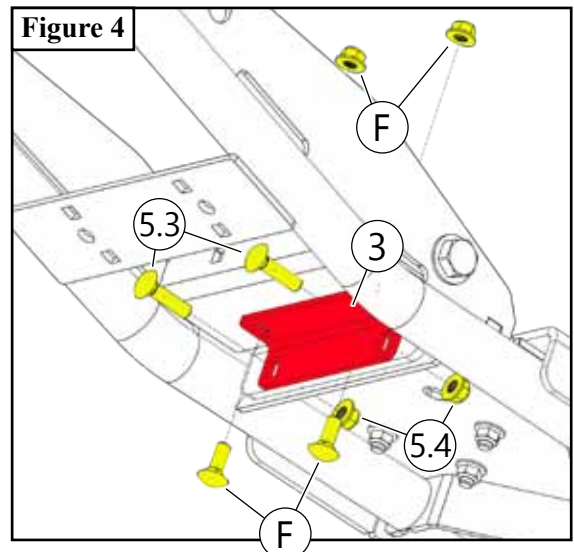
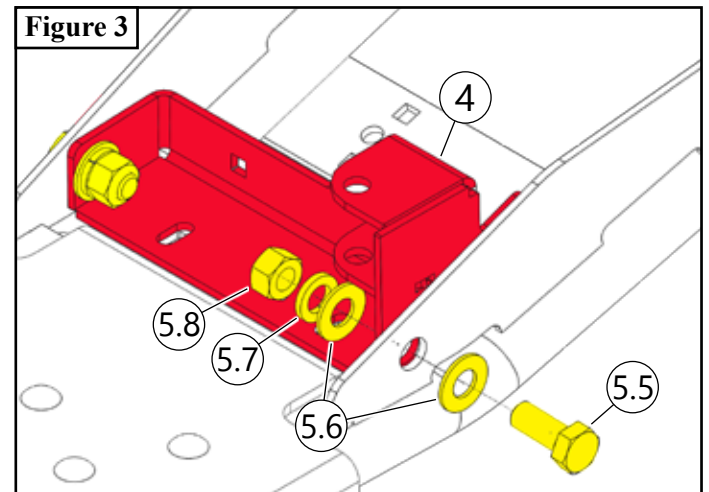
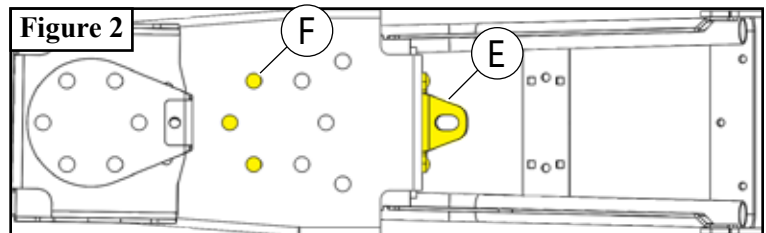
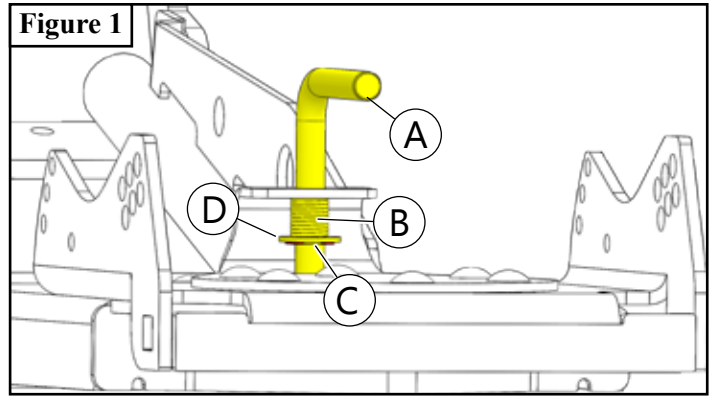


# INSTALLATION INSTRUCTIONS

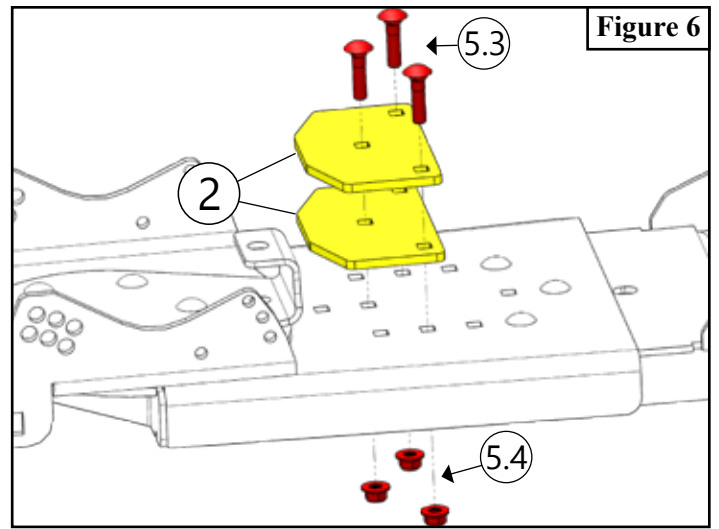
**Note:** Make sure all hardware needed to complete this mount is in the package. Thoroughly read through and understand the instructions before installing.

**Note:** UTV plow track extension must be installed in the forward most position prior to the installation of this kit.

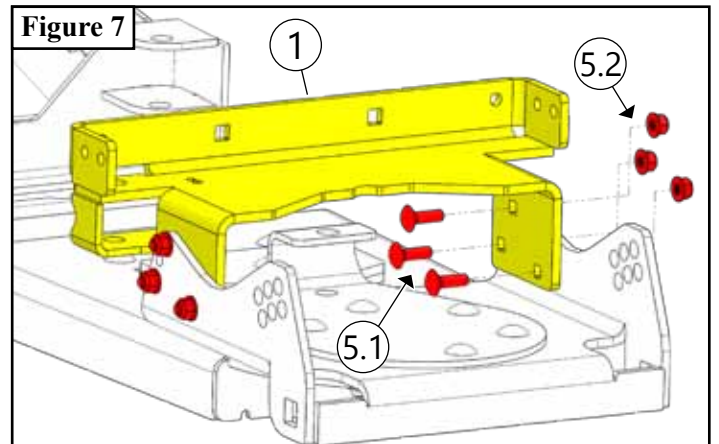
1. Pull up on lift latch handle (A) compressing spring (B) and remove the E-retaining clip (C) located under washer (D) as shown in **Figure 1**. Items (A,B,C, and D) can be discarded as they will not be reused.
2. Remove plow springs if installed.
3. Remove (3x) hardware (F) from track extension. Two of each nut and bolt will be used in Step 5. Remove Lift Hook Bracket (E) if installed as shown in **Figure 2** and set aside for use in Step 14.
4. Hold Track Extension Bracket (4) in place and loosely secure both sides of bracket using bolts (5.5), flat washers (5.6), lock washers (5.7), and nuts (5.8) as shown in **Figure 3**.
5. Install Extension Gusset (3) using bolts (5.3), nuts (5.4), and hardware (F) as shown in **Figure 4**.  
**Note:** Tighten hardware from steps 4 & 5 before starting step 6.
6. Using Track Extension Bracket (4) as a template, drill through the gusset of the push tubes using a 7/16" (.4375") drill bit as shown in **Figure 5**.
7. Secure Track Extension Bracket (4) using bolt (5.9) and nut (5.2) as shown in **Figure 5**.



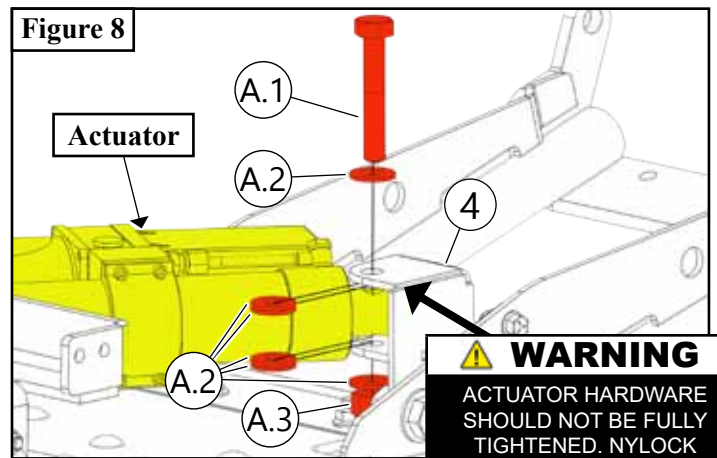
8. Set Actuator Safety Stops (2) in place lining up holes in Actuator Safety Stops with holes where bolts (F) were removed from Step 3 as shown in **Figure 6**.
  9. Secure Actuator Safety Stops using bolts (5.3) and nuts (5.4) as shown in **Figure 6**.
  10. Set Actuator Cradle Bracket (1) in place and secure using bolts (5.1) and nuts (5.2) as shown in **Figure 7**.
  11. Set actuator into Track Extension Bracket (4) and install using hardware supplied with actuator. See **ACTUATOR HARDWARE** and **WARNING**. Loosely (allowing play) secure bolt (A.1), six washers (A.2), and nut (A.3). See **Figure 8**.
  12. Set front of actuator into Cradle Bracket (1) like shown in **Figure 9**. Loosely (allowing play) secure front of actuator using bolt (A.1), six washers (A.2), and nut (A.3).
- Note:** Periodically apply lubricant to actuator attachment points from steps 11 & 12.
13. Relocate plow springs from cradle to Actuator Cradle Bracket (1) as shown in **Figure 10**.
  14. Reassemble Lift Hook Bracket (E) removed in Step 2 onto one of the desired locations shown in **Figure 10**, using bolts (5.10) and nuts (5.4). Bolts and nuts also shown in **EXP VIEW** on Page 1.



**Figure 6**

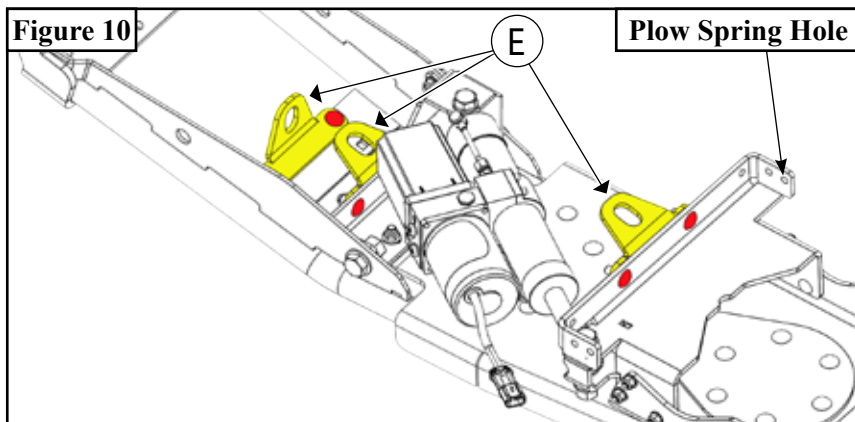


**Figure 7**

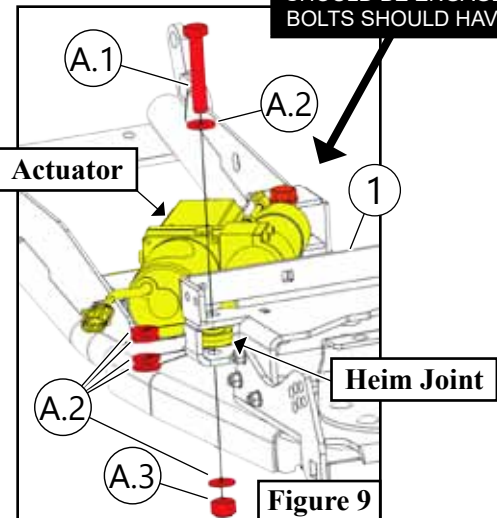


**Figure 8**

**WARNING**  
ACTUATOR HARDWARE SHOULD NOT BE FULLY TIGHTENED. NYLOCK SHOULD BE ENGAGED, BUT BOLTS SHOULD HAVE PLAY.



**Figure 10**



**Figure 9**