

KYMCO UXV 500i-700i

Plow Mount PART #106440

Kit Components:		
Item #	Qty.	Description
1	1	Plow Mount
2	2	Plow Mount Bracket
3	1	Hardware Kit HK-174
3.1	2	M6-1.00 X 25 Hex Bolt Flange GR8.8
3.2	4	5/16"-18 X 1.25" Carriage Bolt GR5
3.3	4	5/16"-18 Hex Nut Flange Nylock GR5

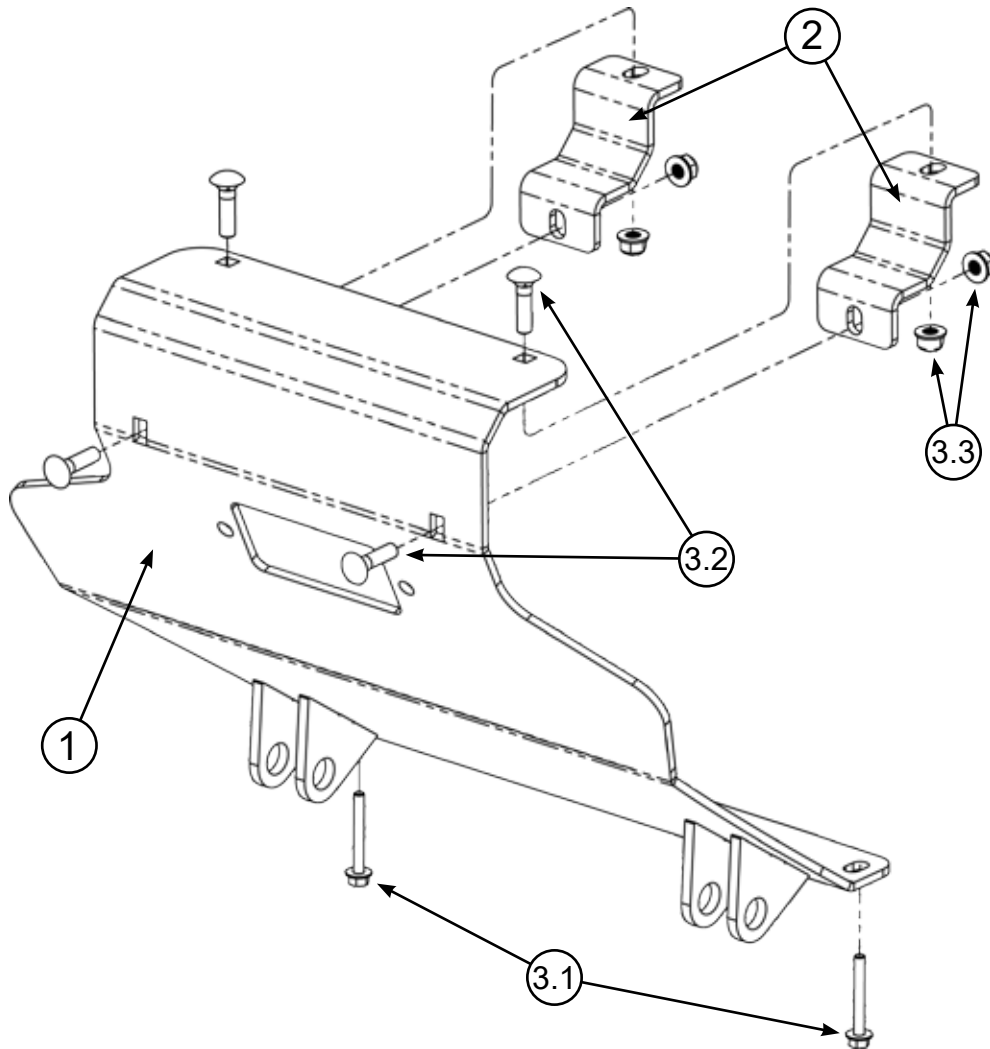

INSTALLATION INSTRUCTIONS

Note: Make sure all hardware needed to complete this mount is in the package. Thoroughly read through and understand the instructions before installing.

1. Remove the front plastic bumper guard by taking out the 4 bolts (A) shown in [Figure 1](#). You will no longer need this piece for the install.
2. Attach the fairlead roller that came with your winch to the front of the mount using the bolts (B) provided with the winch. Shown in [Figure 2](#).
3. Set the plow mount (1) on the bumper and attach the mount brackets (2) over the bumper tube to the back side of the plow mount (1). Secure with carriage bolts (3.2) and lock nuts (3.3). Shown in [Figures 3 & 4](#).
4. Attach the bottom of the plow mount using the M6 bolts (3.1) into the stock holes from the previous bumper. Shown in [Figure 6](#).
5. Tighten all hardware evenly.

