

UTV HD ACTUATOR PLATE KIT

Plow Accessory PART #106590

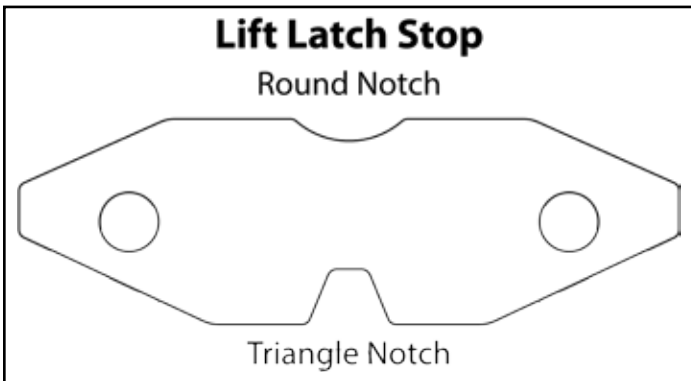
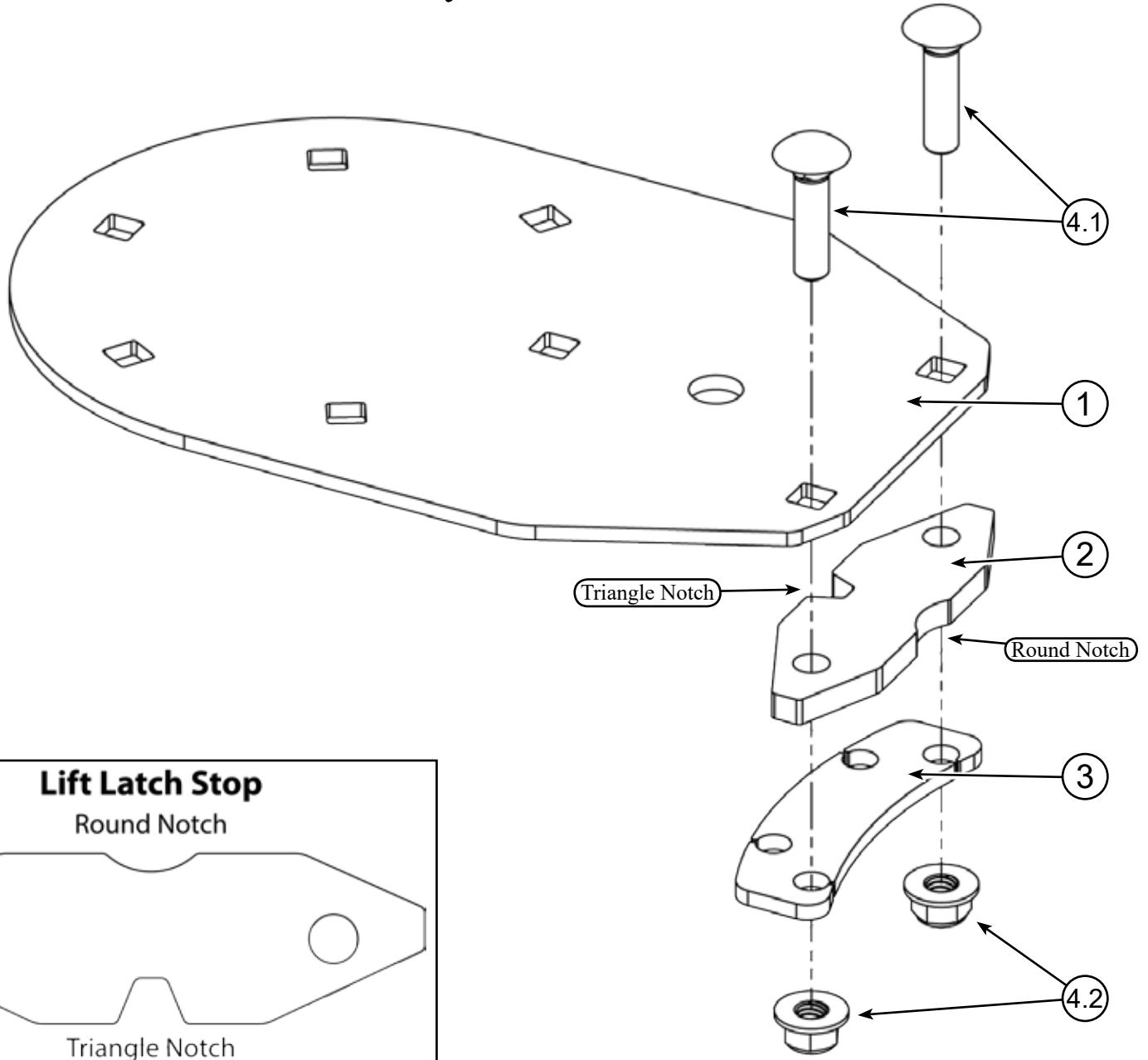

Kit Components:

Item #	Qty.	Description	Item #	Qty.	Description
1	1	Flat Cradle Keeper	4	1	Hardware Kit HK-176-2
2	1	Lift Latch Stop	4.1	2	3/8"-16 x 1.5" Carriage Bolt GR5
3	1	Track Extension Spacer (Only For Track Extension)	4.2	2	3/8"-16 Hex Nut Flange Nylock GR5



INSTALLATION INSTRUCTIONS

Note: Make sure all hardware needed to complete this mount is in the package. Thoroughly read through and understand the instructions before installing.

Installation Without Track Extension

1. If rear holes need to be drilled. Remove the 3 bolts (A) on BOTH sides of the actuator bracket, bolts (B) may need to be loosened for easier removal. Remove the front actuator bracket from the cradle. This bracket can stay connected to the actuator, just swing it out of the way. See **Figure 1**.
2. Remove the 6 carriage bolts (C) shown in **Figure 1**, then remove the original Lift Lock Latch.
3. Place the HD Lift Lock Latch (1) over the pivot bushing and secure with the original 6 Bolts (C) as shown in **Figure 2**.
4. If the rear holes are not present in the bulkhead, tighten bolts (C), and use the rear holes of the lift lock latch (1) as a template. Drill using a 13/32" bit. See **Figure 2**.

***Note:** Make sure you keep your drill straight.

5. Once your rear holes are drilled, loosen the 6 bolts (C) to install the Lift Latch Stop (2) between the Lift Lock Latch (1) and pushtube bulkhead. The triangle notch in the Lift Latch Stop (2) should be oriented towards the rear of the pushtubes (front of the machine). See **Figures 2 & 3**.
6. With the Lift Latch Stop (2) in place, install hardware (4.1 and 4.2), as shown in **Figure 3**.
7. Reinstall the actuator bracket using the original hardware (A & B), as shown in **Figures 1 & 4**.
8. Tighten all hardware evenly

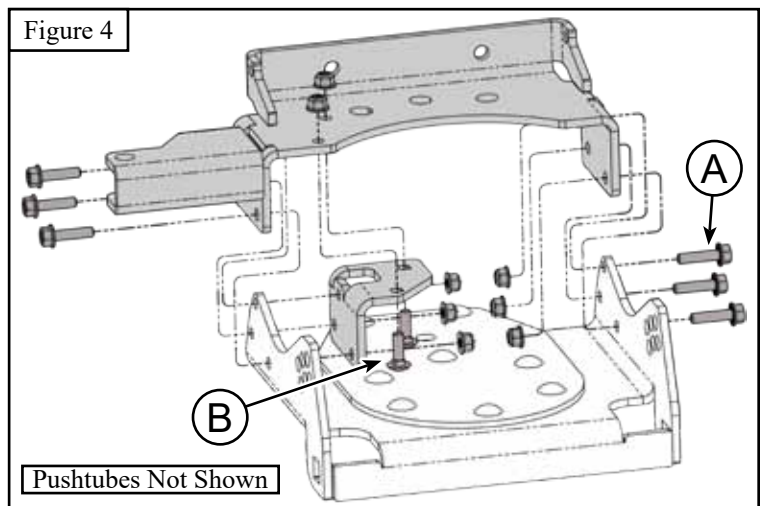
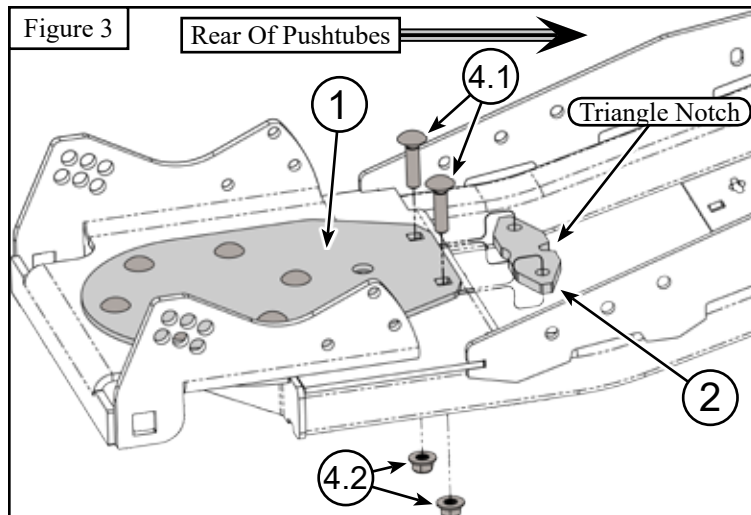
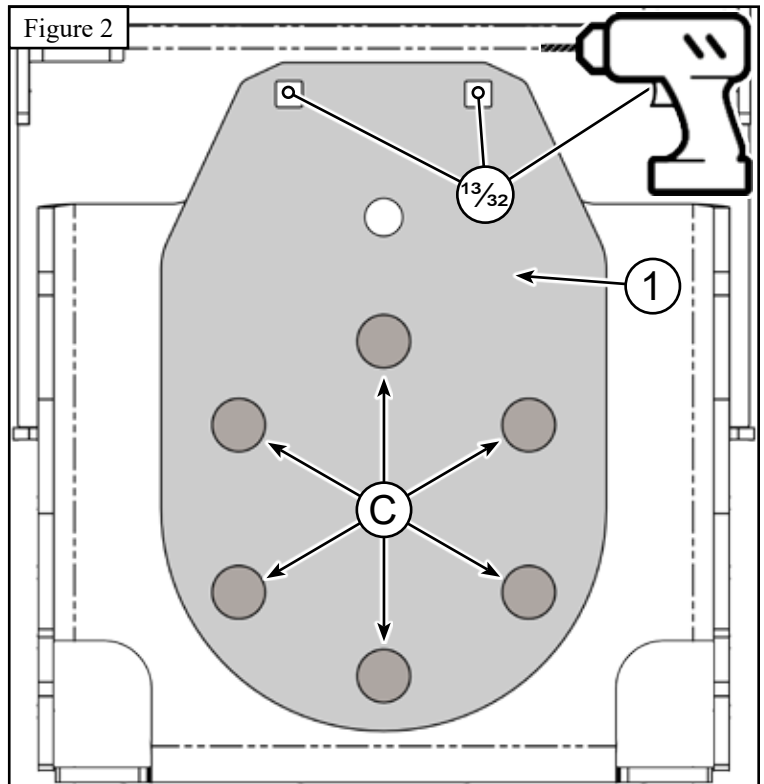
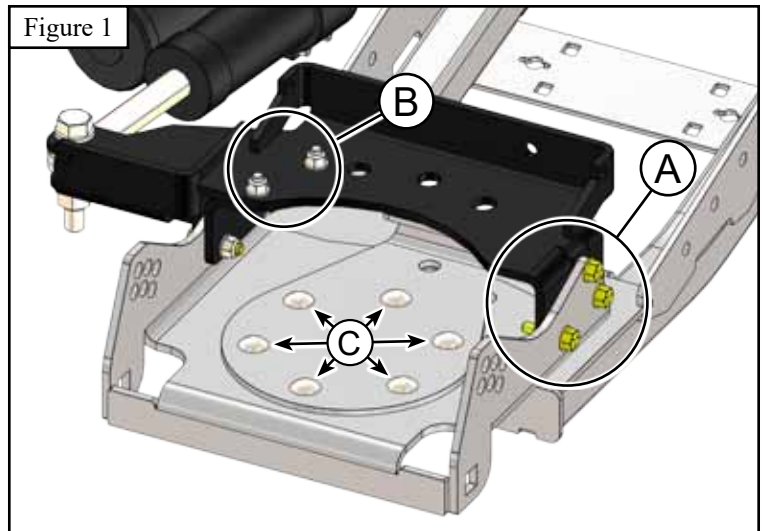

INSTALLATION INSTRUCTIONS

Installation With Track Extension

9. If rear holes need to be drilled. Remove the 3 bolts (A) on BOTH sides of the actuator bracket. Remove the Front Actuator Bracket from the cradle. This bracket can stay connected to the actuator, just swing it out of the way. See **Figure 5**.
10. If the actuator stop is installed, remove bolts (B) and remove the stop from the push tubes as shown in **Figure 6**. Reinstall hardware (B) after the stop is removed.

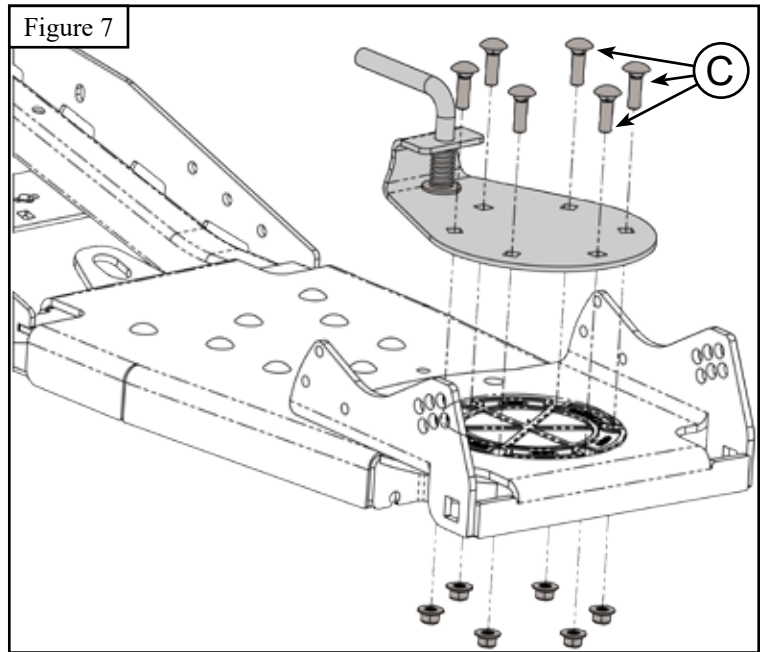
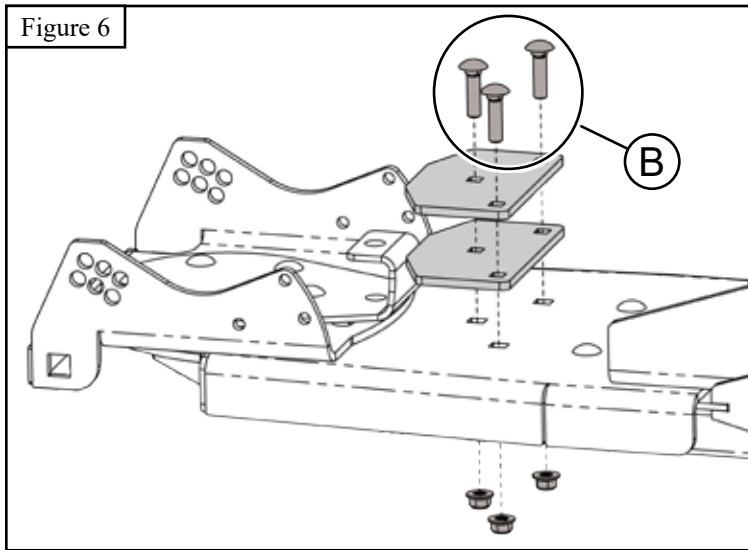
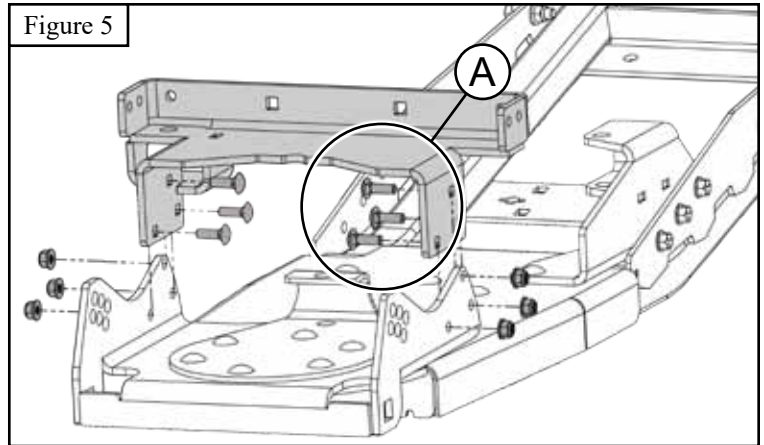

11. Remove the 6 carriage bolts (C), shown in **Figure 7**, then remove the original Lift Lock Latch
12. Place the HD Lift Lock Latch (1) over the pivot bushing, in place of the original, and secure with the original 6 Bolts (C) as shown in **Figure 8**.
13. If the rear holes are not present in the track extension, tighten bolts (C), and use the rear holes of the lift lock latch (1) as a template. Drill using a 13/32" bit. See **Figure 8**.

***Note:** Make sure you keep your drill straight.

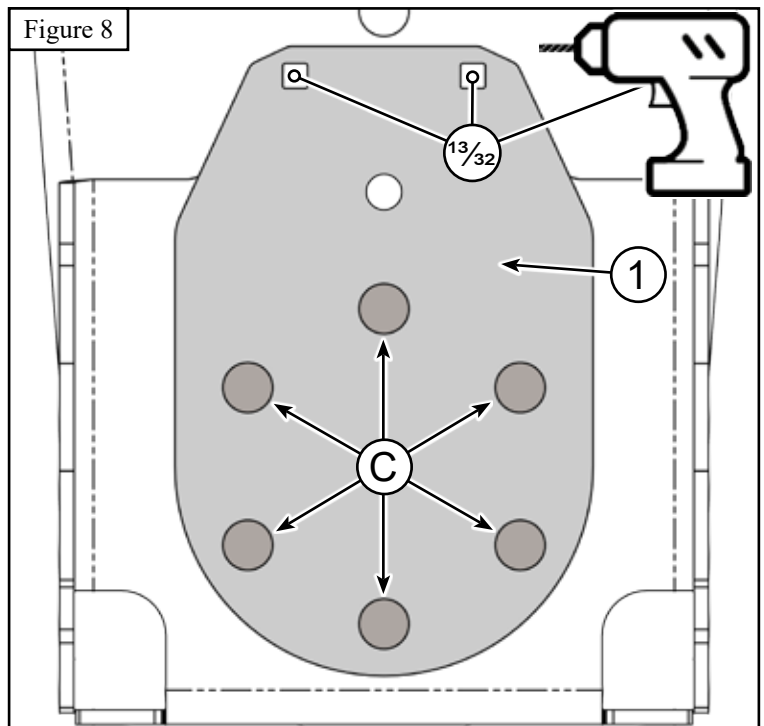

INSTALLATION INSTRUCTIONS

14. Once your rear holes are drilled, loosen the 6 bolts (C) to install the Lift Latch Stop (2) between the Lift Lock Latch (1) and track extension. The triangle notch in the Lift Latch Stop (2) should be oriented towards the rear of the pushtubes (front of the machine). See **Figures 8 & 9**.
15. Install the Track Extension Spacer (3) under the track extension. This component should follow the contour of the pushtube bulkhead, as shown in **Figure 9**.
16. Secure components from steps 14 & 15 with hardware (4.1 and 4.2), as shown in **Figure 9**.
17. Reinstall the actuator bracket with original bolts (A). See **Figure 10**.
18. Tighten all hardware evenly

