

AXIS X550, X750 / HISUN STRYKER 550X

PLOW MOUNT

PART #106670 Rev A

ONLY WORKS WITH:
KFI UTV PRO 2.0 PUSH TUBE

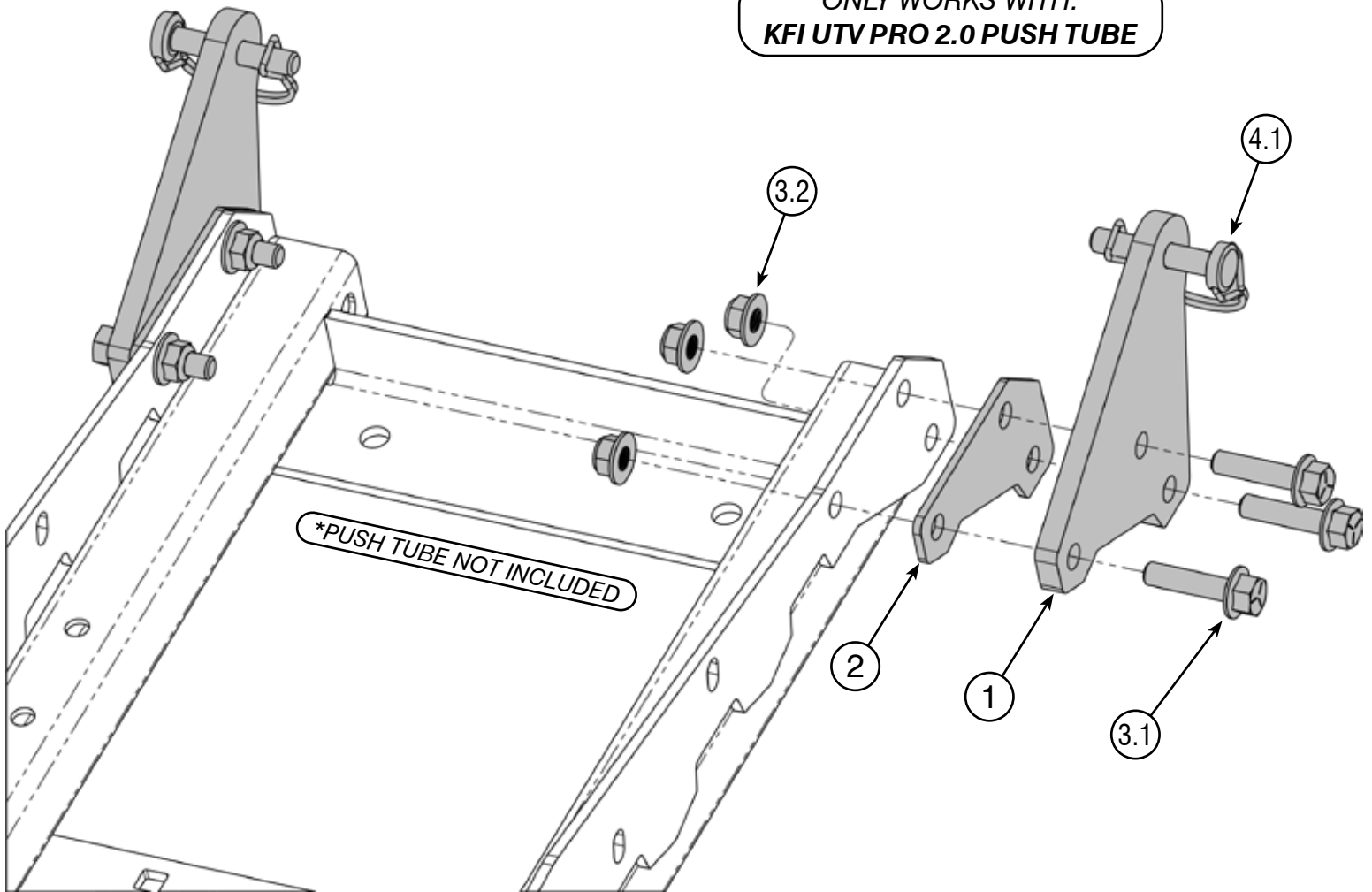

Kit Components:

Item #	Qty.	Description	Item #	Qty.	Description
1	2	3/8" Pin Attachment Bracket (106673)	3.2	6	3/8"-16 Hex Flange Nylock Nut
2	2	PRO 2.0 - 10ga Spacer (106369)	4	1	2-Pack ATV Pin Kit (105188)
3	1	Hardware Kit (HK-450)	4.1	2	3/8" Safety Pin (P800250)
3.1	6	3/8"-16 x 1.50" Hex Flange Bolt			



INSTALLATION INSTRUCTIONS

Notice

Torque bolts to ANSI Specs (or OEM specs if applicable), unless otherwise stated. After the first use and at the start of each season, check torque.

Note: Make sure all hardware needed to complete this mount is in the package. Thoroughly read through and understand the instructions before installing.

Installation Instructions

1. If the stock pin attachment brackets (106302) are already installed on the push tube, remove them. If not, proceed to Step 2.
2. Loosely attach the 3/8" pin attachment brackets (1) and the 10ga spacers (2) to the push tube using bolts (3.1) and nuts (3.2). Refer to **Figure 1**.
3. Once all hardware is in place, **torque to 31 Ft-lbs**.
4. Connect the push tube to the machine's stock tabs using the 3/8" safety pins (4.1). See **Figure 2**.

