



## UTV DASH MOUNTED ROCKER SWITCH



MODEL NUMBER

**UTV-DRS**

### **SAVE THESE INSTRUCTIONS**

Important Safety Instructions  
are included in this manual.

721 Sata Drive  
Spring Valley, MN 55975  
USA /1-877-346-2050  
[www.kfiproducts.com](http://www.kfiproducts.com)



## UTV Dash Rocker Switch



- (1) **Rocker Switch** – Used to power the rope in or out of your winch drum. This switch is a Double Pole/Double Throw (two contact points per IN or OUT)

## WIRING LAYOUT

### Switch Wiring Diagram

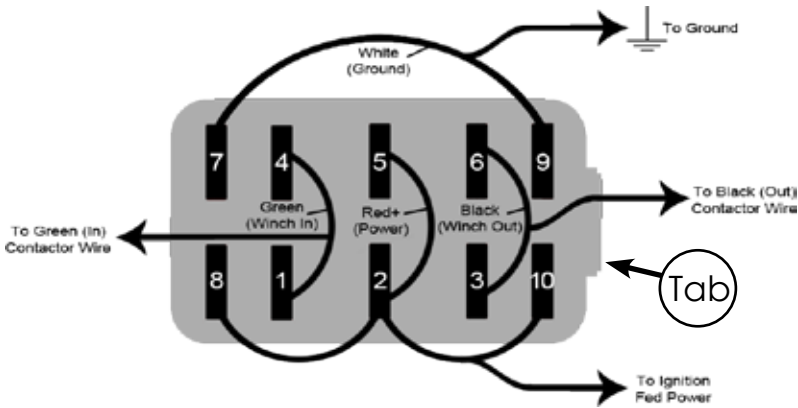

**Terminal #2, #5, #8 and #10** – Power to Switch (+) (Connect to RED wire on contactor)  
- #8 and #10 are for ignition power to LED's

**Terminal #1 and #4** – Signal for Winch -IN- (Connect to small GREEN wire on contactor)

**Terminal #3 and #6** – Signal for Winch -OUT- (Connect to small BLACK wire on contactor)

**Terminal #7 and #9** – Ground (-) for LED (Connect to Frame ground or Battery (-) NEGATIVE post on the contactor)

# INSTALLATION

Note: Before installing make sure you have the correct orientation for the switch with the tab facing towards you.

1. Insert the blue diodes (A) first and small spring (B) second into the designated hole on each side shown in [Figure 1](#).
2. Insert the two large springs (C) into the designated holes on each side shown in [Figure 1](#).
3. Set the clips (D) Face up into the designated location shown in [Figure 1](#).
4. Set the white rocker plunger onto the post in the top portion of the switch shown in [Figure 2](#).
5. Take the top portion of the switch and set it on the bottom portion. Shown in [Figure 3](#).
6. Note: The "In" position is lined up with the (Tab) on the one side of the switch so you know how to attach it back together correctly. Shown in [Figure 3](#).
7. There is a clip on each side of the rocker switch. Push the top portion of the switch down and snap the clips into place. Shown in [Figure 3](#).

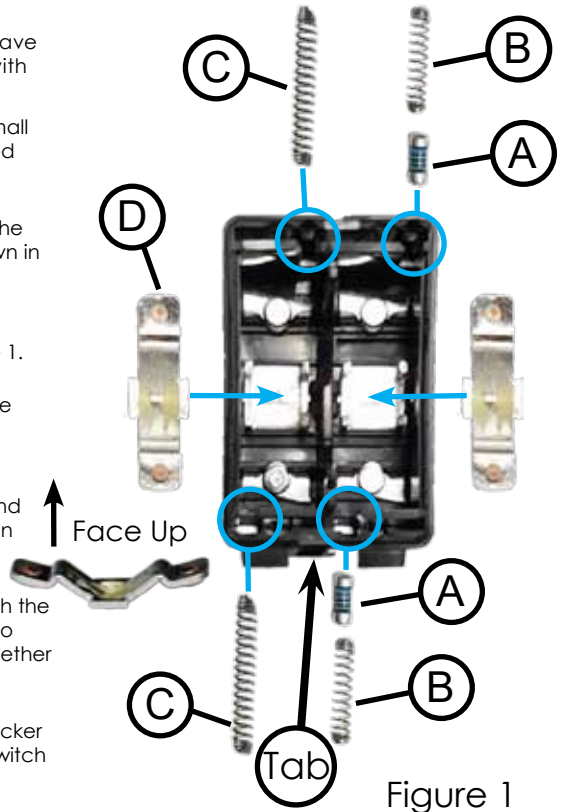

Figure 1

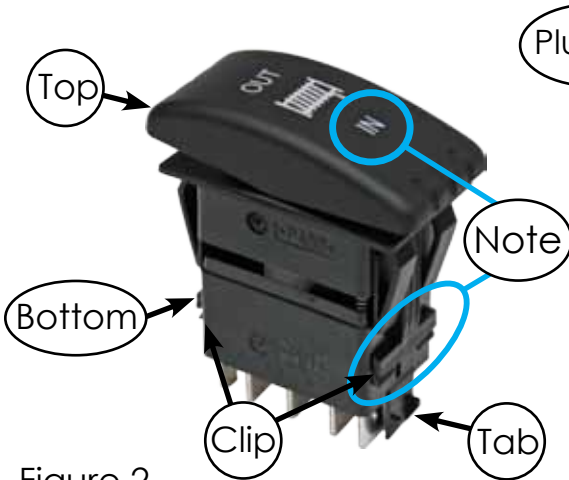

Figure 2

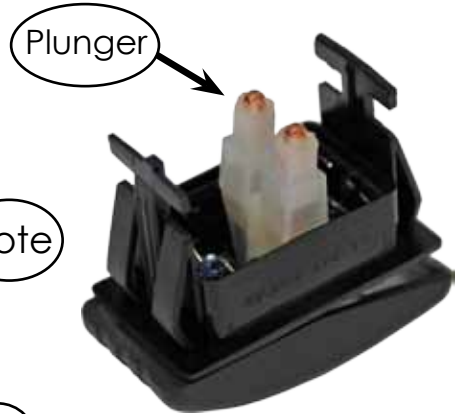

Figure 3

## WARRANTY

KFI Products  
1 YEAR LIMITED WARRANTY

### Warranty Qualifications

Kappers Fabricating, Inc. (KFI) will warranty with a copy of your sales receipt from one of KFI's retail locations as proof of purchase.

### Repair/Replacement Warranty

Kappers Fabricating, Inc. (KFI) warrants to the original purchaser that the mechanical and electrical components will be free from defects in materials and workmanship for a period of one (1) year from the original date of purchase. We will repair or replace, at our discretion, parts found to be defective due to materials or workmanship. This warranty applies only to products which have been properly assembled, adjusted, and operated in accordance with the instructions contained within the product manual. This warranty does not apply to any product of Kappers Fabricating, Inc. that has been subject to alteration, misuse, abuse, improper assembly or installation, or shipping damage.

### Do Not Return The Unit To The Place Of Purchase

In the event you have a claim under this warranty, contact KFI's Technical Service and KFI will troubleshoot any issue via phone or e-mail. If the problem is not corrected by this method, KFI will, at its option, authorize evaluation, repair or replacement of the defective part or component at a KFI Service Center. KFI will provide you with a case number for warranty service. Please keep it for future reference. Repairs or replacements without prior authorization, or at an unauthorized repair facility, will not be covered by this warranty.

### Warranty Exclusions

This warranty does not cover the following repairs and equipment:

#### Normal Wear

This product needs periodic parts and service to perform well. This warranty does not cover repair when normal use has exhausted the life of a part or the equipment as a whole.

#### Other Exclusions

This warranty excludes: Cosmetic defects such as paint, decals, etc. Failures due to acts of God and other force majeure events beyond the manufacturer's control. Problems caused by parts that are not original KFI Products parts. Failures due to Water intrusion.

### Limits of Implied Warranty and Consequential Damage

THIS WARRANTY DOES NOT APPLY TO ANY INCIDENTAL OR CONSEQUENTIAL DAMAGES AND ANY IMPLIED WARRANTIES ARE LIMITED TO THE SAME TIME PERIODS STATED HEREIN FOR ALL EXPRESSED WARRANTIES.

THE WARRANTY SET FORTH ABOVE IS THE ONLY WARRANTY. THERE ARE NO OTHER WARRANTIES, EXPRESS OR IMPLIED, INCLUDING BUT NOT LIMITED TO IMPLIED WARRANTIES OF MERCHANTABILITY OR FITNESS FOR A PARTICULAR PURPOSE.

Some states do not allow the exclusion of implied warranties or the exclusion or limitation of liability for incidental or consequential damages, or limitations on how long an implied warranty lasts, so the above limitation or exclusion may not apply to you. This warranty gives you specific legal rights. You may also have other rights that vary from state to state.

### Contact Information

#### Address

KFI Products  
Customer Service  
721 Sata Drive  
Spring Valley, MN 55975  
[www.kfiproducts.com](http://www.kfiproducts.com)

#### Technical Service

Mon – Thu, 8:00 AM – 5:00 PM (CST)  
Fri, 8:00 AM - 1:00 PM (CST)  
Toll Free: 1-877-346-2050  
[tech@kfiproducts.com](mailto:tech@kfiproducts.com)



1-877-346-2050

KFI Products  
P.O. Box 32  
721 Sata Drive  
Spring Valley, MN 55975 USA  
[www.kfiproducts.com](http://www.kfiproducts.com)  
Made In China  
©2024 Kappers Fabricating, Inc.

---

## 1) Install Switch to desired location on your dash

1. Most UTV's and SxS's have predefined switch locations that are pre-scribed or marked for mounting and require finish cut with a knife.
2. Use the cut-out dimensions shown below to cut-out the switch location. If your dash doesn't have the pre-scribed areas.
3. Pull the plug end of the wiring harness through the hole and connect it to the rocker switch outside the hole before inserting the switch.

*Note: Insert the switch carefully, if the hole is to small trim some of the plastic.*

*This switch comes in two pieces for ease of installation, is not designed to come back apart after installing.*

