

POLARIS RS1

Winch Mount PART # 101545
Hardware Kit: HK-346, HK-031

Kit Components:

Qty.	Part Description
1.....	Support Bracket (1)
1.....	Backer (2)
1.....	Winch Mount (3)
1.....	Bumper (4)

Hardware

4.....	3/8"-16 x 1.00 Hex Bolt Flange
2.....	3/8"-16 Hex Nut Flange Nylock
2.....	M10-1.50 x 30 Hex Bolt Flange
8.....	M8-1.25 x 20 Hex Bolt Flange
4.....	Bumper Tube Cap
1.....	UTV Mini Rocker Kit (HK-031)

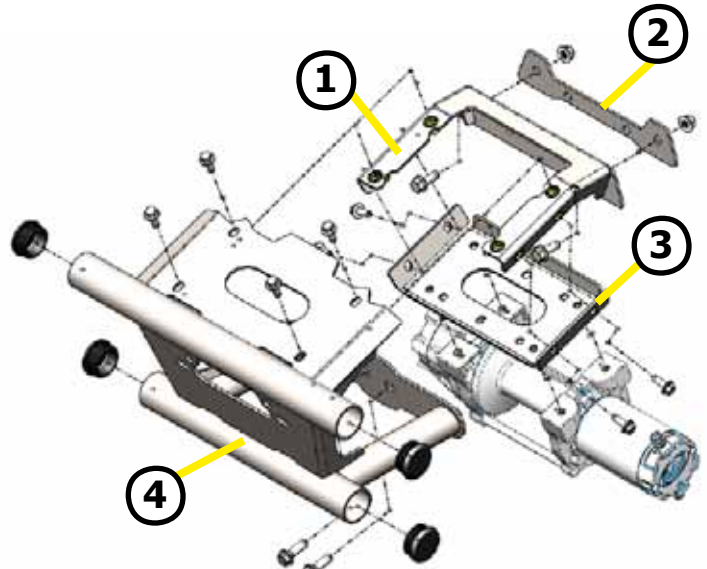

"Figure 1"

INSTALLATION INSTRUCTIONS:

1. Remove the hood using the two hood latches.
2. Unplug head lights from wiring before pulling front fascia off the machine
3. Detach front fascia by removing the 6 Torx Bolts (A). Shown in Figure 2 & 3. Retain hardware.
4. Remove tow hook shown in Figure 3 (B) save to reinstall later



"Figure 2" Hood Removal

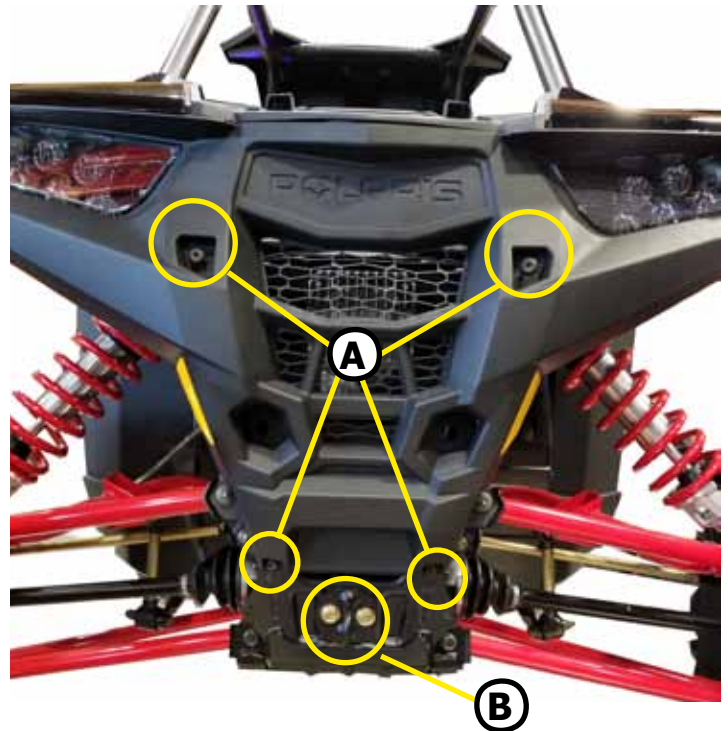

"Figure 3" Front Fascia Removal

5. Place support bracket (1) into position using holes (C) from [Figure 4&5](#). Slip backer plate (2) [Figure 6](#) into position behind front frame. Align the support bracket (1) with the bolt holes and backer plate (2). Shown in [Figure 4,5&6](#). Fasten support bracket (1) to the front frame using two 3/8" x 1.00" Hex Flange Bolts and nuts (D).
6. Reinstall front fascia from step 3 [Figure 2, 3 and 7](#)
7. Reattach the head lights to wiring after installing front fascia on the machine.

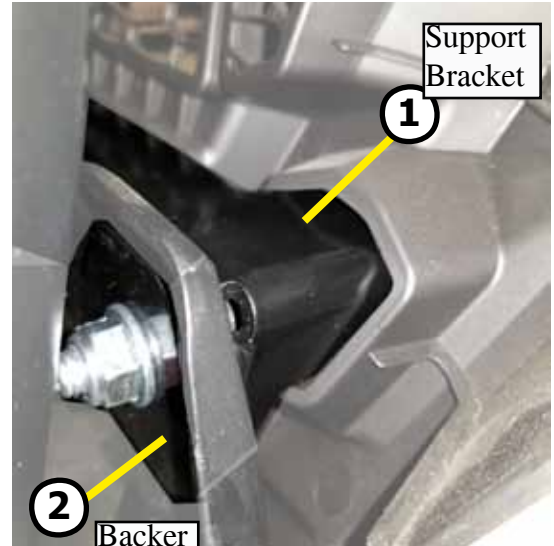

"Figure 6" Backer Plate

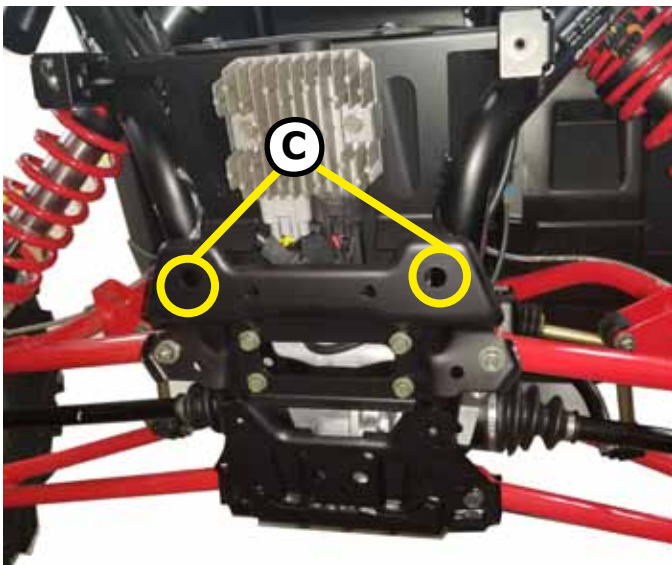

"Figure 4" Mount Bolt Locations

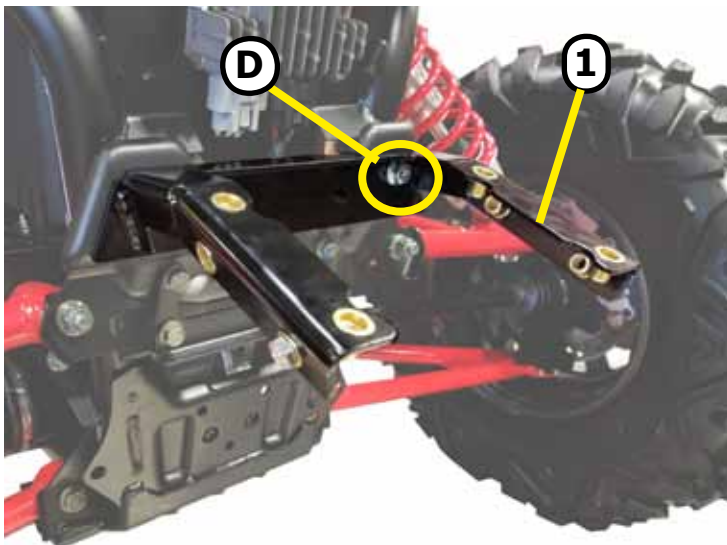

"Figure 5" Front Bolts for Mount

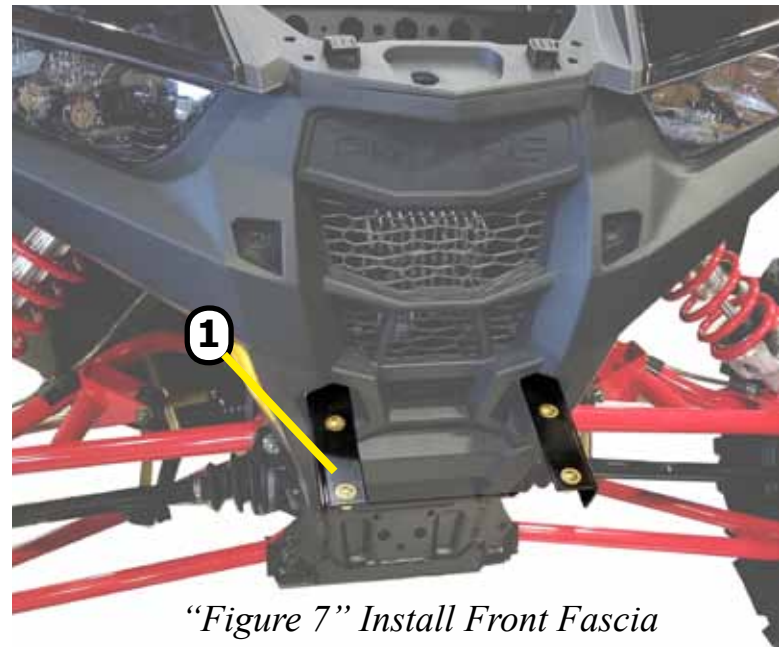

"Figure 7" Install Front Fascia

8. Install your winch to the winch mount (3) using the hardware provided with your winch. Figure 8 shows a standard winch bolt pattern 3" x 4 7/8". Use the outside set of holes for a wide winch 3" x 6.60" and the center set of holes for a 2 hole winch.
9. Install winch and winch mount (3) to support brackets (1) using four - M8 x 20mm Hex Flange Bolts (E) Shown in Figure 9
10. Install your roller fairlead or hawse to the bumper (4). Shown in Figure 10. Use the hardware provided with your winch.
11. Install bumper (4) using four - M8 x 20mm Hex Flange Bolts (H) and two - 3/8" x 1.00" Hex Flange Bolts (F) Shown in Figure 11&12
12. Install Bumper Tube Caps (G) Figure 11
13. Install the Tow hook using longer M10 x 30mm Hex Flange Bolt from step three.
14. Tighten all hardware

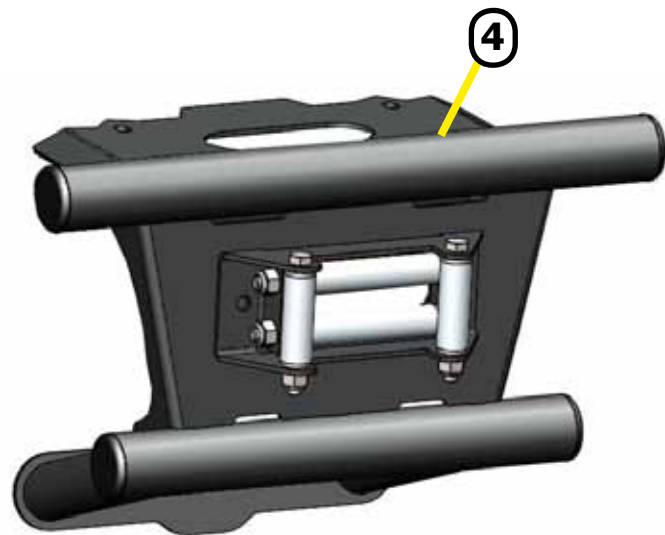

"Figure 10" Fairlead Install

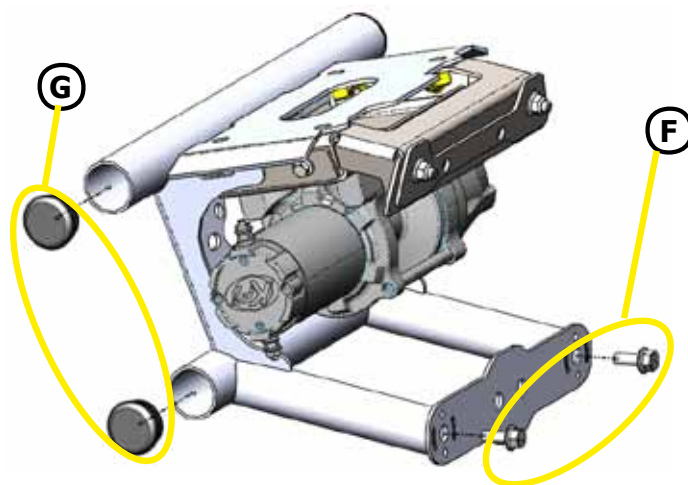

"Figure 11" Bumper Install

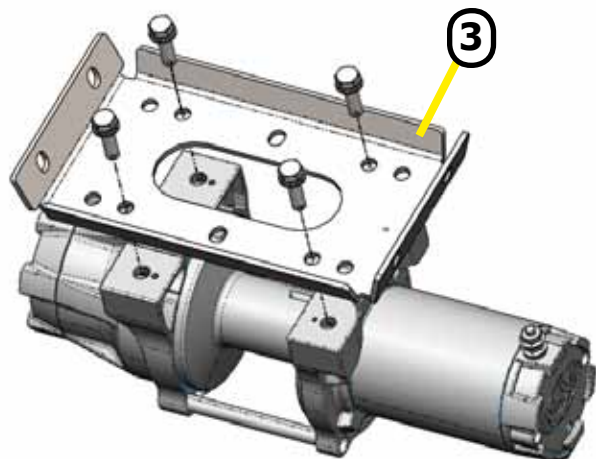

"Figure 8" Winch Install

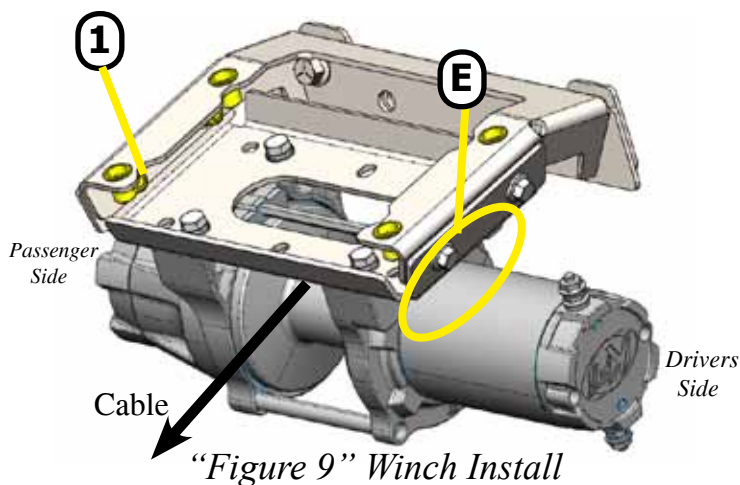

"Figure 9" Winch Install



"Figure 12" Bumper Install

WIRING INFORMATION

1. For battery location please see [Figure 13](#). There is no set location for the contactor on this machine. *We suggest placing it somewhere under the hood that is out of the elements.*
2. Remove hardware (H) to remove passenger side panel [Figure 14 & 15](#). Route winch switch wiring from contactor through the side panel to the switch panel (I). Please see winch owners manual wiring instruction for dash rocker or mini rocker.
3. Mini-Rocker Switch Hardware kit (HK-031). This allows you to mount your usual handle bar mounted switch to almost any desired location.
 - a. Remove handlebar mount hardware from the switch.
 - b. Locate desired mounting location
 - c. Mark and drill two switch holes through dash using switch housing as a template
 - d. Drill a 3rd hole for the switch wiring.
 - e. Assemble per [Figure 16](#) using HK-031 hardware.
4. Find a location that suits your purposes for the mini-rocker switch and hand remote.
5. Reinstall passenger side panel [Figure 14 & 15](#)



“Figure 14” Side panel Removal



“Figure 15” Side panel removed



*“Figure 13” Battery Location
(Battery is located under hood.)*

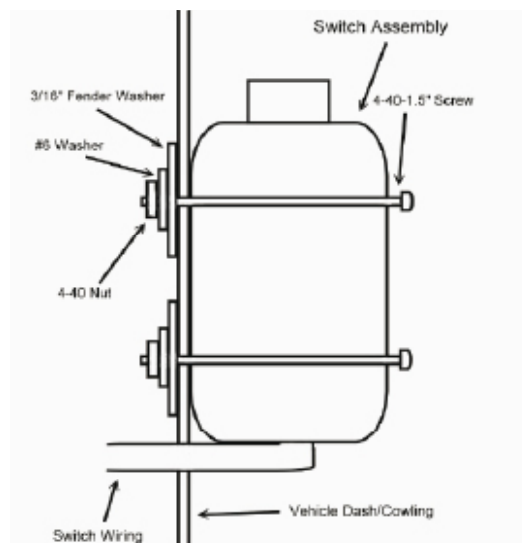

Optional Switch Mount Instructions*

“Figure 16” Mini-Rocker Mounting