

YAMAHA RHINO REAR BUMPER

Rear Bumper

Part # 101625

Kit Components:

Item #	Qty.	Description
1	1	Rear Bumper Tube WLDMT
2	1	Bumper Bracket, Passenger Side
3	1	Bumper Bracket, Driver Side
4	1	Template
5	4	Bumper Tube Cap
6	1	HK-044
6.1	4	5/16"-18 x 2.00 Button Head Cap Screw
6.2	4	5/16" SAE Flat Washer
6.3	4	5/16" USS Flat Washer
6.4	4	5/16"-18 Hex Nylock Nut
7	1	HK-333
7.1	6	5/16"-18 x .75 Carriage Bolt BLK
7.2	4	5/16"-18 x 1.00 Hex Flange Bolt
7.3	10	5/16"-18 Hex Flange Nylock Nut

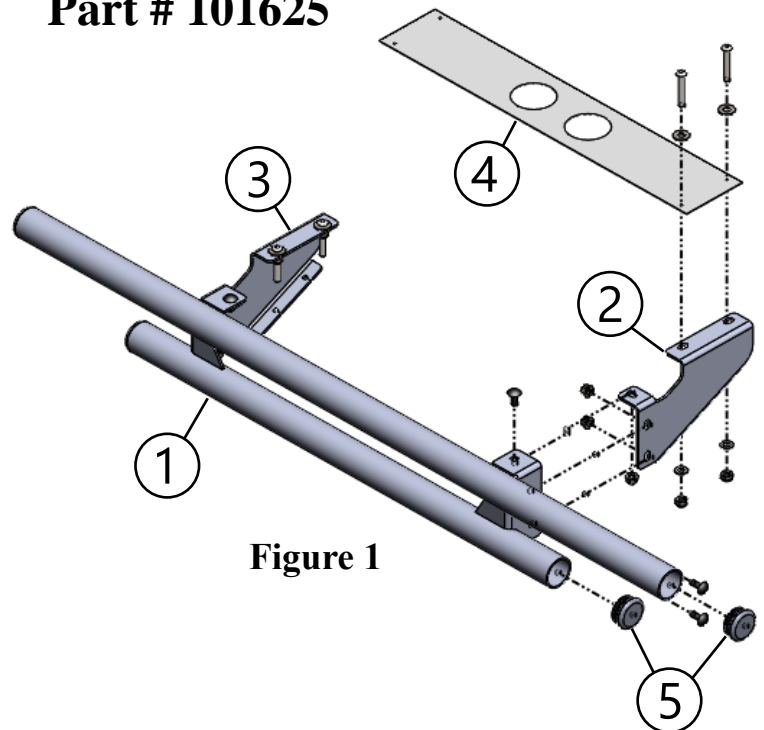

Figure 1

INSTALLATION INSTRUCTIONS:

Note: Make sure all of the hardware needed to complete this mount is in the package. Read through and understand the instructions before installing.

1. Remove the rubber bed liner to keep from drilling through it later in step 3.
2. Place the supplied template onto the rear box channel support and line up the two center larger holes with the holes on the Rhino's box channel as shown in **Figure 1**. Tape the template into location and check straightness with the rhino box and that it is centered from left to right of the machine. Once everything is centered and located correctly, mark the four outside holes with a marker or center punch.
3. Remove the template and drill the four holes marked in step 2 using a 3/8" drill bit up through the channel and bed of the box shown in **Figure 3**.
4. Set the driver side bracket (3) in place and fasten it using 5/16" Bolt (6.1) and 5/16" USS (Larger) washer (6.2) by inserting them from the top down through the box channel and secure using 5/16" SAE (smaller) washer (6.3) and 5/16" Nut (6.4) from HK-044 as shown in **Figures 1, 3, and 4**.

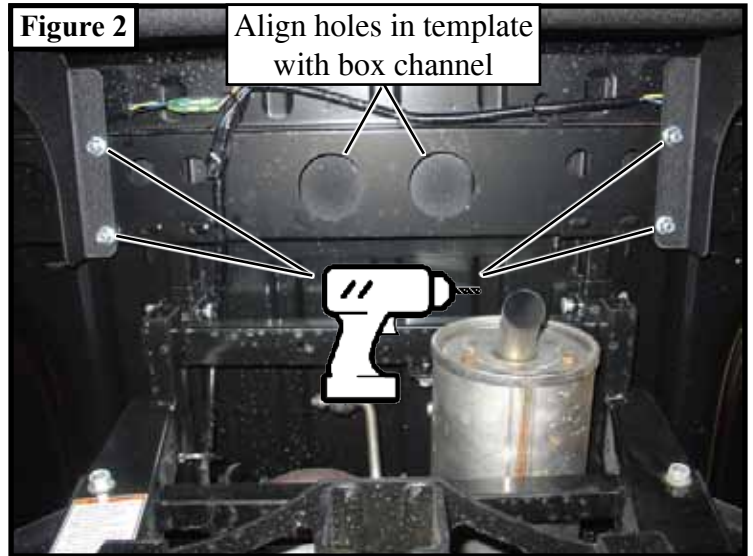

Figure 2

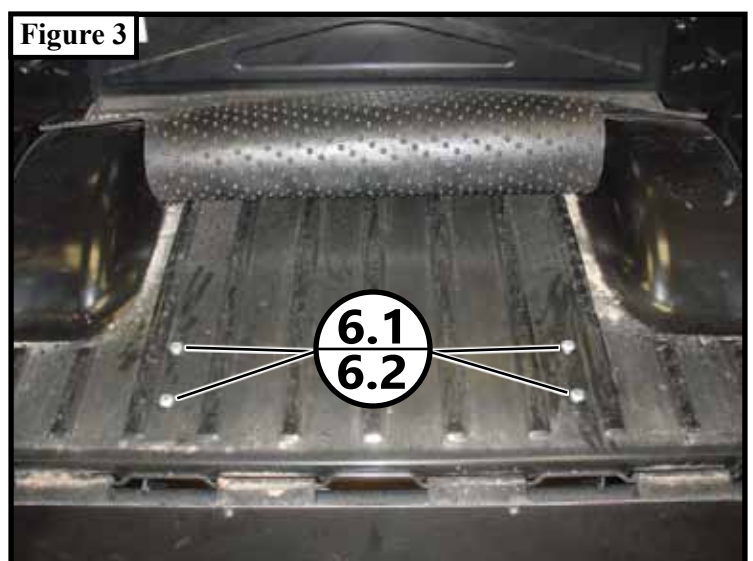

Figure 3

5. Repeat step 4 for Right Hand bracket (2).
6. Hold Rear Bumper Tube WLDMT (1) in place and secure using 5/16" Black Carriage Bolts (7.1) and 5/16" Nut (7.3) from HK-333 as shown in **Figure 5**.
7. Assemble Bumper Tube Caps (5) to bumper as shown in **Figure 1**.
8. Tighten all hardware evenly and replace rubber bed liner removed in step one.

