

POLARIS RZR 900/1000/TURBO/GENERAL

Winch Mount

Part # 101735 Rev A

Kit Components:

Item #	Qty.	Description
1	1	Winch Mount Plate
2	1	Fairlead Bracket Standard/Wide
3	1	HK-031 (UTV Mini Rocker Hardware Kit)
4	1	HK-355
4.1	4	3/8"-16 x 1.00" Carriage Bolt GR5 Zinc
4.2	4	3/8"-16 Hex Flange Nylock Nut GR5 Zinc
4.3	2	3/8"-16 x 1.50" Hex Flange Bolt GR5 Zinc
4.4	12	3/8" Flat Washer
4.5	4	M12-1.75 x 25 Hex Flange Bolt GR8.8 BLK
4.6	4	M12-1.75 Hex Flange Nylock Nut GR8.8 Zinc

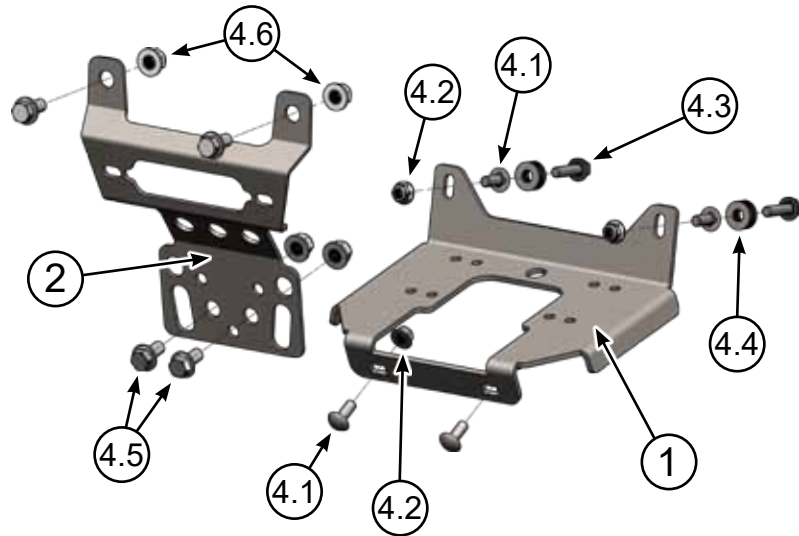

INSTALLATION INSTRUCTIONS:

1. Remove the hood. Shown in **Figure 2**.
2. Take off the access cover by removing the 2 bolts (A). Shown in **Figure 3**.
3. Unplug headlights from their wiring before pulling front fascia off the machine.
4. Detach front fascia by removing the 10 Torx Bolts (B). Shown in **Figure 4**.

Note: RZR 900 shown in Figures 3 & 4. Your machine may have a slightly different fascia and access cover but removal is similar to Figures 3 & 4.

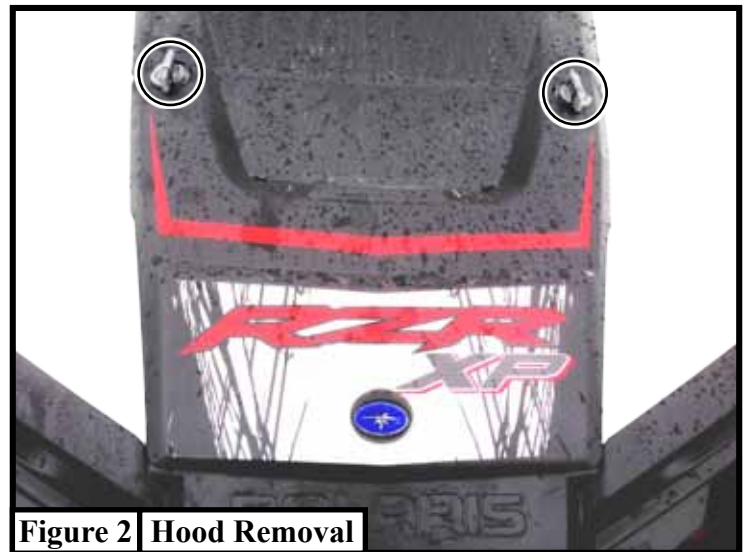

Figure 2 Hood Removal

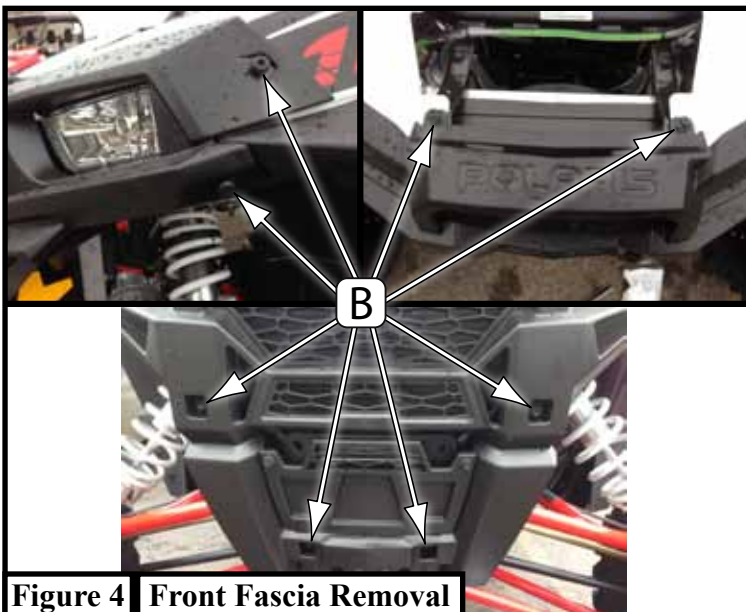

Figure 4 Front Fascia Removal



Figure 3 Access Cover Removal

- Place winch mount (1) into position from the drivers side of the machine in order to avoid the breather hose for the front differential. Align the winch mount (1) with the bolt holes (C&D) as shown in **Figure 5**.
- Fasten the winch mount (1) to the front frame rail using the 3/8" carriage bolts (4.1) and 3/8" nuts (4.2) as shown in **Figure 6** with nuts to the inside so the carriage bolts sit in the square cutout. Some machines may not have the square cutouts to hold a carriage bolt. Use hardware (4.3 and 4.2) in these situations. Use the 3/8" (4.1) carriage bolts and 3/8" nuts (4.2) as shown in **Figure 7** with the bolt head inside the frame channel, for the rear holes.
- Get all hardware started loosely, then evenly tighten the four nuts.
- If there is space between the frame and winch mount, refer to page 4 and use the washer and bolts. Depending on where the winch sits (too close on front or back side), you may need to place washers in front or behind the winch mount (1) to move the winch and mount forward or back to provide the clearance needed.

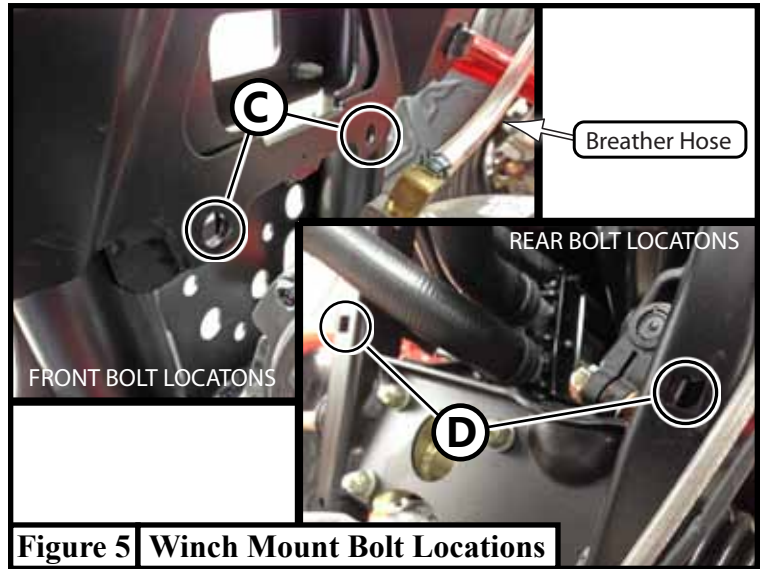

Figure 5 Winch Mount Bolt Locations

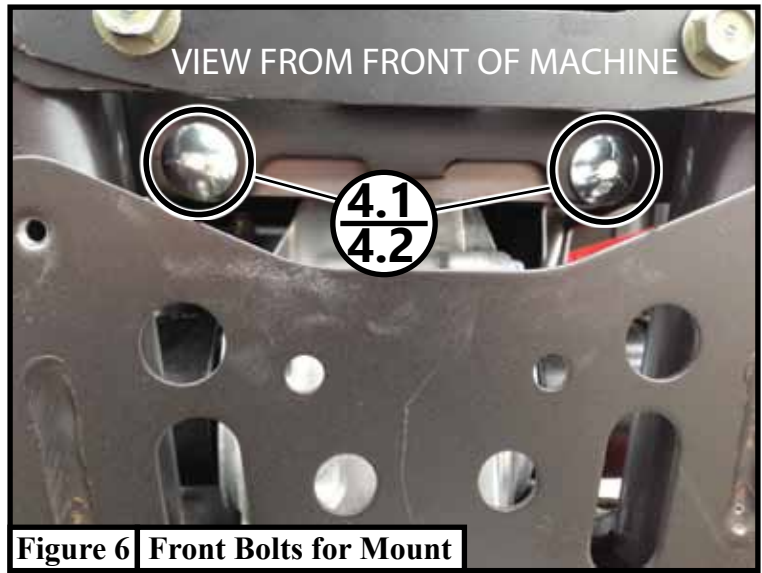

Figure 6 Front Bolts for Mount

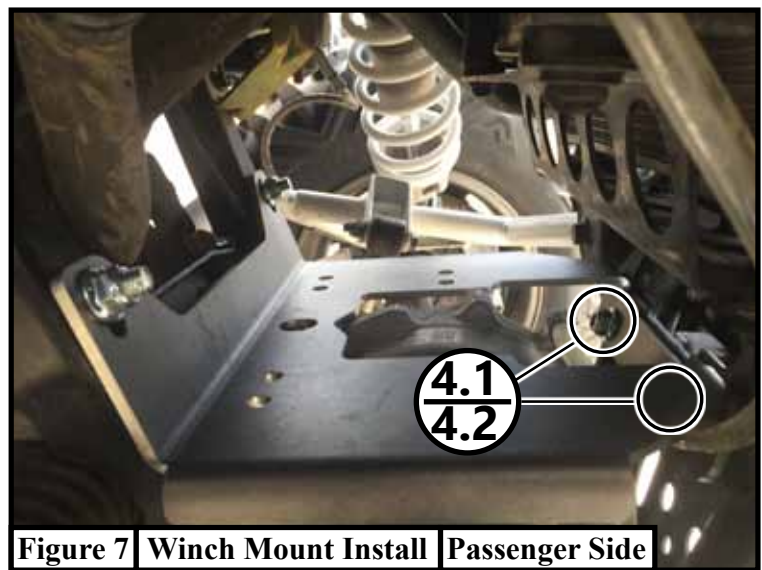
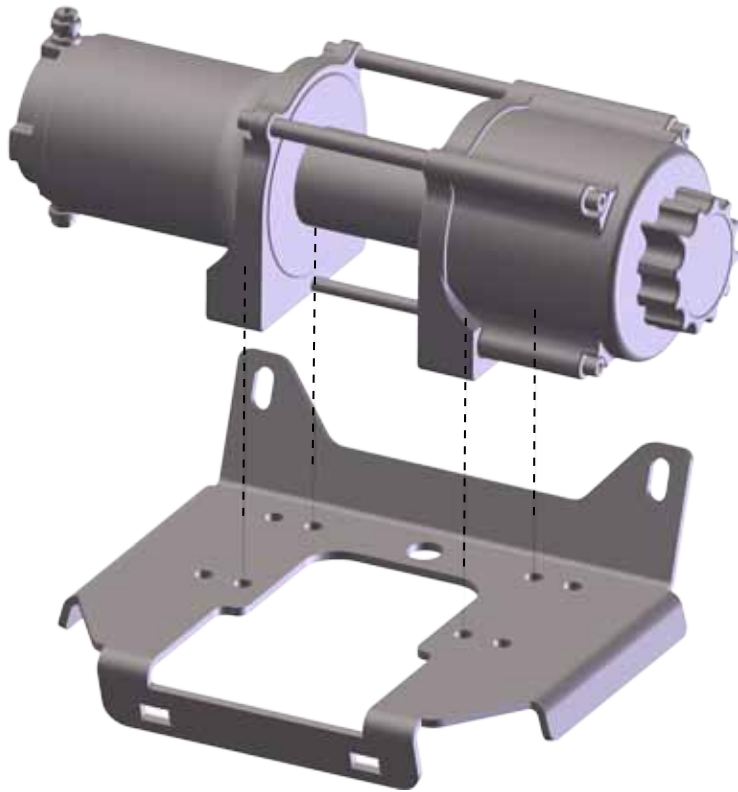

Figure 7 Winch Mount Install Passenger Side



9. Install your winch to the mount using the hardware provided with your winch. Shown in **Figure 8**.
 10. Installing your roller fairlead or hawse.
 - **Standard Winch:** assemble roller fairlead or hawse per **Figure 9**.
 - **Wide Winch:** assemble roller fairlead or hawse per **Figure 10**.
- GENERAL 1000:** Install fairlead plate first, then the roller fairlead to the plate.
11. Install the fairlead assembly with four M12 bolts (4.5) and M12 nuts (4.6) **Figure 11**.
 12. Tighten all hardware.
 13. Replace front fascia and hood removed in Steps 1-4, replace all torx bolts and tighten. Reconnect headlight wires. **DO NOT DO THIS UNTIL WIRING IS DONE.**



“Figure 8” Winch Install

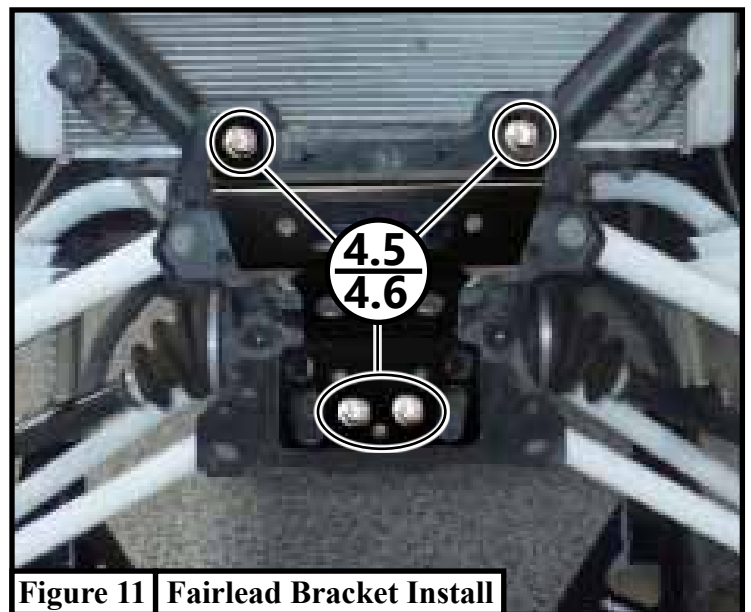
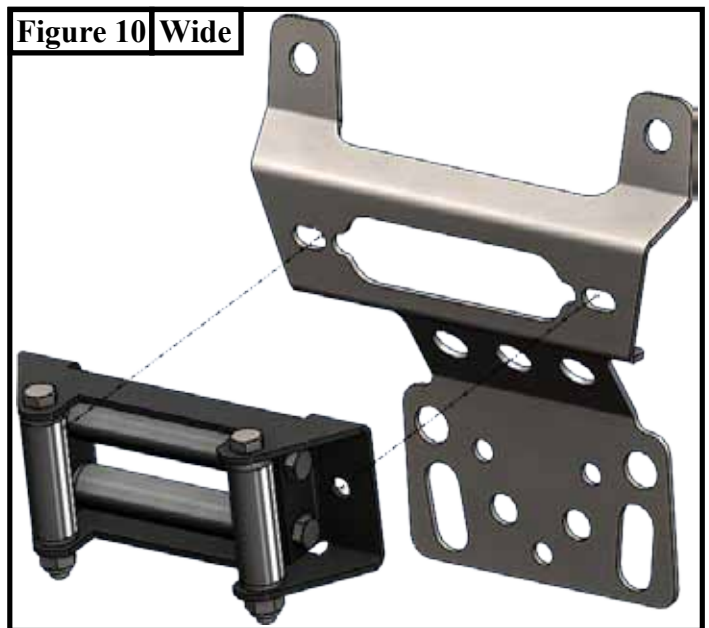
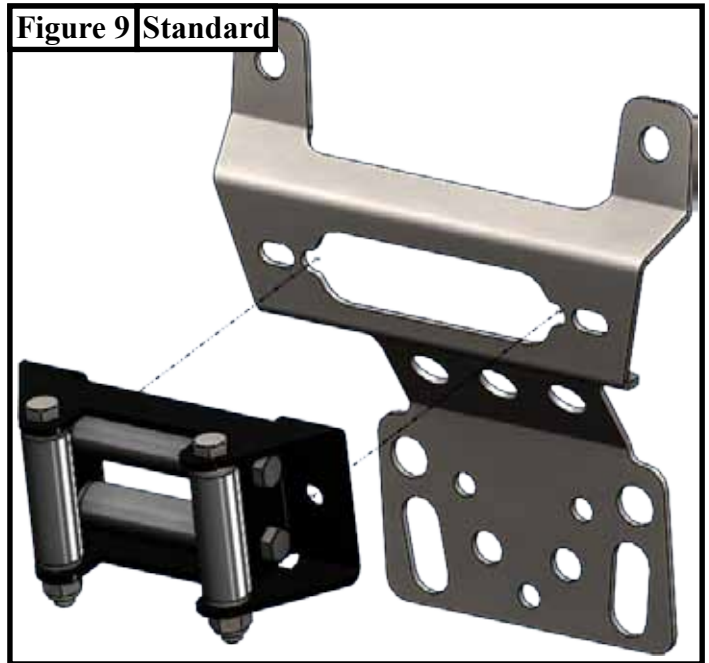

Figure 11 Fairlead Bracket Install

Note: Front fascia and fairlead not shown for clarity



Polaris RZR 1000 Spacer Kit

Hardware Kit # HK-355

- (2) 3/8"-16 x 1.5" Hex Flange Bolts
- (12) 3/8" USS Flat Washers

For the Polaris RZR 1000's you may need to use this spacer kit to fill the gap between the mount and the RZR Frame. You will need to use at least 5 washers per side but we have included 6 washers for each side to accommodate variances in the frames. You will use the Hex Flange Bolts from hardware kit #HK-355.

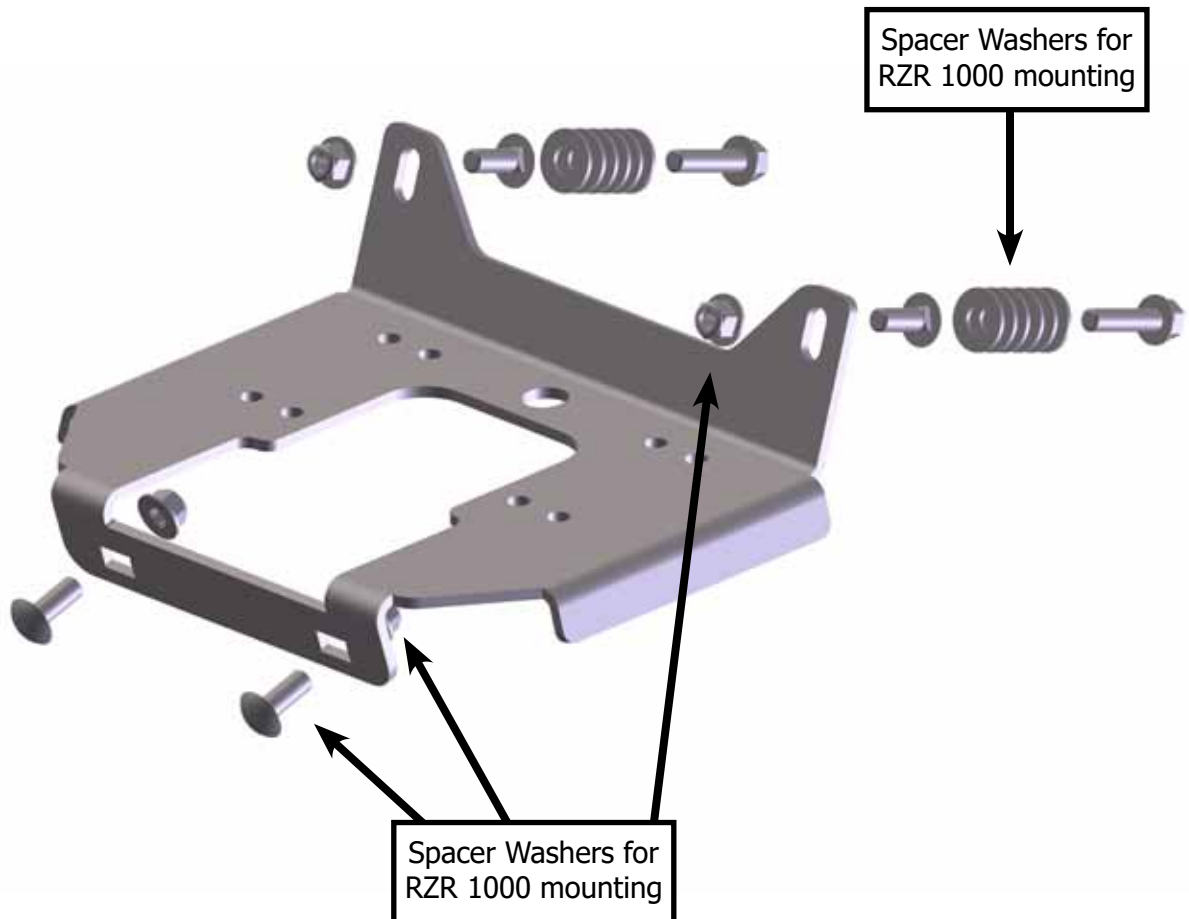

WIRING INFORMATION

1. For contactor location please see “Figure 12”. There is no set location for the contactor on this machine. *We suggest placing it some where under the hood that is out of the elements.*

Note:

The wires will need to be switched for this machine. The longer wires (Blue/Yellow) will be used to go from the battery to the contactor. The shorter wires (Black/Red) will be used to go from the winch to the contactor. See page 6 for alternate wiring diagram instructions.

2. Mini-Rocker Switch Hardware kit. This allows you to mount your usual handle bar mounted switch to almost any desired location.
 - a. Remove handlebar mount hardware from the switch.
 - b. Locate desired mounting location
 - c. Mark and drill two switch holes through dash using switch housing as a template
 - d. Drill a 3rd hole for the switch wiring.
 - e. Assemble per Figure 15.
3. Find a location that suits your purposes for the mini-rocker switch and hand remote.
4. Wire the red ignition wires from controllers to the acc post (+) as shown in Figure 14.

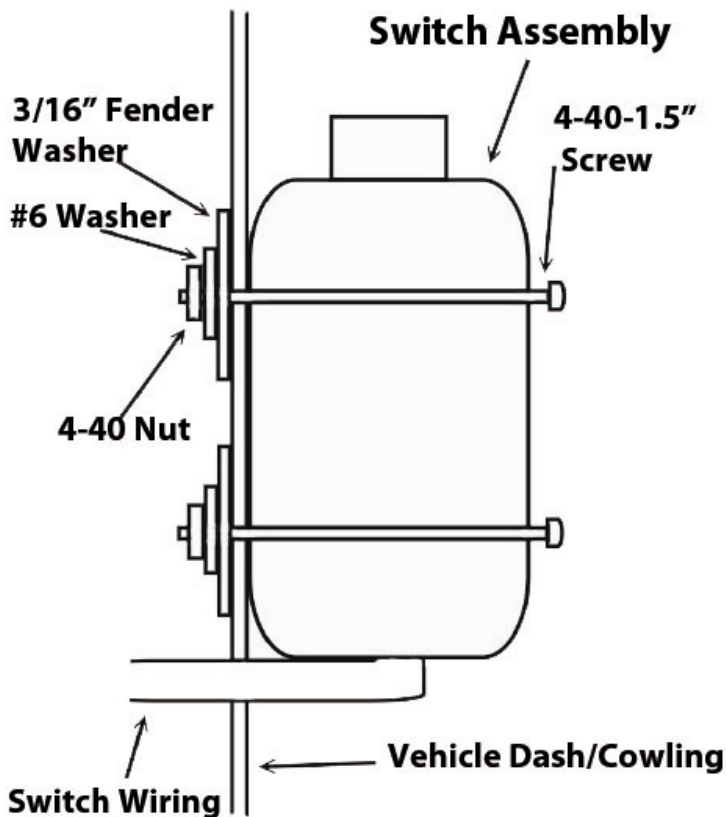

Optional Switch Mount Instructions*
"Figure 15" Mini-Rocker Mounting

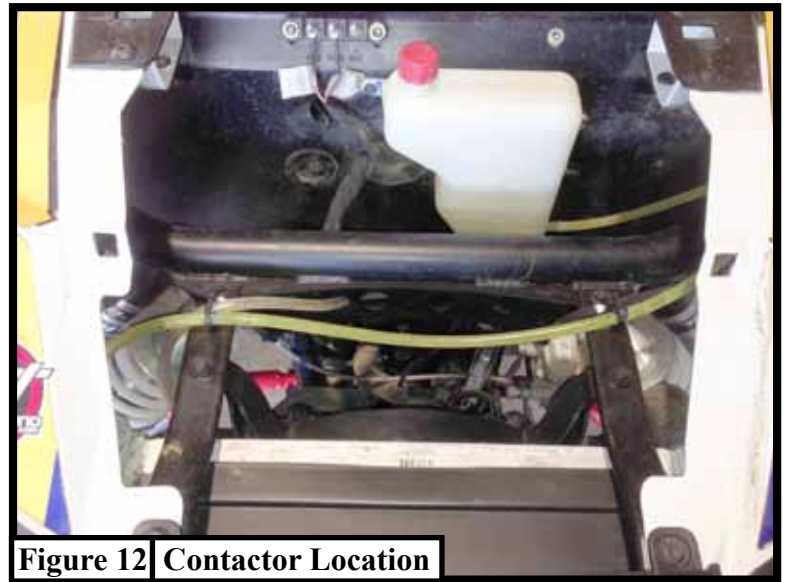

Figure 12 Contactor Location
(located under the hood)



Figure 13 Battery Location
(battery is located under driver seat)

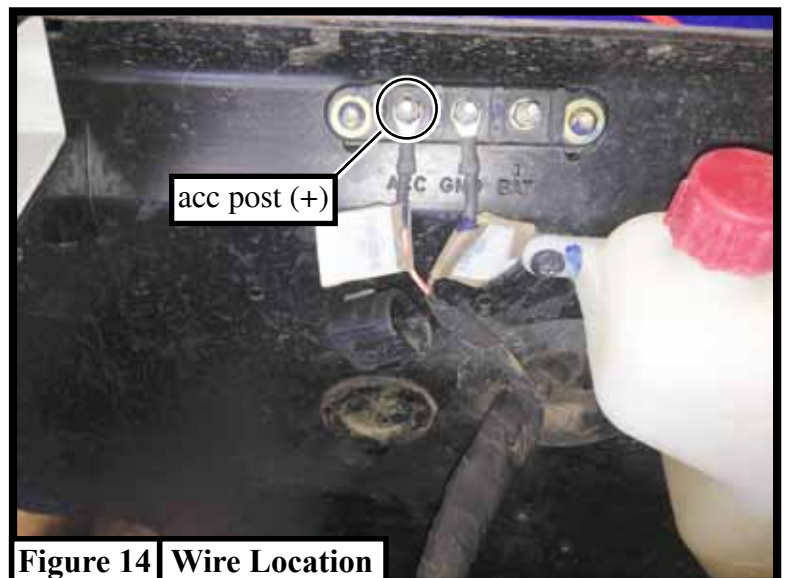

Figure 14 Wire Location
(located under the hood)

ALTERNATE WINCH WIRING DIAGRAM



WARNING

Thoroughly read and understand alternate wiring diagram before attempting to start wiring. Failure to follow the wiring directions may result in damage to your wiring system or equipment.

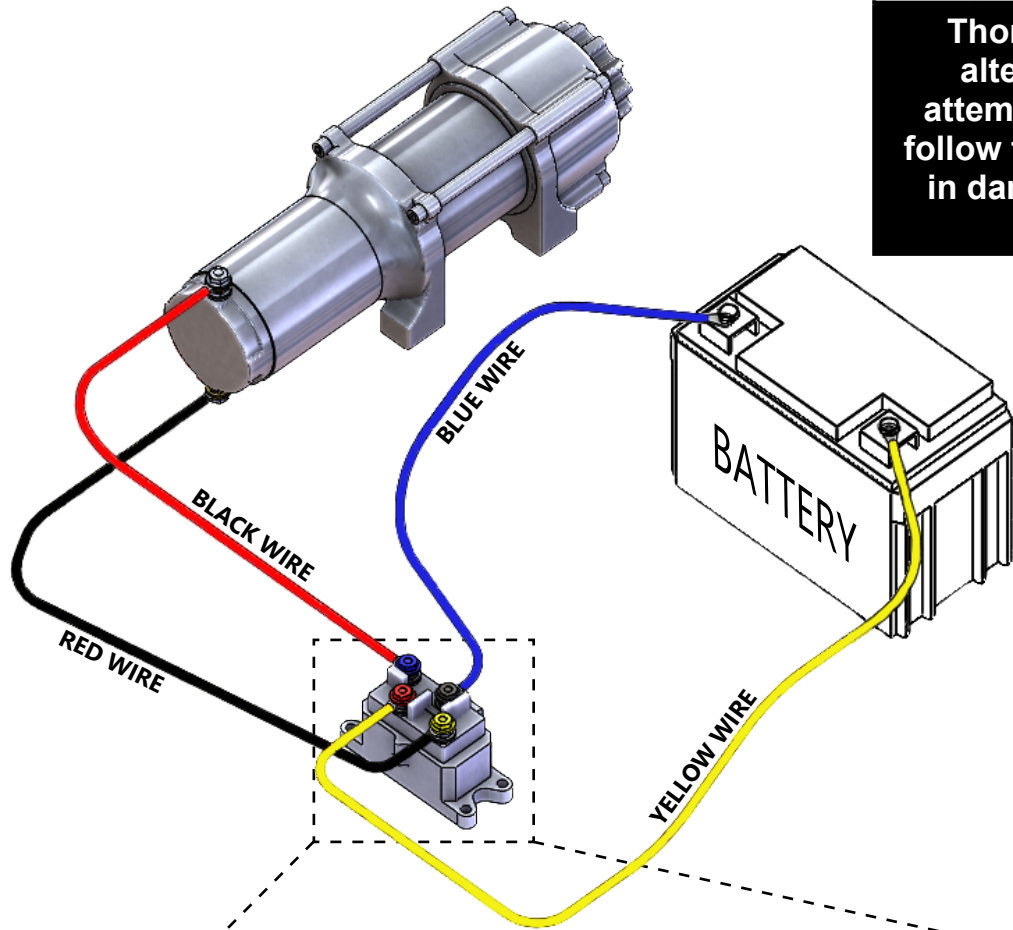

- For use with ATV/UTV applications where the contactor cannot be located close to the vehicles battery
- Run shortest wires, usually red and black, from the contactor to the winch. Run the longest wires, usually blue and yellow, from the contactor to the battery.
- Do NOT color code the wires to the contactor. RED + and BLACK - MUST be wired to the battery.

CONTACTOR

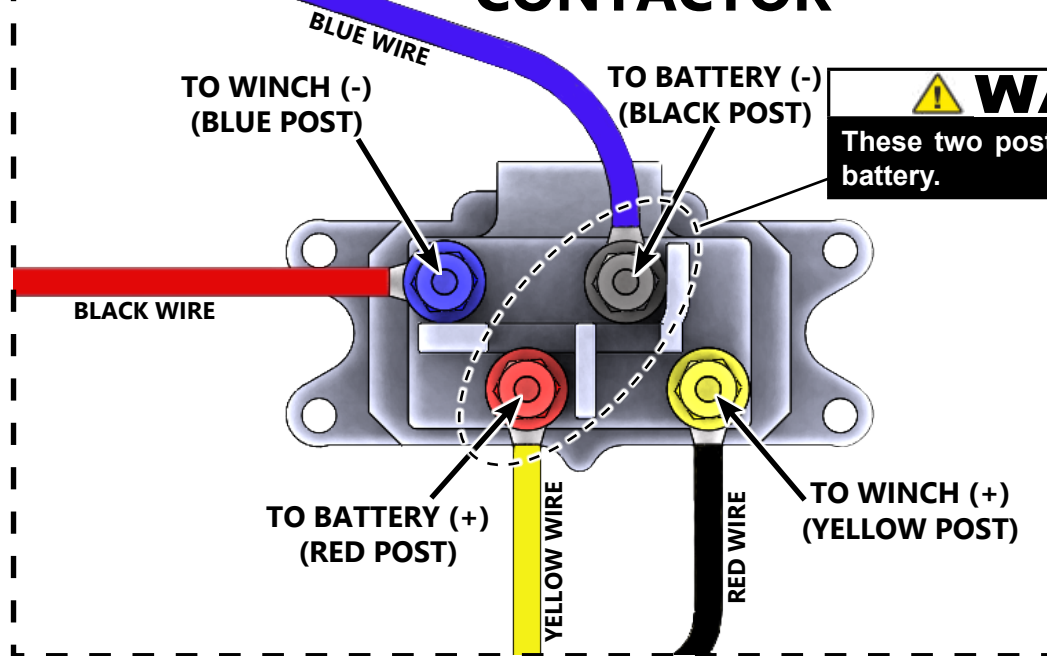

WARNING

These two posts MUST be wired to the battery.

- WIRE WINCH NEGATIVE (BLACK WIRE) TO --> BLUE CONTACTOR POST
- WIRE WINCH POSITIVE (RED WIRE) TO --> YELLOW CONTACTOR POST
- WIRE BATTERY NEGATIVE (BLUE WIRE) TO --> BLACK CONTACTOR POST
- WIRE BATTERY POSITIVE (YELLOW WIRE) TO --> RED CONTACTOR POST