

KIOTI K9 WINCH MOUNT

Winch Mount PART #102015

Kit Components:		
Item #	Qty.	Description
1	1	Winch Mount Channel
2	1	Winch Mount Base
3	1	Hardware Kit HK-418
3.1	2	3/8"-16 x 1" Carriage Bolt GR5
3.2	2	3/8"-16 Hex Nut Flange Nylock GR5
3.3	6	M8-1.25 X 30 Hex Bolt Flange GR8.8

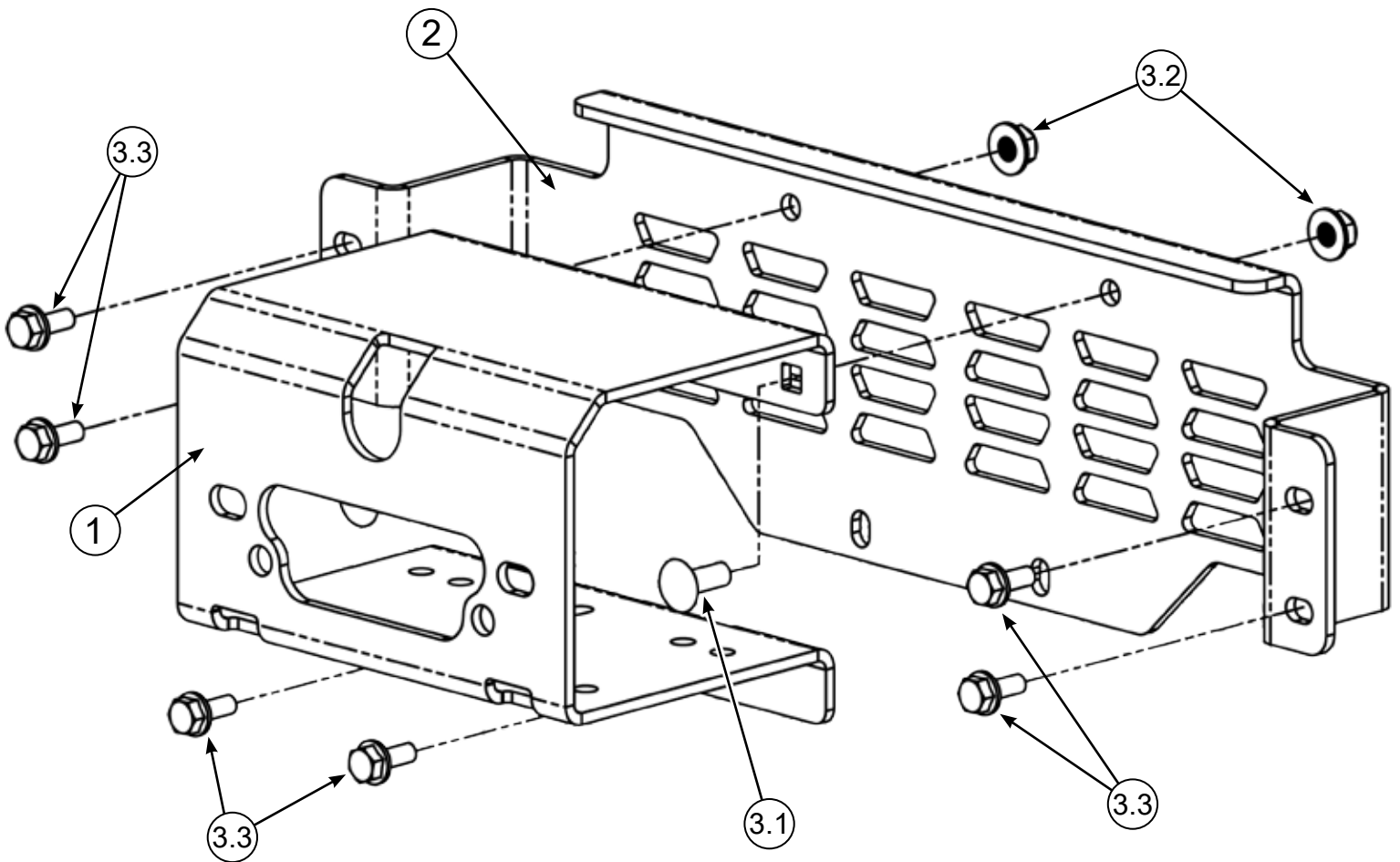

INSTALLATION INSTRUCTIONS

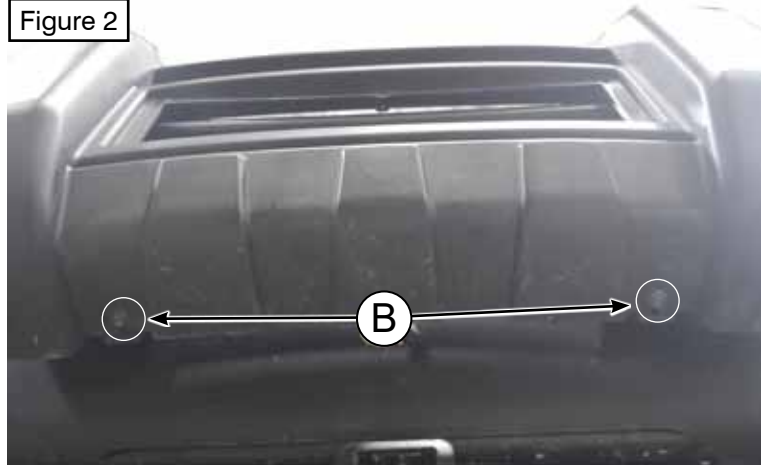
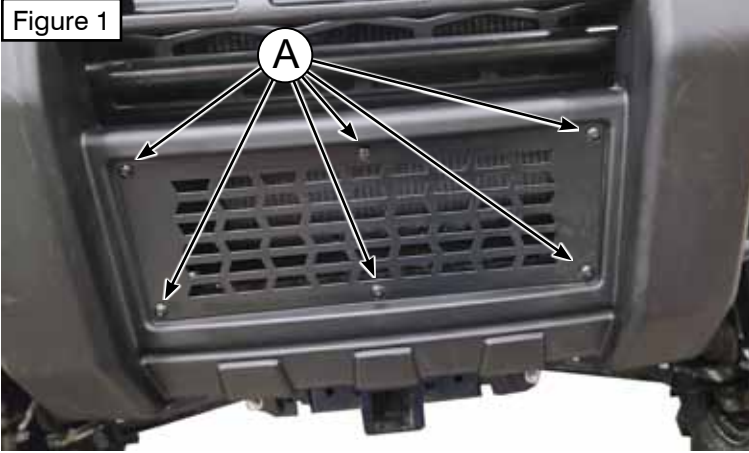

Note: Make sure all hardware needed to complete this mount is in the package. Thoroughly read through and understand the instructions before installing.

1. Remove all 6 bolts (A) holding the grille into the bumper, as shown in **Figure 1**. This grille will not be reinstalled.
2. Remove the 2 screws (B) in the bottom of the bumper as shown in **Figure 2**. The 2 screws (C) on the side of the bumper, as shown in **Figure 3**. The 2 screws (D) in the top of the bumper, as shown in **Figure 4**. Remove the bumper from the machine.
3. Attach the fairlead, to the Winch Mount Channel (1), with the hardware that came with your winch as shown in **Figure 5**.
4. Place the Winch in the Winch Mount Channel (1), as shown in **Figure 6**. Secure with hardware that came with your winch to the specifications found in the winch manual.

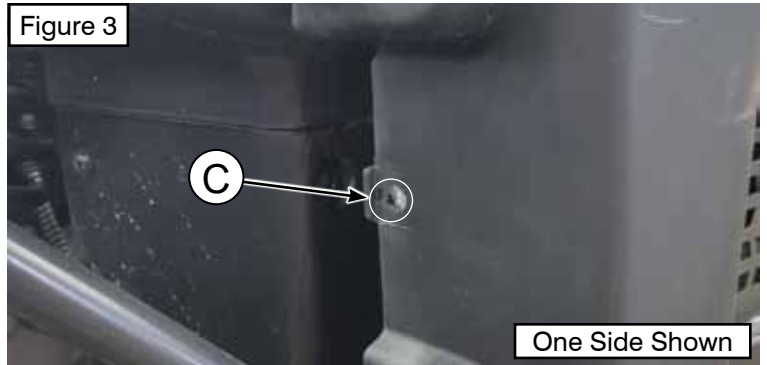

Note: If you don't have any extra room around your winch when placing it in the channel, it is recommended to install the carriage bolts (3.1) from step 5 before installing the winch.

5. Once your winch and fairlead are secured, attach the Winch Mount Channel (1) to the Winch Mount Base (2) using 2 carriage bolts (3.1) and lock nuts (3.2), as shown in **Figure 7**.
6. Place your Winch/Mount Assembly inside the grille location on the machine and use the 6 bolts (3.3) to secure the winch mount assembly as shown in **Figure 8**.

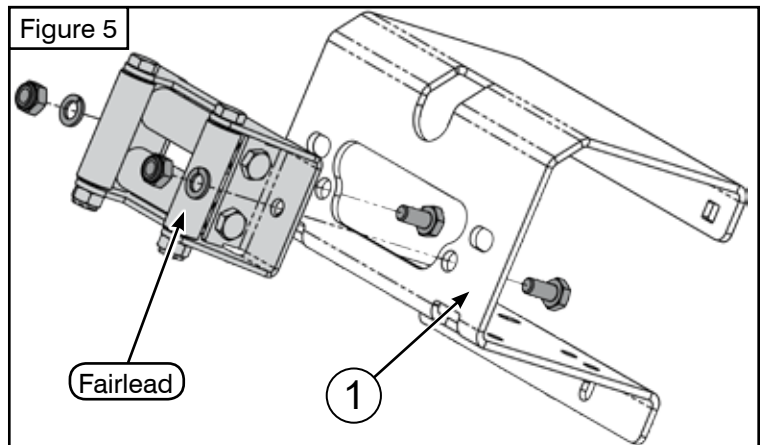

INSTALLATION INSTRUCTIONS

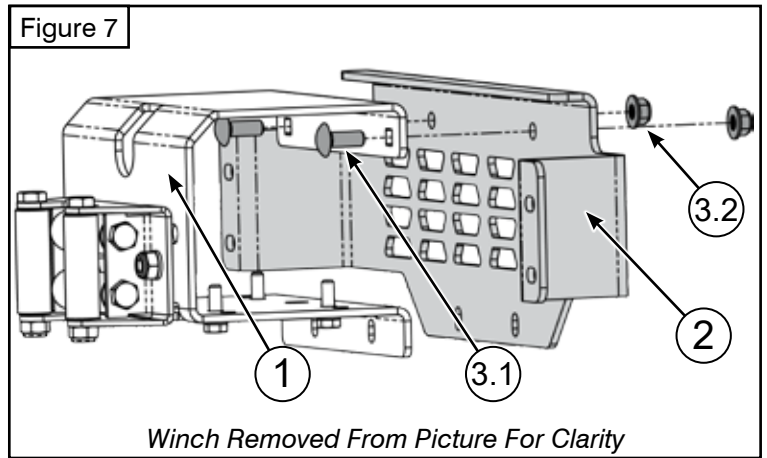
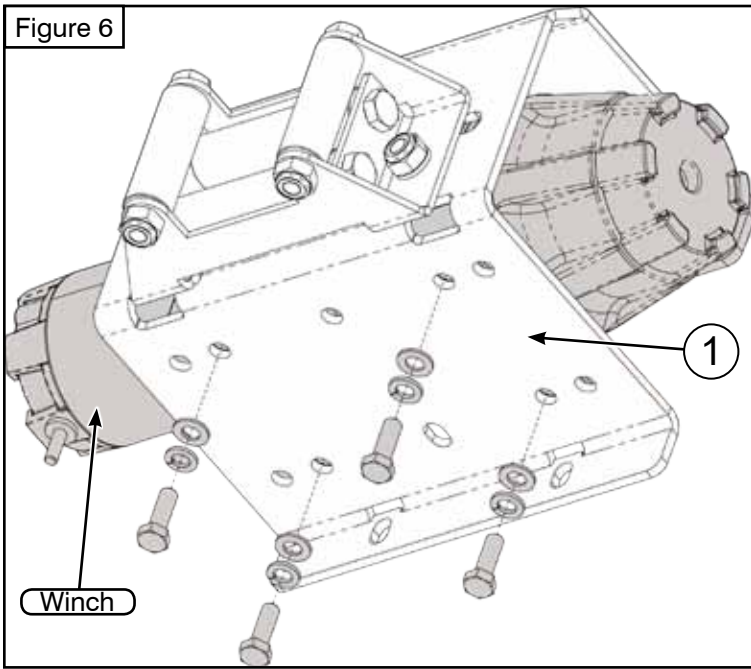

Wiring Information

Note: Follow your winch manual for proper winch wiring instructions.

7. As shown in **Figure 9**, you will see a false bottom under the hood of the machine. This should be removed to gain access for wiring the winch. Remove the 6 plastic push rivets (E) that hold this panel in place and set the panel aside for later.
8. Under the panel removed in step 7, you will find a wire connector located on the drivers side of the machine as shown in **Figure 10**. The red wire in this connector is activated by the ignition. You can tap into this wire for the ignition powered wire for your winch switch.
9. Once everything is wired up correctly and tested, you can put the false bottom back in place under the hood and secure with the 6 plastic rivets as shown in **Figure 9**. The bumper can be reinstalled with the 6 screws as shown in **Step 2**.

