

Honda Rancher/Foreman/Rubicon Winch Mount

Winch Mounting Bracket PART #102200

Kit Components:		
Item #	Qty.	Description
1	1	Winch Mount
2	1	Hardware kit
2.1	4	5/16"-18 x .75 Flange Bolt GR5
2.2	4	5/16"-18 Flange Nylock Nut
2.3	1	1/4"-20 x 2.00 Flange Bolt (Not Used)
2.4	1	1/4"-20 Flange Nylock Nut (Not Used)

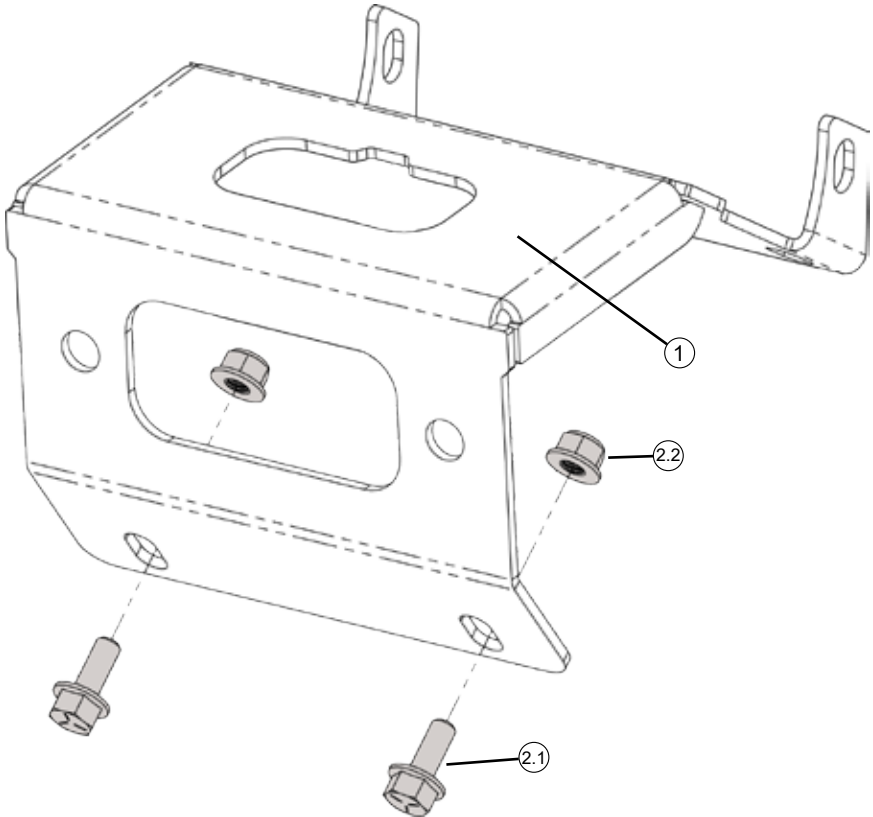

INSTALLATION INSTRUCTIONS

Note: Make sure all hardware needed to complete this mount is in the package. Thoroughly read through and understand the instructions before installing.

1. Loosen the skid plate by removing 2 Bolts (A) as shown in Figure 1.

Note: The skid plate doesn't need to be removed, it will flex enough that it won't be in the way once both bolts are removed.



2. Detach front bumper by removing 8 Bolts (B,C,D,E), and two nuts (as shown in Figure 2, and 3). Remove bumper from machine.

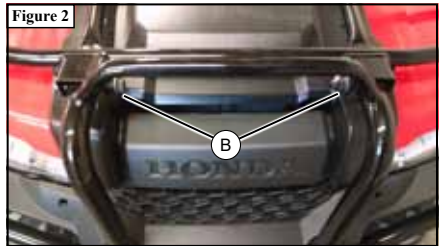

3. With bumper removed, place mount into position as shown in Figure 4. Align front lower mount holes with holes in the lower front bumper. Fasten mount to the lower frame rail using the Bolts (2.1) and Nuts (2.2), with nuts to the inside of the bumper, as shown in figure 5.

- **Make sure to leave this hardware (2.1, 2.2) as loose as possible so the back can be lined up easily, later.**

- Note: If you have a Superwinch Terra winch you will need to install the bolts from the back instead of the front, so that the nuts are on the outside of the machine



INSTALLATION INSTRUCTIONS

4. Install your roller fairlead or hawse to the mount plate using the hardware included with your winch. (See Figure 6)

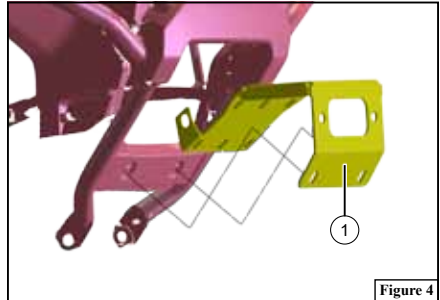

5. Install your winch to the mount plate using the hardware included with your winch (See Figure 7). Push the winch as far forward as you can and tighten bolts.

Note: Winch needs to be installed as shown in figure 7 so that the cable comes off the bottom of the winch. Some winches including the KFI winch may slightly touch the bumper brace.

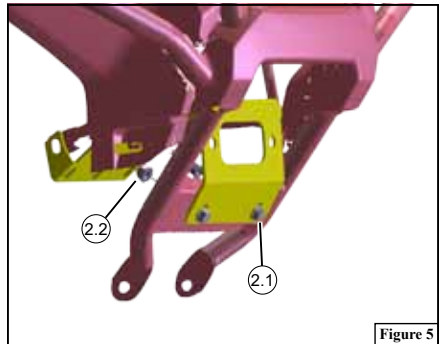

6. Reinstall the bumper and mount assembly. It is easiest to reinstall the bumper by installing the two long upper bolts first (See Figure 2). This allows the bumper to hang while you install the other 6 bolts.

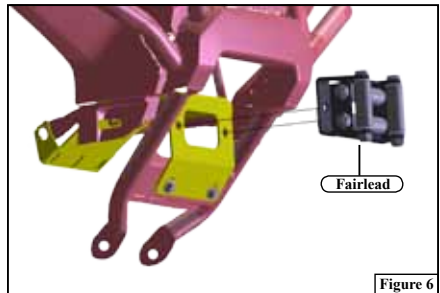

7. After the bumper is hanging, it is recommended to get all bumper bolts started before tightening. Once all 8 bumper bolts are started, all 8 bumper bolts can be fully tightened.

8. After bumper is completely tight, Bolts (2.1) from figure 5, can be fully tightened as well

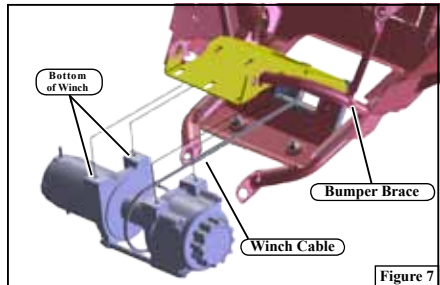

9. Before reinstalling the lower skid plate you may need to trim the plastic on the motor side to fit your winch. Trim the plastic, reinstall, and fully tighten the bolts removed in step 1.

WIRING INFORMATION

10. Use the instructions provided with your winch, wire accordingly.
11. For contactor location please see Figure 8. This is located behind the battery in the storage compartment. Keep in mind this is just a suggestion.
12. Find a location that suits your purposes for the mini-rocker switch and hand remote.
13. Mini Rocker red wire:

- Wire the red wire from the mini rocker to the ignition controlled wire (white) on the accessory plug as shown in Figure 10, using the supplied connector.
- For all other models wire the red wire from the mini rocker to the ignition controlled wire on the 12V accessory plug. See Figure 11.

