

WIDE FAIRLEAD SPACER KIT

Winch Accessory

PART #102290 Rev A

Kit Components:

Item #	Qty.	Description
1	2	Wide Fairlead Spacer (101704)
2	1	Hardware Kit HK-354
2.1	2	3/8"-16 x 1.75 Hex Bolt Flange
2.2	2	3/8"-16 Hex Nut Flange Nylock

NOTE: Make sure all hardware needed to complete this mount is in the package. Thoroughly read through and understand the instructions.

NOTICE

Torque bolts to ANSI Specs (or OEM specs if applicable), unless otherwise stated. After the first use and at the start of each season, check torque.

This product is designed to provide the necessary clearance for mounting a wide roller fairlead on bumpers whose design prevents standard installation.

INSTALLATION INSTRUCTIONS

1. Insert hex bolts through the roller fairlead and through either one or both fairlead spacers in location **(A)** on *Figure 1*. Each spacer provides 1/4" of clearance.
2. Guide the roller fairlead onto the mounting location on the bumper.
3. Secure the bolts using nuts provided and tighten evenly. *Figure 2*

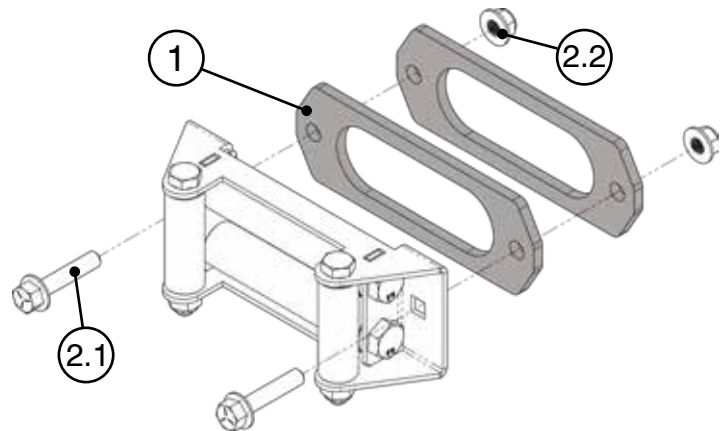

Figure 1

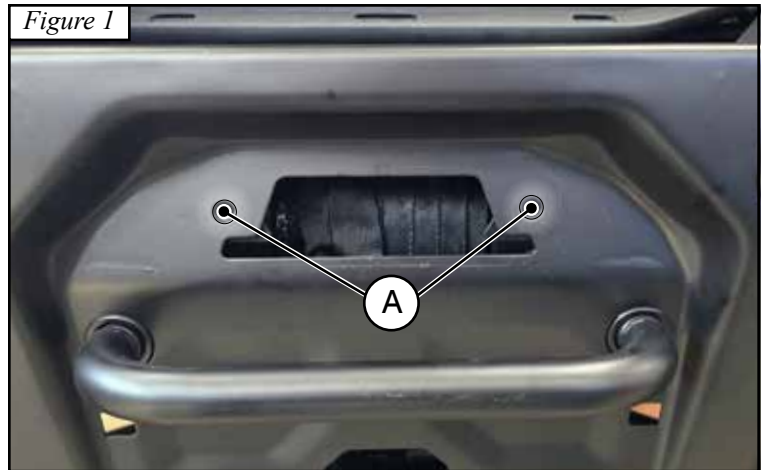

Figure 2

