

# KAWASAKI TERYX KRX

Plow Mount      PART #106295

Kit Components:		
Item #	Qty.	Description
1	1	Plow Mount
2	1	Hardware Kit (HK-372)
2.1	2	3/8"-16 x 2.75 Hex Flange Bolt
2.2	6	3/8"-16 x .88 Hex Flange Bolt
2.3	4	3/8"-16 Hex Flange Nylock Nut

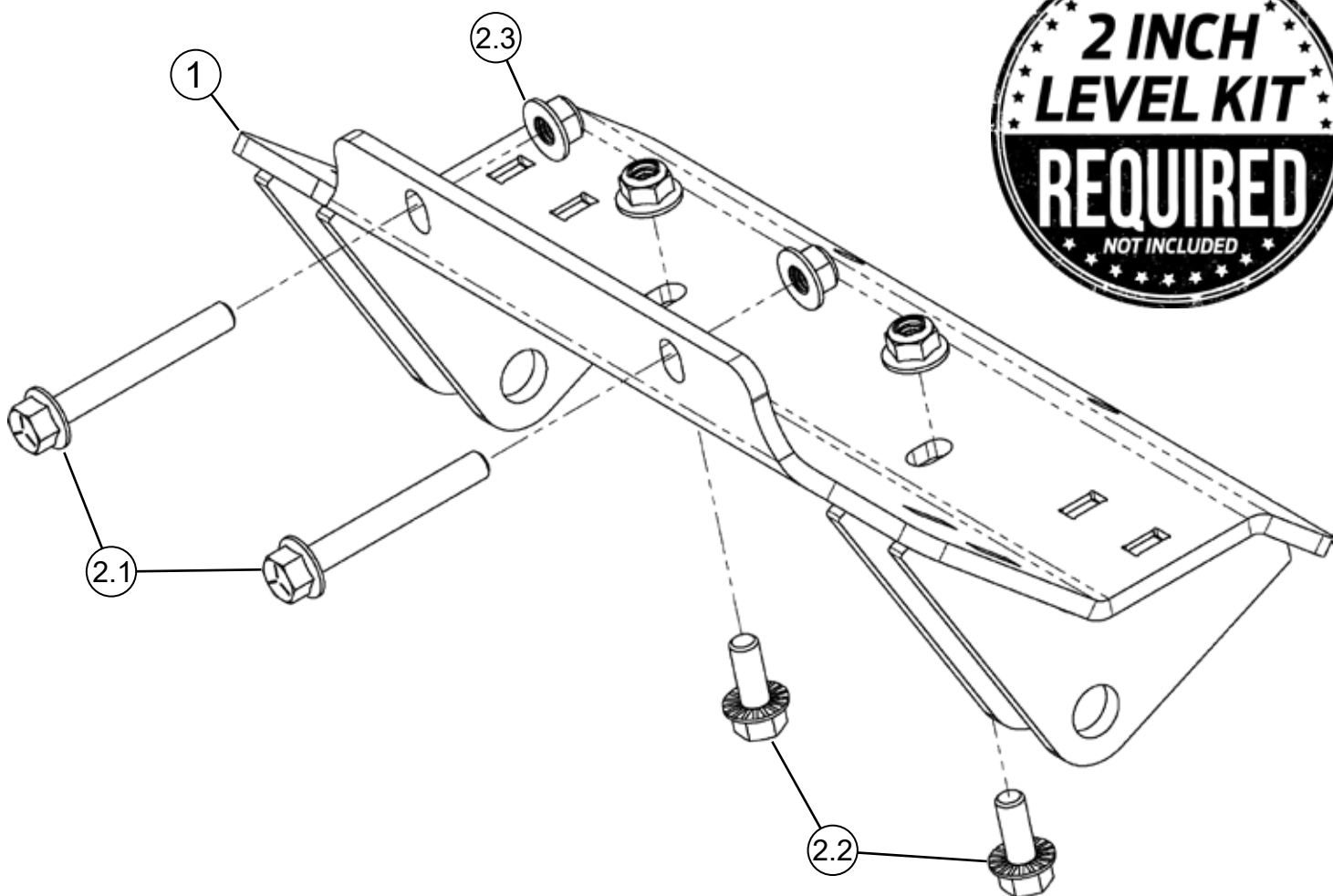

# INSTALLATION INSTRUCTIONS

**Note:** Make sure all hardware needed to complete this mount is in the package. Thoroughly read through and understand the instructions before installing.

**Note:** This machine does not require the included 2" leveling kit. See page 3 for installation instructions.

1. Hold plow mount (1) in place lining up holes in plow mount (1) to frame holes (A) as shown in **Figure 1 & 3**.

**Note:** If the winch mount is installed prior to the plow mount, removal of bolts (C) will be required before installing plow mount (1) as shown in **Figure 2**.

2. Loosely install front bolts (2.1) and nuts (2.3). While holding the plow mount (1) into place, mark holes (B) on the machine using the plow mount as a template. Drill the marked holes using a 13/32" drill bit. Secure bottom of plow mount (1) using bolts (2.2) and nuts (2.3) as shown in **Figure 3**.

3. Tighten all hardware evenly.

