

EAR SPACER KIT

Plow Accessory

PART #106380 Rev A

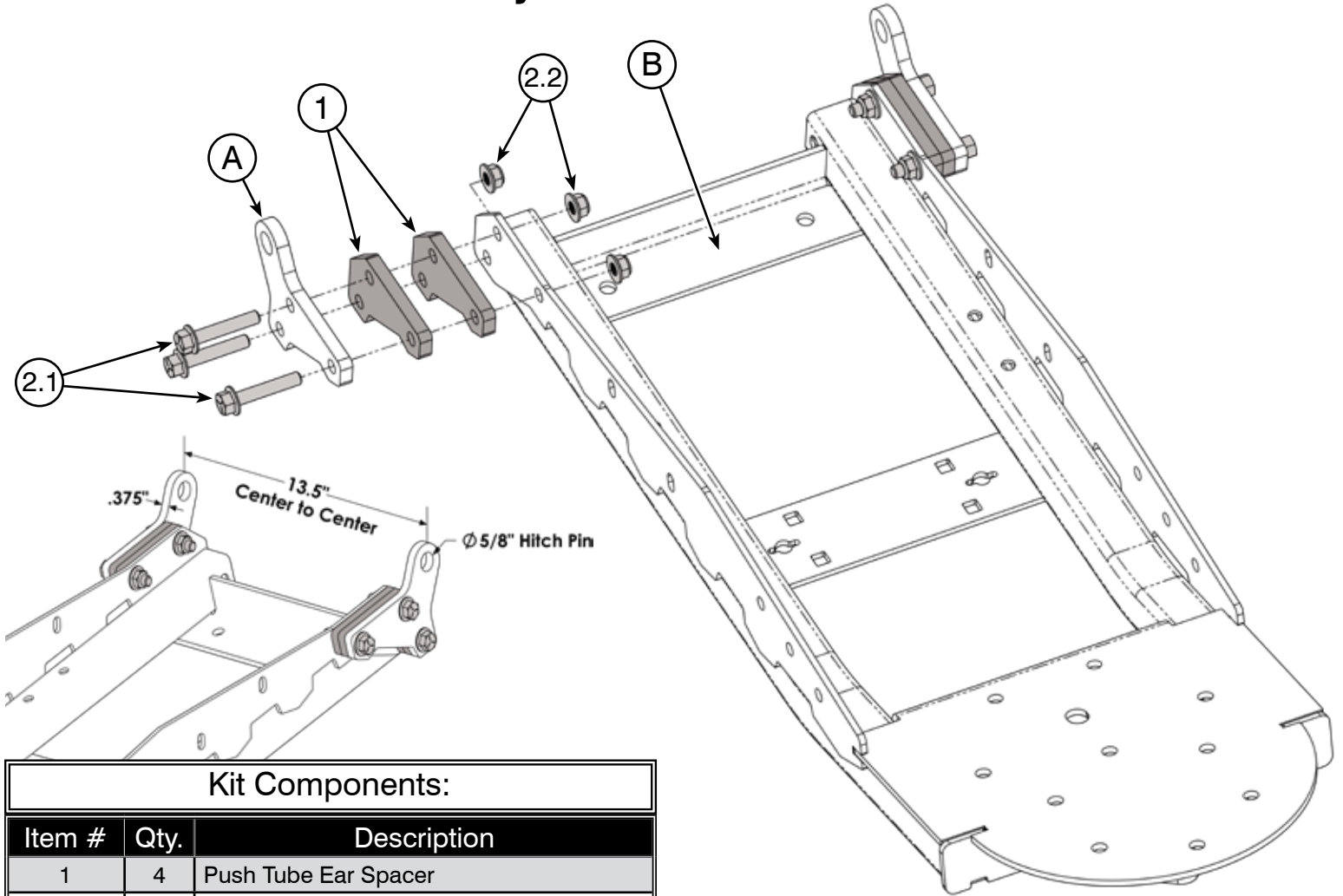

Kit Components:		
Item #	Qty.	Description
1	4	Push Tube Ear Spacer
2	1	Hardware Kit HK-440
2.1	6	3/8"-16 X 2.00 Hex Bolt Flange GR5 Serr.
2.2	6	3/8"-16 Hex Nut Flange Nylock GR5

Note: Make sure all hardware needed to complete this mount is in the package. Thoroughly read through and understand the instructions before installing.

Installation Instructions

1. If already installed, Remove Ears (A) from both sides of Push Tubes (B) and discard original hardware (not shown).
2. Install Ear (A) and 2 Spacers (1) onto each side of the pushtubes as shown in the Exploded Diagram above. Secure with Hardware (2.1 & 2.2).
3. Tighten Hardware to 31 ft/lbs. This hardware should be checked occasionally.

