

MASSIMO/BENNCHE T-BOSS

Plow Mount

PART #106525 Rev A

Kit Components:

Item #	Qty.	Description
1	1	Plow Mount (106526)
2	1	12" Soft Strap (106470)
3	1	Hardware Kit (HK-423)
3.1	2	3/8"-16 X 1.00" Hex Nut Flange GR5 Serrated
3.2	2	3/8"-16 X 2.00" Hex Nut Flange GR5 Serrated
3.3	2	3/8"-16 Flat Washer
3.4	4	3/8"-16 Hex Nut Flange Nylock GR5
Not Used	2	3/8"-16 X 1.25" Hex Nut Flange GR5 Serrated

Note: Make sure all hardware needed to complete this mount is in the package. Thoroughly read through and understand the instructions before installing.

Installation Instructions

1. All 4 holes must be drilled to install this mount. Not all hardware will be used.

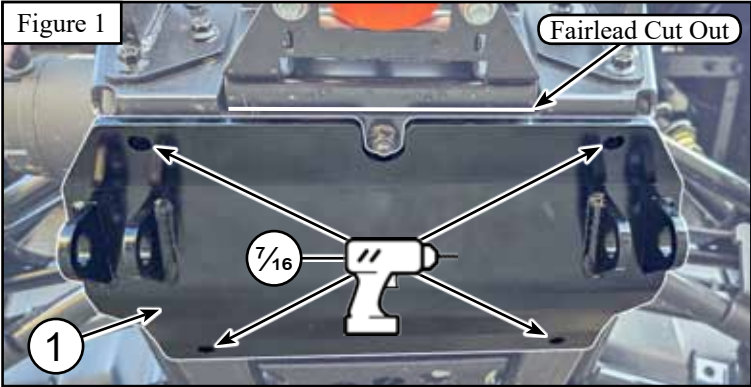

2. The front of the *Plow Mount* (1) must be held flush against the front of the winch mount *Fairlead Cut-Out* as shown in **Figure 1**.
3. While holding the mount in place, mark all 4 holes with a center punch, or a paint pen.
4. Remove *Plow Mount* (1) from the machine and drill the 4 marked holes as straight as possible, with a 7/16" drill bit. Be careful not to drill too deep for the front holes or you could damage the winch. The rear holes must go completely through both walls of the frame. See **Figure 1**.

5. Once all 4 holes are drilled, install *Bolts* (3.1) in the front, secure with *Nuts* (3.4) and install *Bolts* (3.2) in the rear, secure with *Flat Washers* (3.3) and *Nuts* (3.4). See **Exploded Drawing & Figure 2**.

6. Tighten all hardware evenly.

7. The 12" *Soft Strap* (2) should be attached to the *Bumper* as shown in **Figure 3**. The winch cable should go through the pulley as shown on the back page, and connect back to the *Soft Strap* (2).

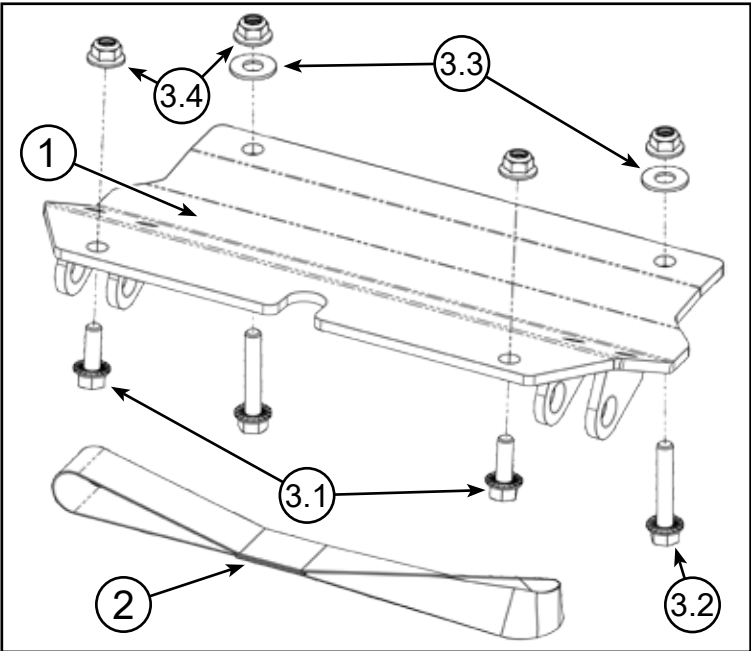

Note: See back of page for pulley use.

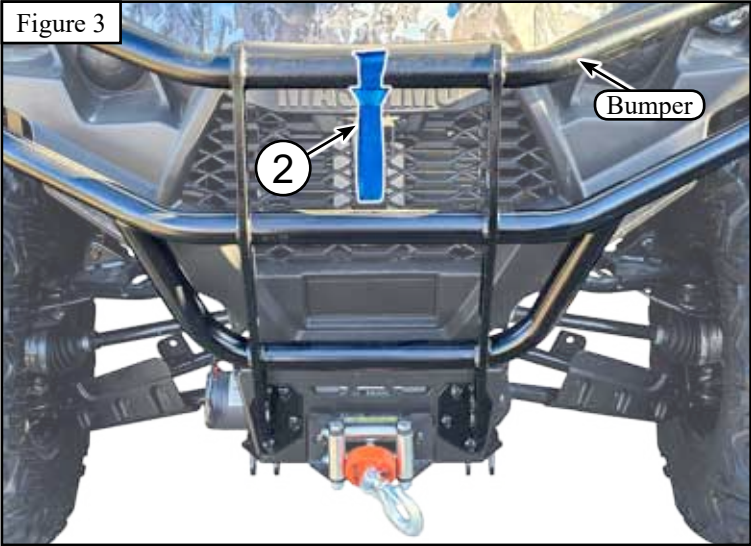
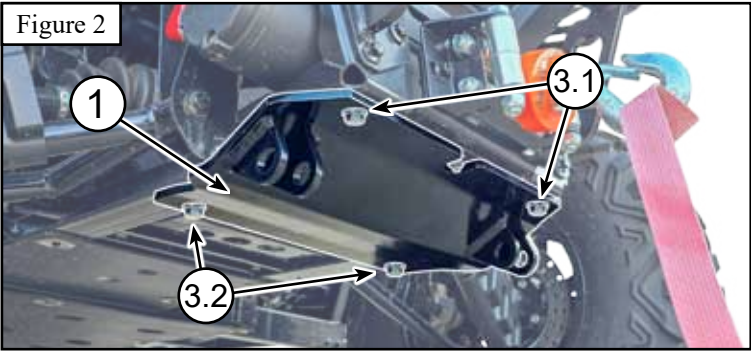



THIS MOUNT RECOMMENDS A PLOW PULLEY

SYNTHETIC ROPE PLOW FAIRLEAD PULLEY

- ALUMINUM ROLLER
- STANDARD OR WIDE

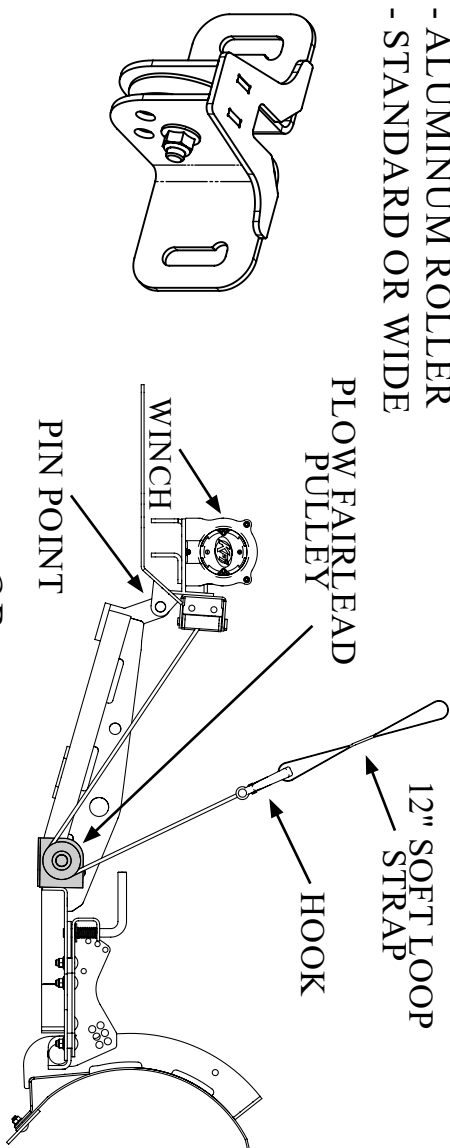

OR

STEEL CABLE PLOW FAIRLEAD PULLEY

- RECOMMEND A PULLEY AT THE WINCH AS WELL AS PUSH TUBE.
- VIEW EXAMPLE BELOW.
- STEEL ROLLER
- STANDARD OR WIDE

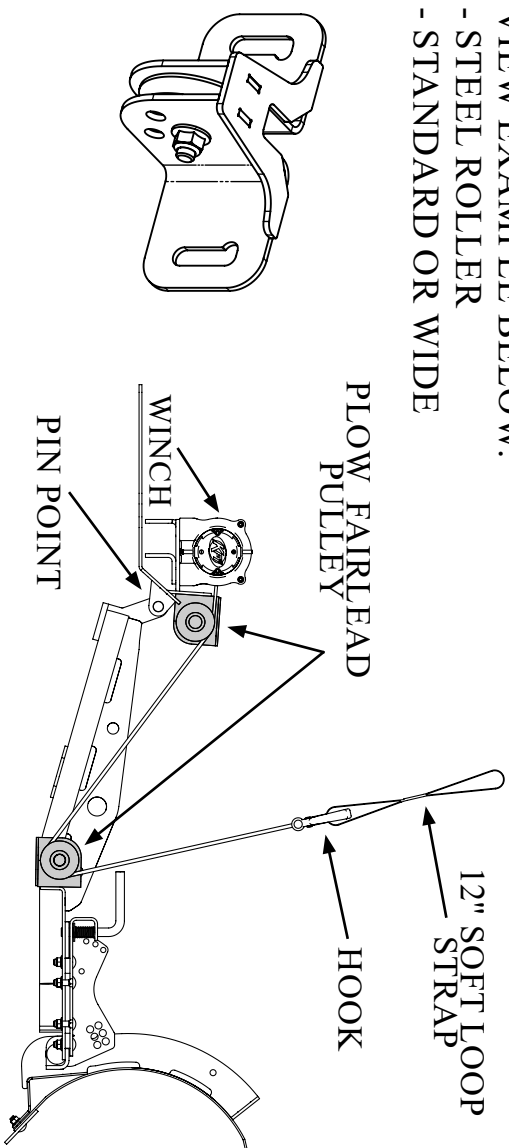

WHY USE A PULLEY?

WHEN THE WINCH FAIRLEAD AND PLOW PIN POINT ARE CLOSE TO EACH OTHER, IT CREATES A SHALLOW LIFTING ANGLE. BY ADDING A PULLEY, YOU ARE CHANGING THE WINCH ANGLE TO A MORE VERTICAL LIFTING POSITION. THIS WILL PROVIDE LESS STRAIN ON THE WINCH AND ENTIRE PLOW SYSTEM.

POSSIBLE POSITIONS

STANDARD FAIRLEAD PULLEY REQUIRED FOR ALL PUSH TUBE APPLICATIONS

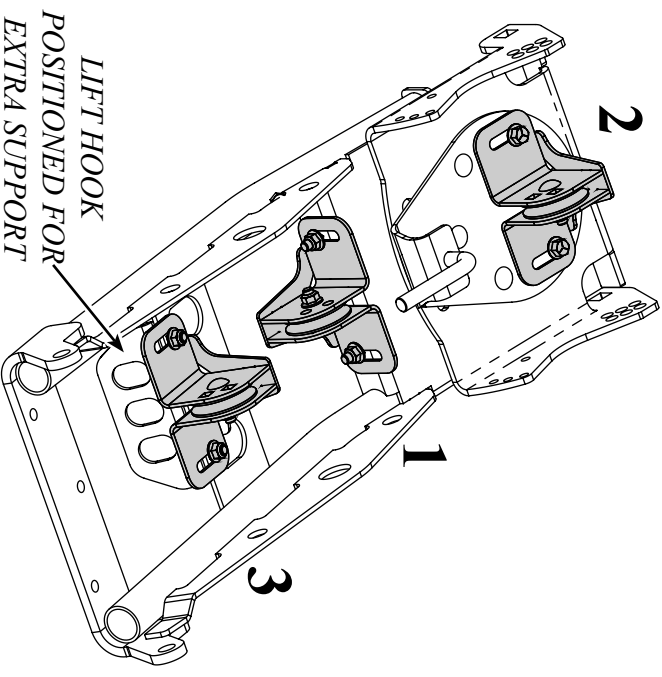

12" SOFT LOOP STRAP WRAPS AROUND BUMPER OR SOLID ANCHOR POINT ABOVE THE PULLEY.