

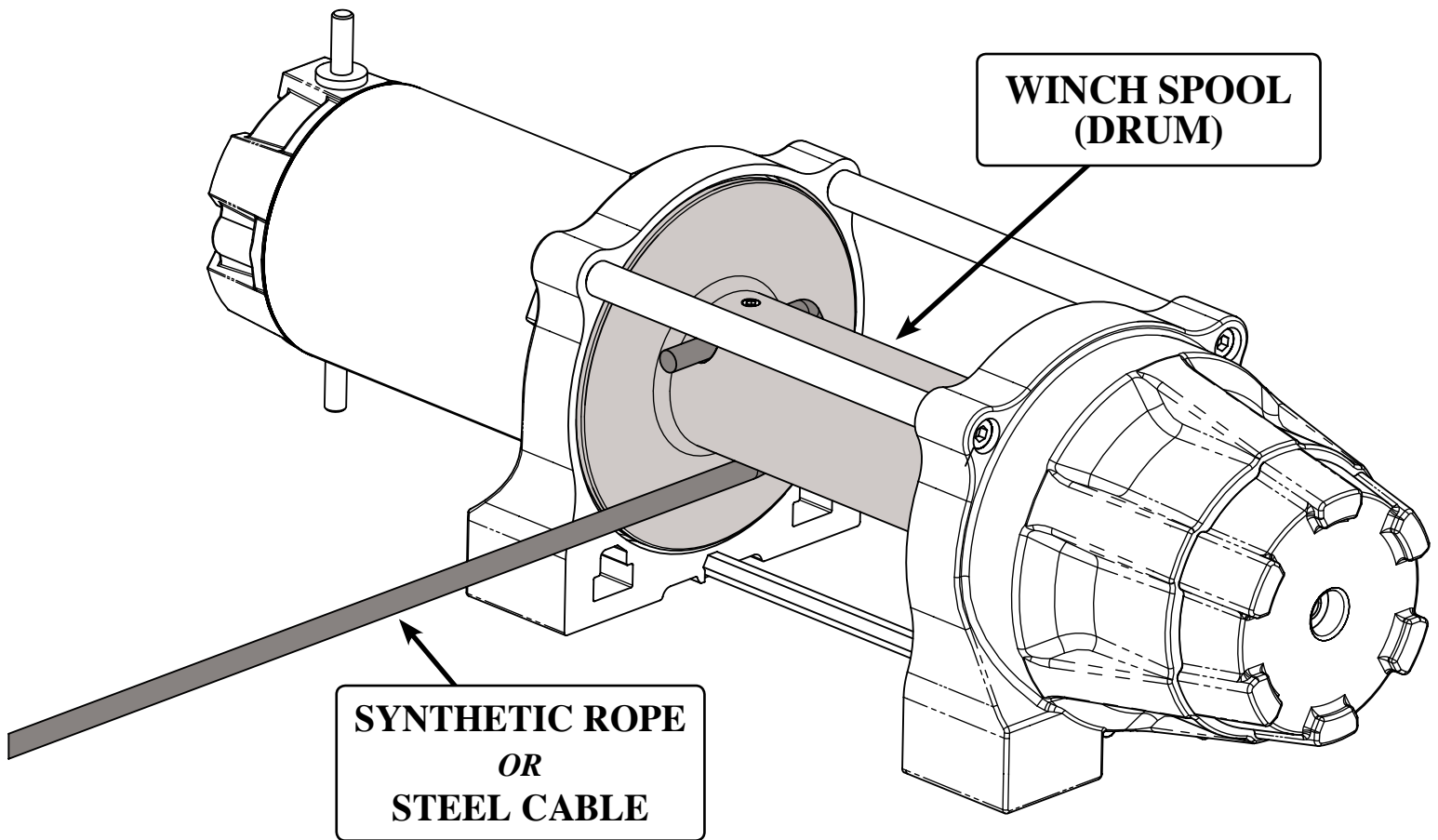

SYNTHETIC ROPE AND STEEL CABLE INSTALL GUIDE



THIS STEP BY STEP GUIDE WILL EXPLAIN HOW TO INSTALL *SYNTHETIC ROPE* OR *STEEL CABLE* ONTO A WINCH SPOOL.

TOOLS NEEDED:

- *ALLEN WRENCHES*
- *PHILLIPS SCREWDRIVER*
- *PLIERS*
- *ANY TOOLS TO HELP GAIN ACCESS TO WINCH*

!!! IMPORTANT !!!

ACCESS TO WINCH IS REQUIRED FOR THIS TO BE DONE. FAIRLEAD AND OTHER COMPONENTS MAY BE REMOVED TO MAKE IT EASIER. IF NEEDED, REMOVE THE WINCH FROM MACHINE FOR MORE ROOM.

THINGS TO NOTE BEFORE REPLACEMENT

When looking for replacement cable or rope, make sure the cable and rope specs work for the winch it is going on. See below:

What to consider:

- **Steel cable or synthetic rope diameter**
- **Length of cable or rope (wide or standard winch)**
- **Recommend a winch rope with 1.5x the break strength of the winch (Ex. 4000 lb winch -- Rope break strength should be at least 6000 lbs)**

Synthetic Rope:

- High strength SK75 Dyneema
- Safe and easy to handle
- No binding or sharp frays
- Lighter than steel cable
- Less velocity if it breaks compared to steel cable



Steel Cable:

- Super Duty galvanized cable
- Cheaper than synthetic rope
- Less vulnerable to sunlight and water compared to synthetic rope



If deciding to switch to synthetic rope from steel cable, KFI also recommends replacing the spool on the winch to steel instead of aluminum. This is to prevent the possibility of the synthetic rope breaking the aluminum spool. If going to steel cable from synthetic, the steel spool will work fine with the steel cable.

REMOVING THE OLD CABLE OR ROPE

1. Before removing the cable or rope, take a picture or make note of how it comes off the spool of the winch. (Direction and orientation of how the winch is in the machine.) This will help later when making sure the new rope or cable is on the same way as it previously was.

NOTE: When replacing the rope or cable, sometimes it may be easier to take the winch out of the machine to have more room to work with. It can also be done in the machine if it is easily accessible.

*This winch is positioned upside down and comes off the bottom of the winch. Take a picture to be sure the new rope or cable is attached the same way. **The rope or cable should always come out between the winch spool and the mounting surface.***

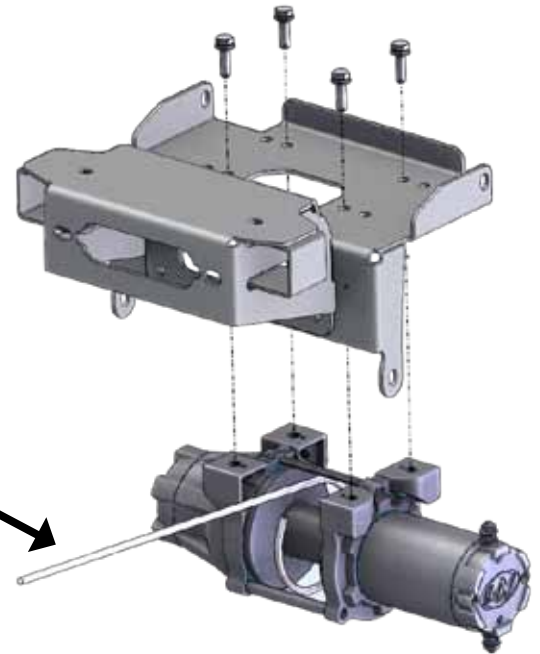

2. To remove the old rope or cable from the winch, put the winch into freespool mode. Pull the rope or cable until it bottoms out on the spool. If working with steel cable, be sure to wear gloves to prevent damage to your hands.

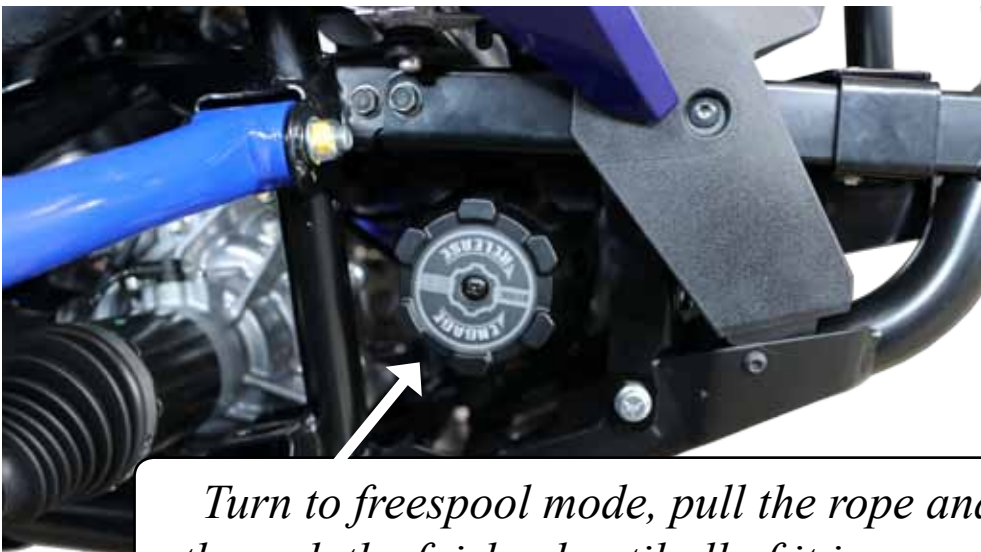

Turn to freespool mode, pull the rope and cable through the fairlead until all of it is removed from the spool. It should now be possible to see how it is attached to the spool.



3. Once the rope or cable is bottomed out, look to see how it is connected to the winch spool. It may be helpful to take another picture or some notes to make sure the new rope or cable gets connected in the same way. There are multiple ways that it may be connected to the spool. Below are some examples of the most common ways and how to remove them.

Remove set screw and pull rope or cable through hole.

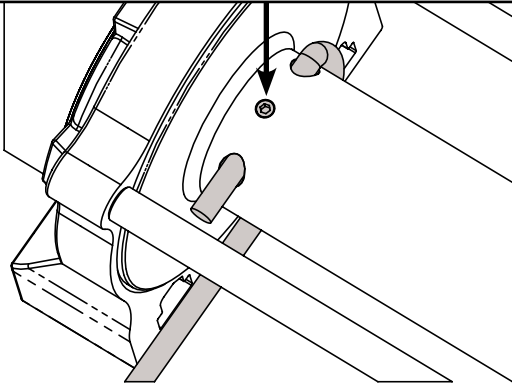

Cut or undo knot, pull rope through the hole.

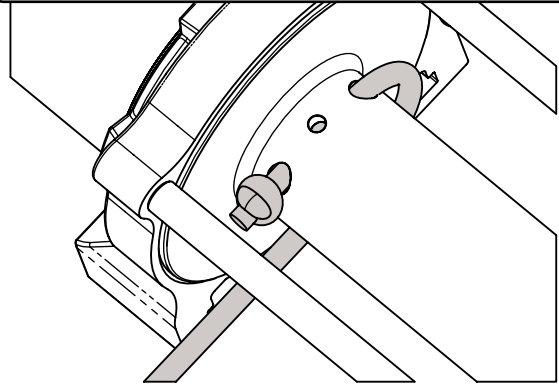

Remove screw, take off rope or cable.

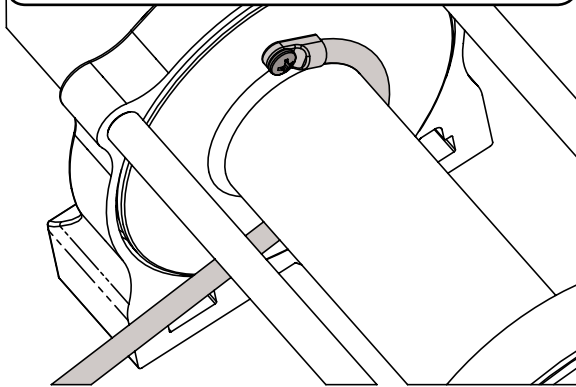

Remove screw, take off rope or cable.

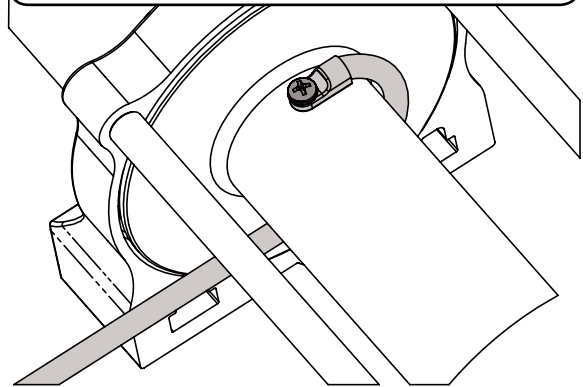

Push the cable loop towards larger open end of the cut out, remove the bead, pull cable through the hole.

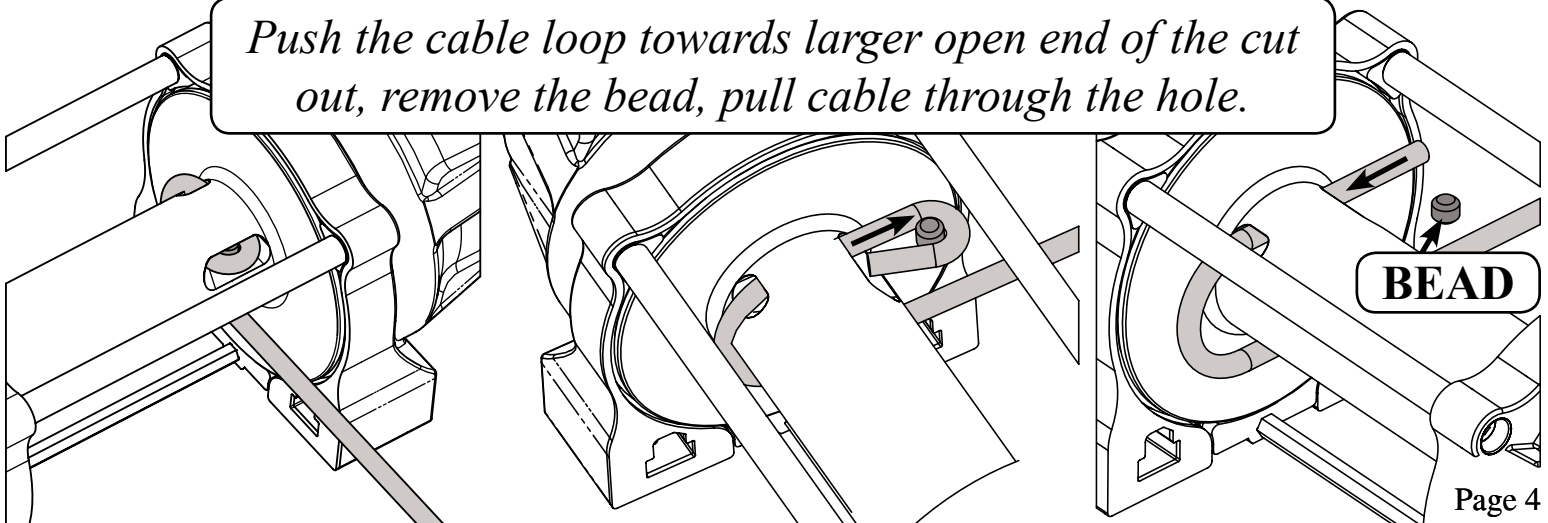

4. After the rope or cable is removed, examine the spool to make sure there are no cracks, burs, or any other possible damage. Now is also a great time to clean the leads on the winch to prevent corrosion. It may also be a good idea to check the winch bolts to be sure they are still tight.

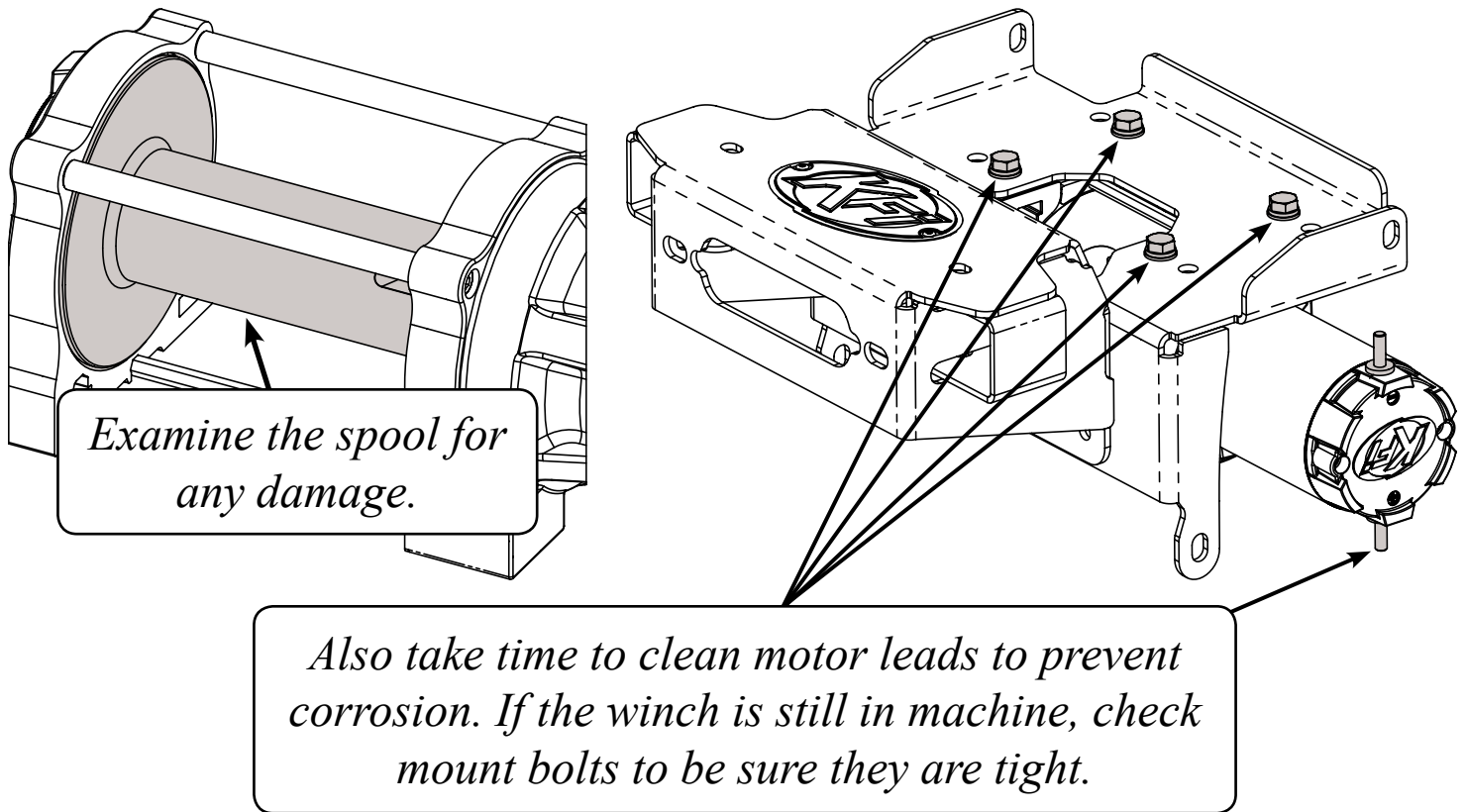

5. Take the new rope or cable and determine if the terminal connection is needed on the end. If not needed, cut it off just behind the connector. With synthetic rope, it may be easier to remove a few strands from end of the rope. Once removed, wrap tightly with black electrical tape. This makes it easier to get started in the hole on the winch spool. See below for example.

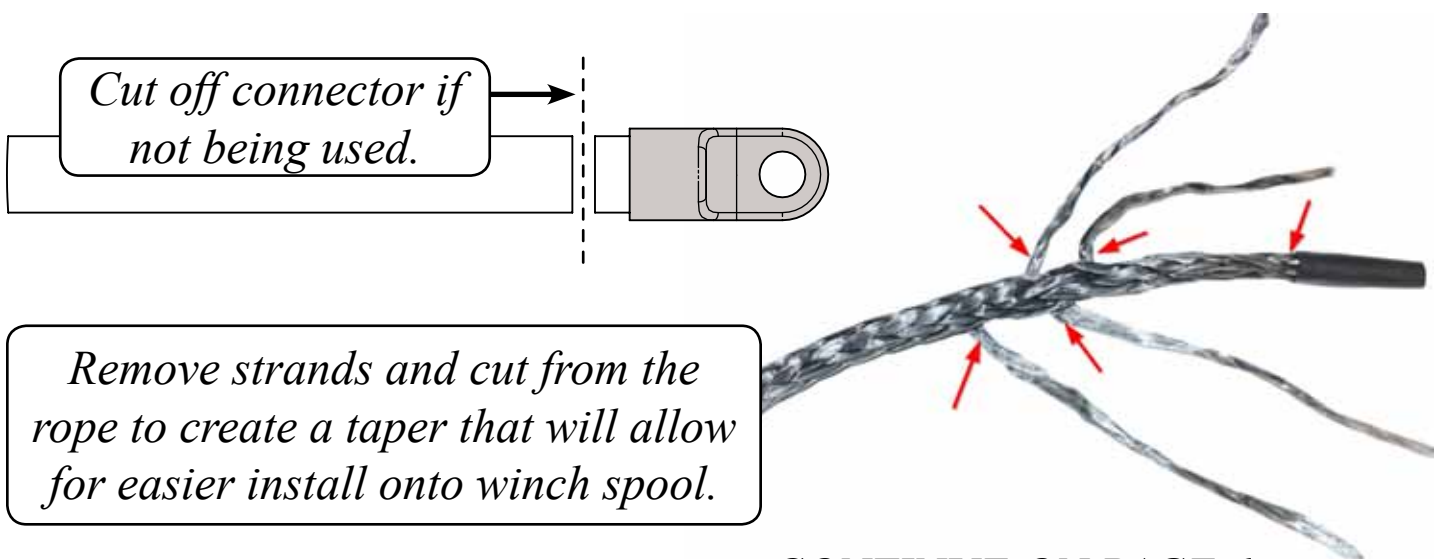

CONTINUE ON PAGE 6

Wrap end with black tape once strands are removed.

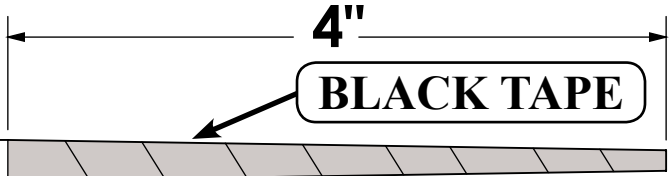

6. Look at the previous pictures and/or notes. Connect the rope or cable to the spool using the the same technique as before or one of the ways below. There are many possible ways to attatch rope or cable to a winch, choose one that works best for the winch that it is being installed on.

Notice the kink in the cable or rope shown in the BAD image below. This kink creates a weak point. The GOOD image shows how the rope or cable should be wrapped around the spool. Notice how it creates a larger radius. Less kinks = longer life for rope or cable.

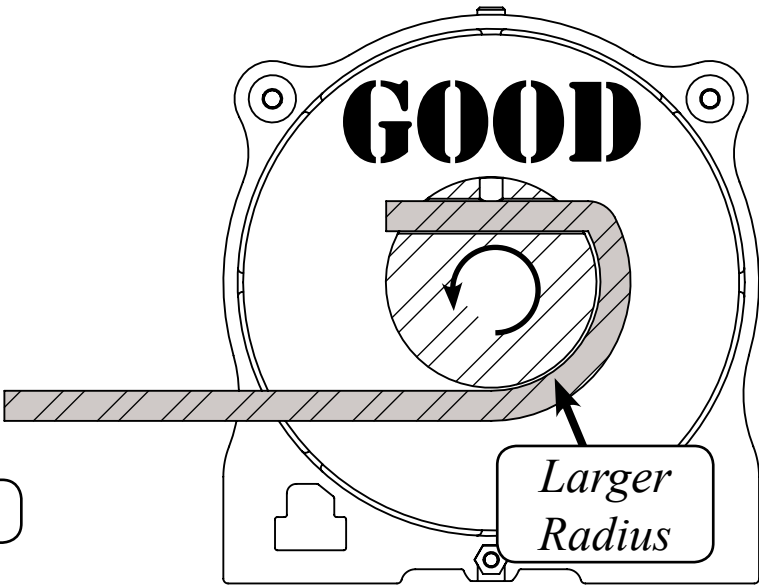
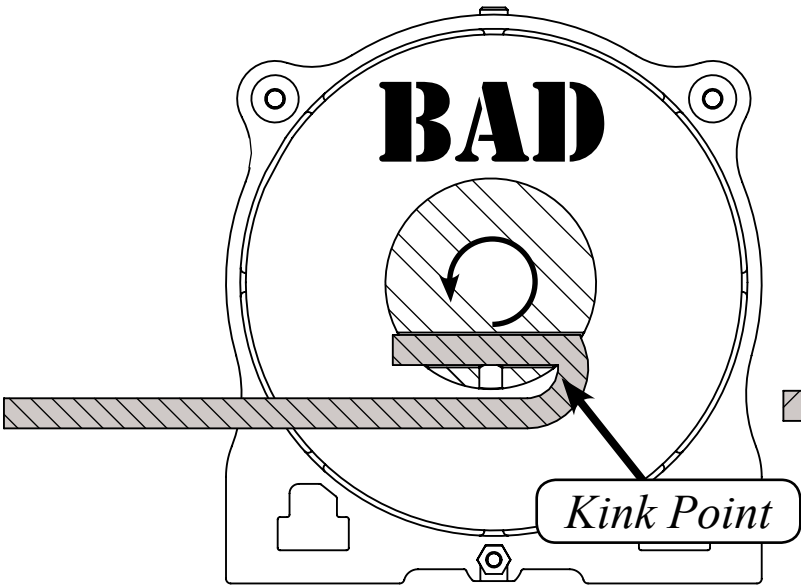

Place rope or cable through hole, tighten set screw.

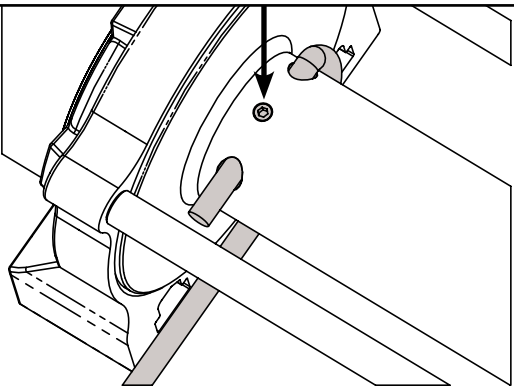

Place rope through hole, tie knot near end of rope.

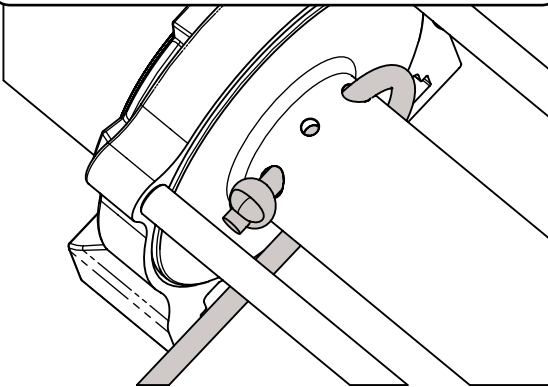

Place cable through hole, loop cable back around the bead and push back into the spool. make sure bead is in place, and pull tight to keep in place.

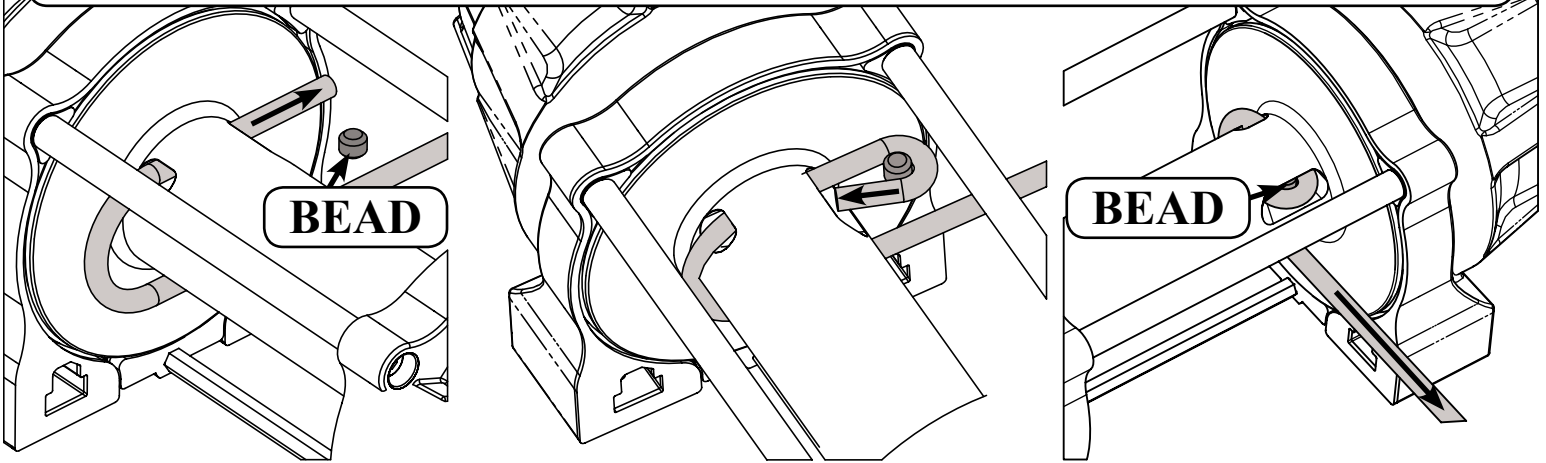

Run rope around the spool and through hole (Step 1 and 2), then wrap rope around the spool again near the inner edge of the spool (3 and 4).

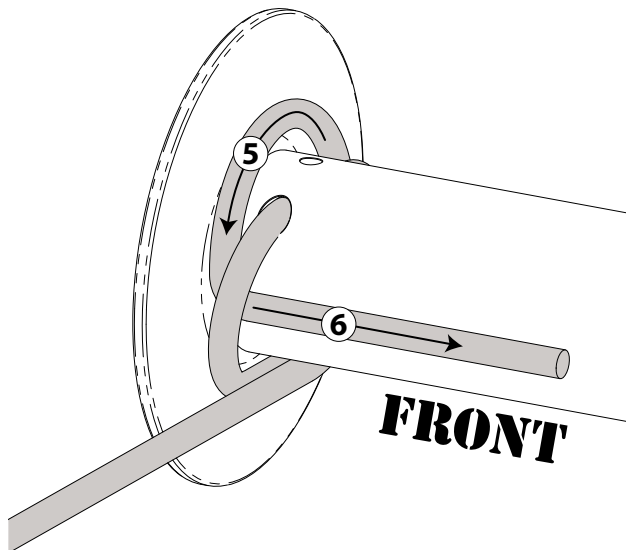
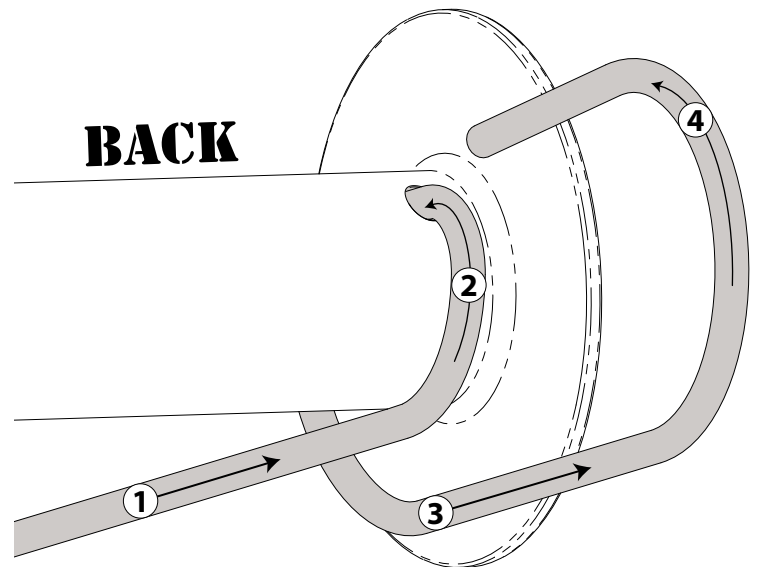
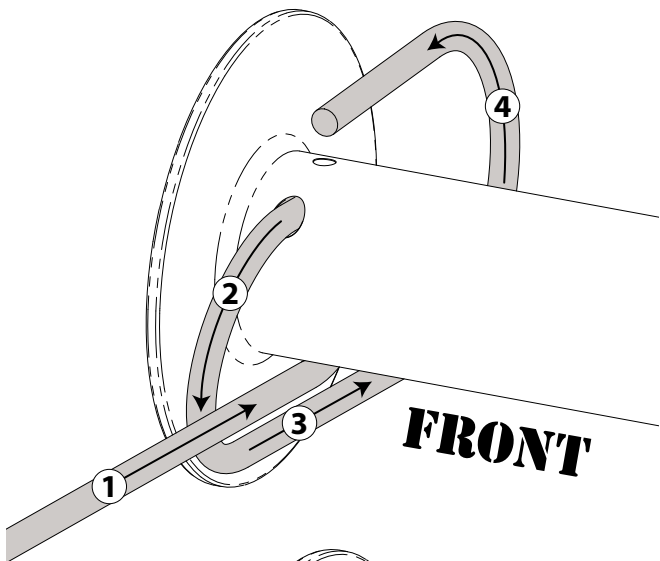

Continue to wrap rope around the inner edge of spool (5). Route the rope underneath the loop created in Step 2. Pull loops tight and remove all slack.

Place screw through connector and tighten to side of spool.

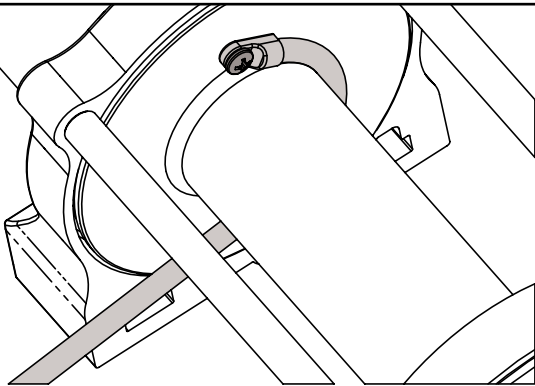

Place screw through connector and tighten to center of spool.

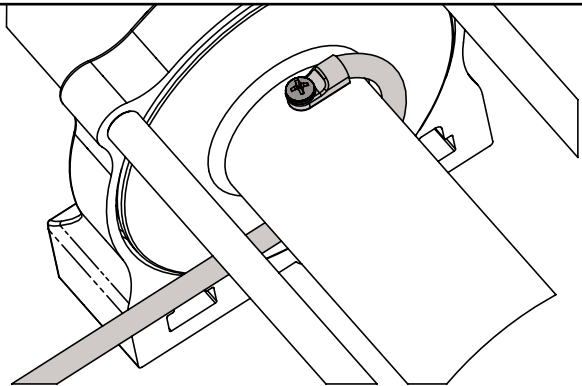

7. Once the rope or cable is attached, it can start to be wrapped around the spool. If the winch is out of the machine, reinstall while making sure all winch bolts and wires are tight. Feed rope or cable through fairlead opening on machine. Take the winch out of freespool mode. With help from another person or a hand remote, press (IN) on the winch. Follow the images below for correct spooling method.

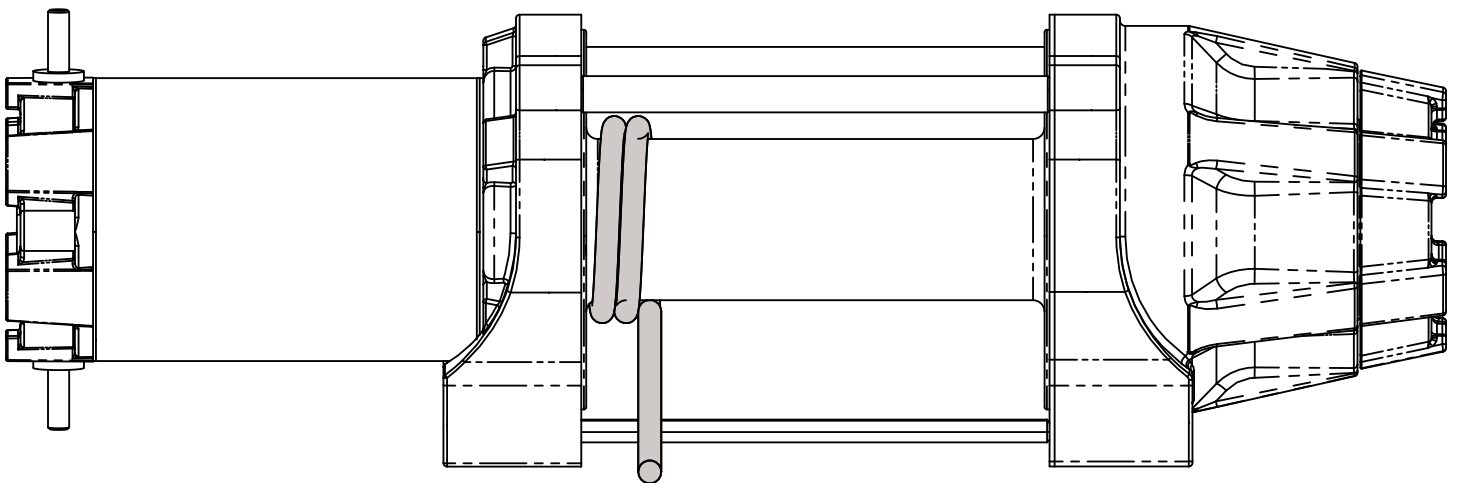

*When spooling, keep coils tight together to ensure a good wrap.
Pull the rope or cable tight to keep tension while spooling*

Once it reaches the opposite side of the spool, start to work the other direction. Repeat the process until there is 3 feet of rope or cable remaining.

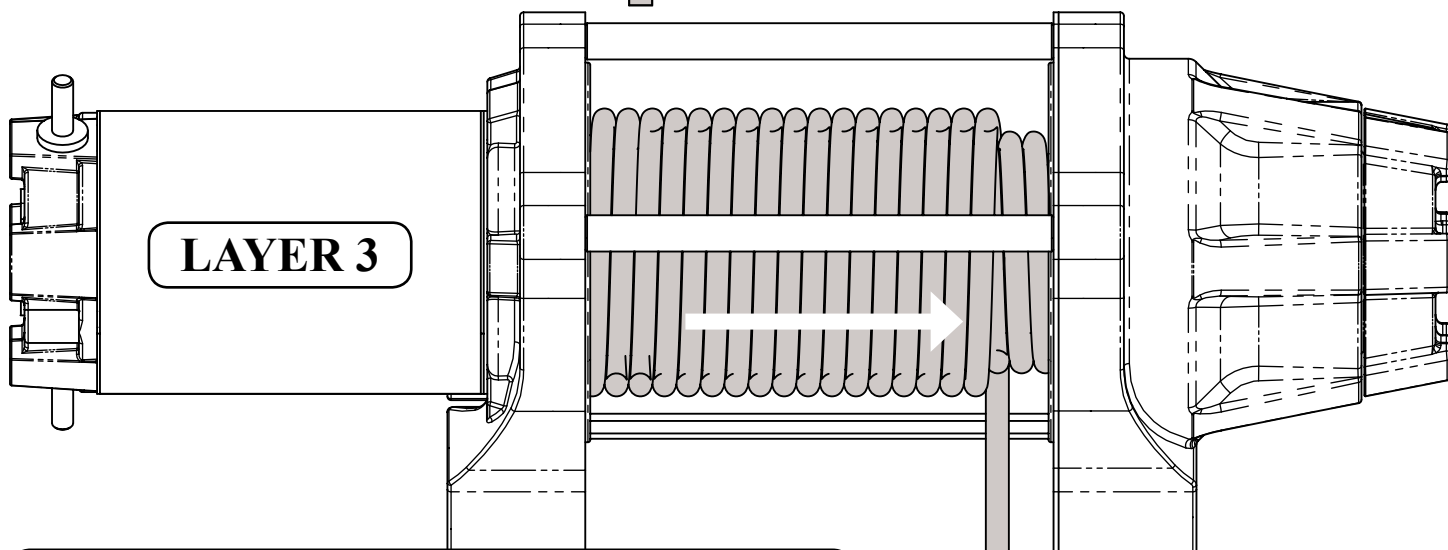
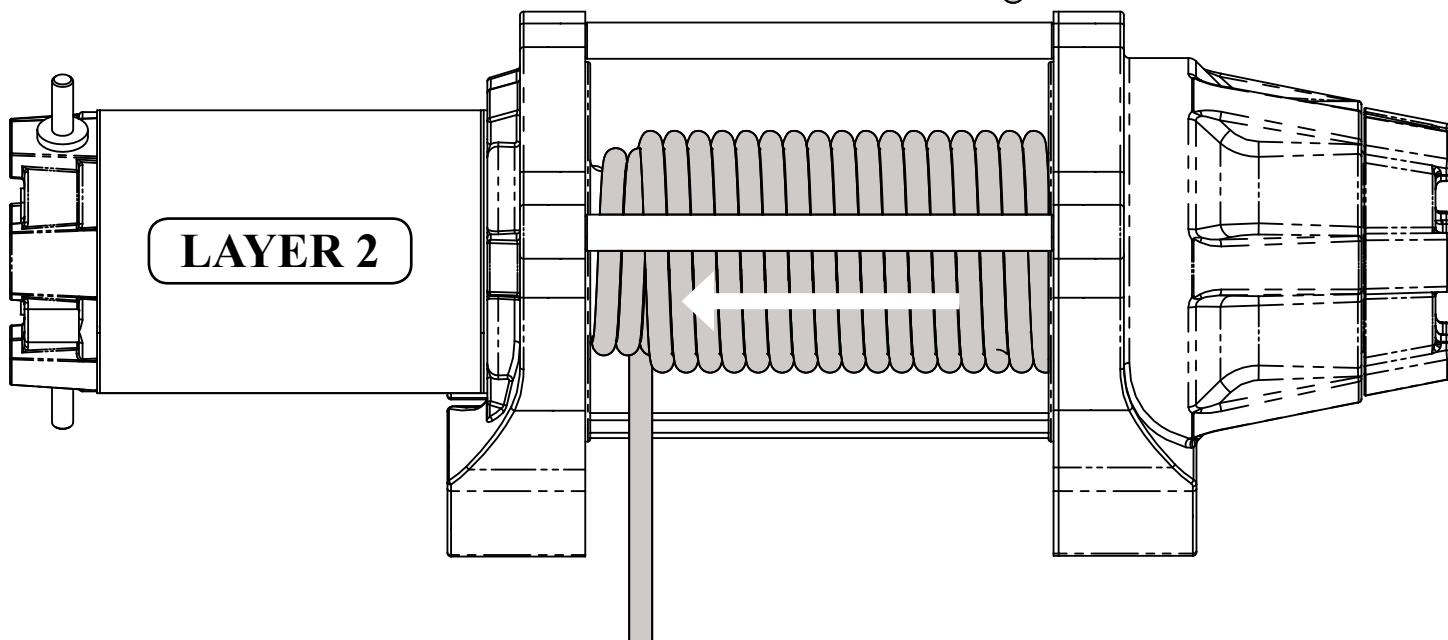
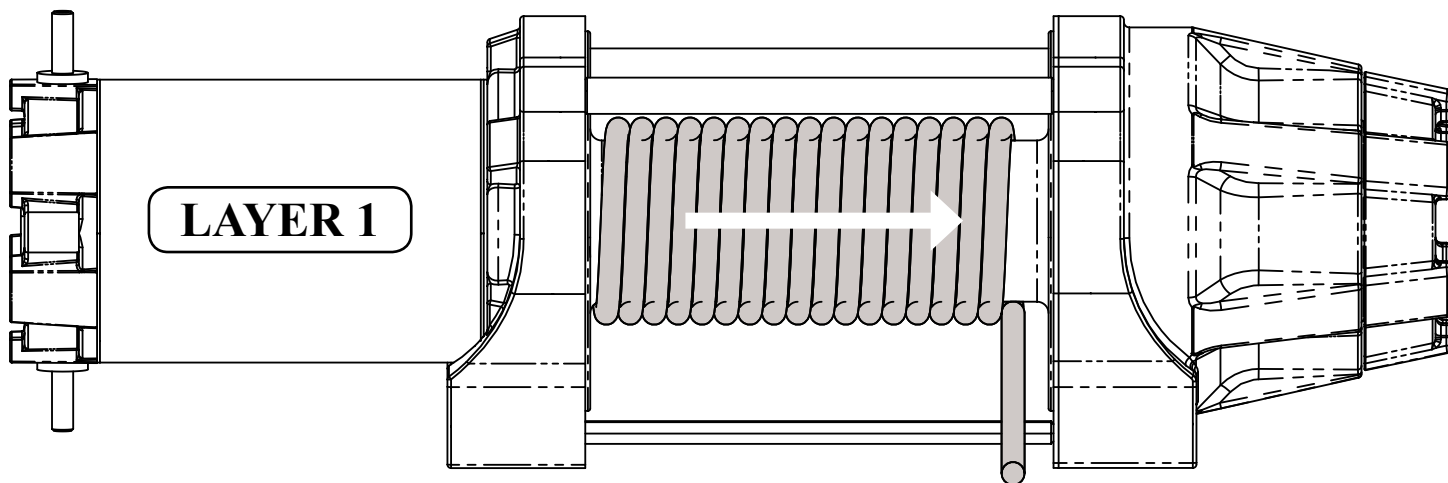

Once there is 3 feet left to spool, stop the winch and move onto step 8.

8. Make sure the rope or cable is fed through any openings on the winch mount or on the machine. Feed the rope or cable through fairlead bracket and tighten fairlead bolts.

Be sure winch rope or cable is ran through any openings on the winch mount before connecting fairlead.

View image →



NOTE: Do not install hook or hook stop until the rope or cable is through the fairlead bracket.



Once rope or cable is ran through fairlead bracket, bolt into place.

← *View image*

9. Remove the hook from previous rope or cable and place onto the new one. Make sure the cotter pin is bent to keep the pin from falling out. If using a hook stopper, it can also be added at this time.

Make sure cotter pin is bent around pin to hold it from coming apart.

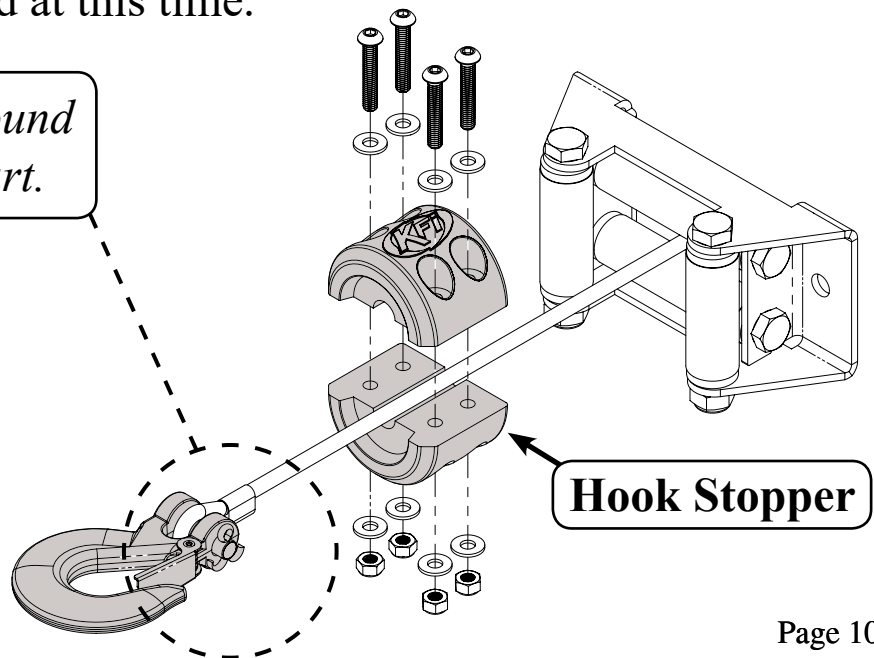
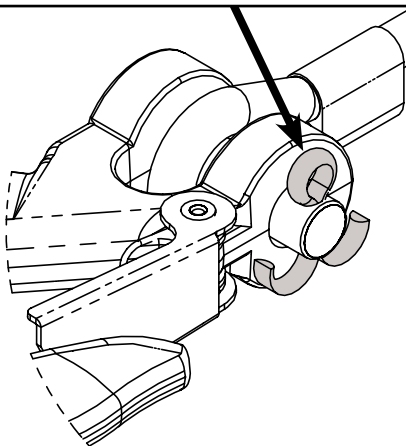

10. After installing fairlead bracket, hook, and hook stopper, spool the rest of the rope or cable up to the fairlead bracket. Don't forget the KFI handsaver!

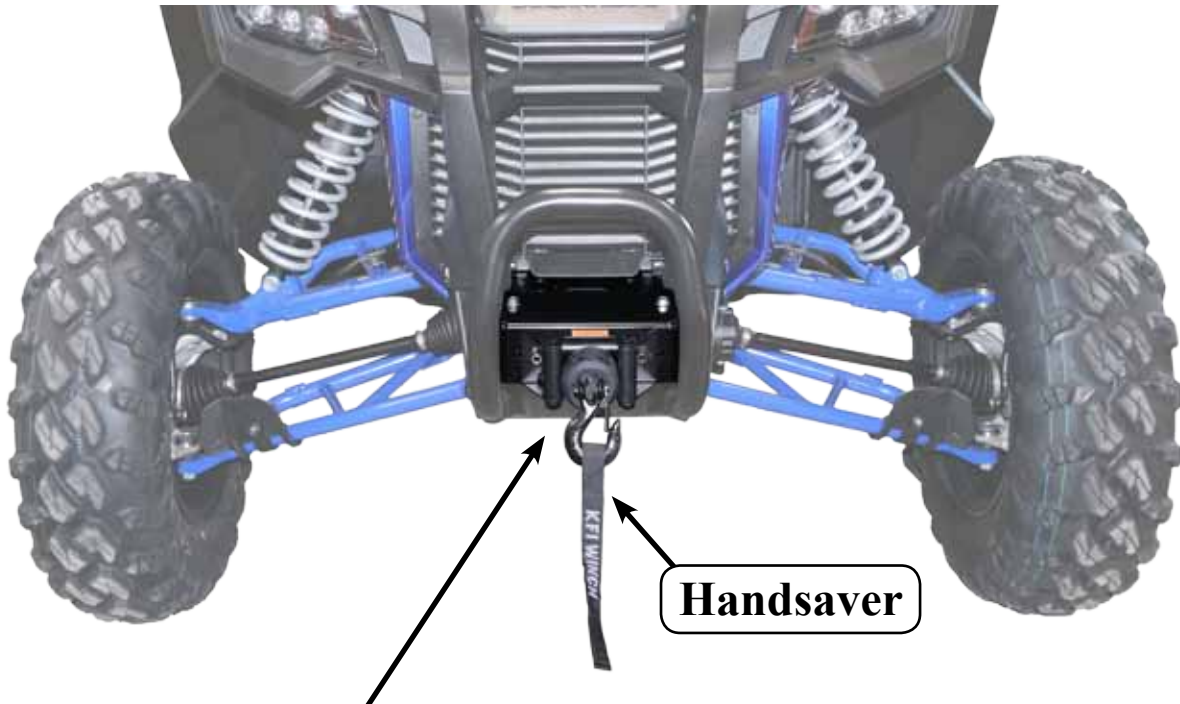

Finish spooling the remaining rope or cable until the hook stopper just touches the fairlead. The rope or cable replacement is now complete!

11. If more support is needed, please call or email KFI technical support. The technical assistant may ask for pictures to help show what the problem is. Pictures or questions can be sent to the email below.

Tech Support #: 1-877-346-2050 OPT. 2
Tech EMAIL: Tech@KFIproducts.com

